

NOTE: EXISTING RIGHT-OF-WAY IS 100 FT EACH SIDE OF THE CENTERLINE OF 75TH STREET THROUGHOUT THE TOTAL LENGTH OF THE PROJECT

PROJECT BEGINS STA. 63+50

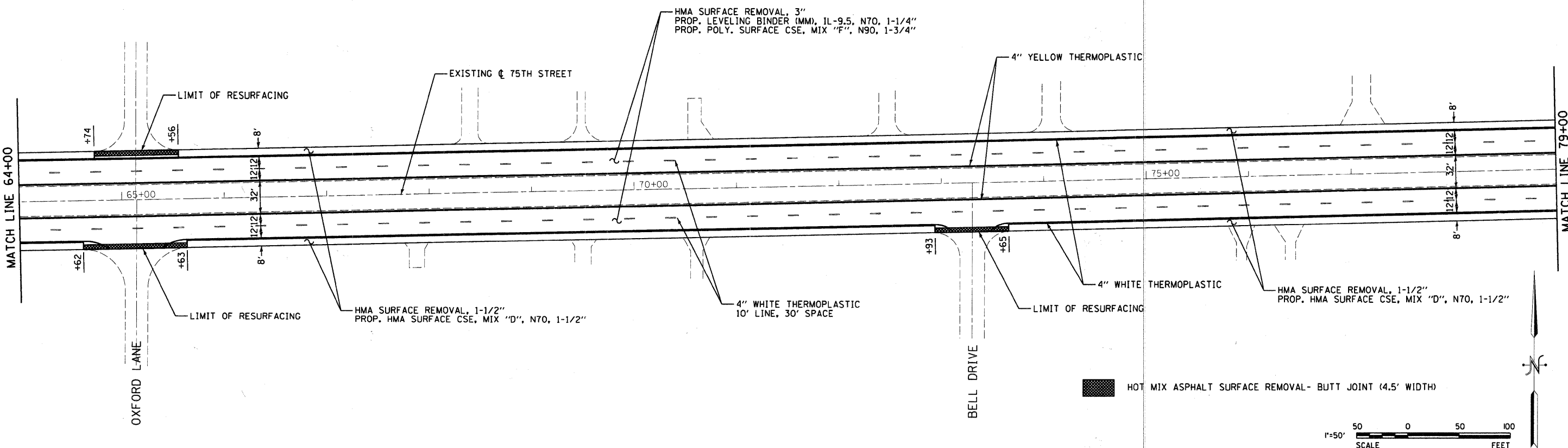
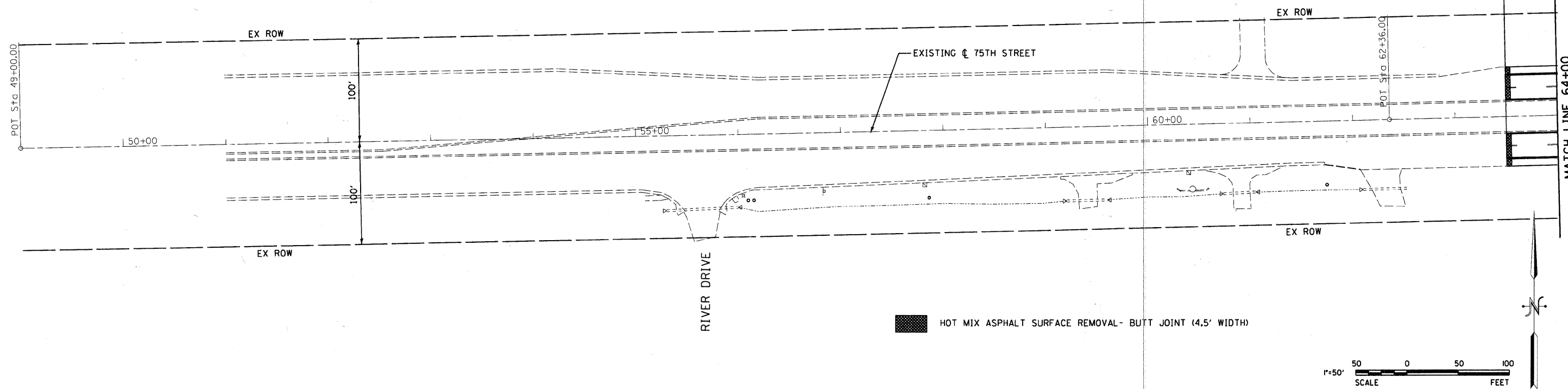

ESI CONSULTANTS, LTD
 1879 N. MILL STREET, SUITE 100
 NAPERVILLE, IL 60563
 (630) 420-1700
 WWW.ESICONSULTANTS.LTD.COM
 ILLINOIS DEPARTMENT OF PROFESSIONAL REGULATION REGISTRATION #184-003685

DESIGNED - MR	REVISED -
DRAWN - DN	REVISED -
CHECKED - MR	REVISED -
DATE -	REVISED -

STATE OF ILLINOIS
 DEPARTMENT OF TRANSPORTATION

75TH STREET
OXFORD LANE TO GREENE ROAD

SCALE: 1"=50' SHEET NO. OF SHEETS STA. 63+50 TO STA. 79+00

F.A.P. RTE.	SECTION	COUNTY	TOTAL SHEETS	SHEET NO.
0369	10-00288-02-RS	DUPAGE	29	6
CONTRACT NO. 63575			ILLINOIS FED. AID PROJECT	