

F.A.U. RTE.	SECTION	COUNTY	TOTAL SHEETS	SHEET NO.
0856	08-00050-00-BR	WILL.	26	1

CONTRACT NO. 63576

INDEX OF SHEETS

SHEET	DESCRIPTION
1	COVER SHEET
2	GENERAL NOTES AND STATE STANDARDS
3	SUMMARY OF QUANTITIES
4	TYPICAL SECTIONS
5	ROADWAY PLAN AND PROFILE
6	MOT TYPICAL SECTIONS
7-24	BRIDGE STRUCTURE PLANS AND DETAILS
25-26	CONSTRUCTION DETAILS

STATE OF ILLINOIS
DEPARTMENT OF TRANSPORTATION
DIVISION OF HIGHWAYS

PLANS FOR PROPOSED
FEDERAL AID HIGHWAY

FAP 0856 (WEBER ROAD) OVER THE E. BRANCH DUPAGE RIVER
SUPERSTRUCTURE REPLACEMENT
SECTION 08-00050-00-BR
PROJECT BRS-0197 (114)
VILLAGE OF BOLINGBROOK
WILL COUNTY
JOB C-91-153-09

PROJECT LOCATED IN
VILLAGE OF BOLINGBROOK

PROPOSED IMPROVEMENT: NEW CONSTRUCTION AND
RECONSTRUCTION OF HOT-MIX ASPHALT ROADWAY
PAVEMENT, BRIDGE AND BRIDGE APPROACH PAVEMENT
CONSTRUCTION, STORM SEWER, LANDSCAPING, AND
EROSION CONTROL.

TRAFFIC DATA
ADT (2009) = 31,300
POSTED SPEED = 45 MPH

DESIGN DESIGNATION
2800 (30) ARTERIAL 11.15 (FD-20)
ADT (2030) ADT = 40,000

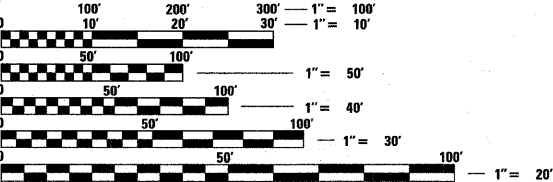

FULL SIZE PLANS HAVE BEEN PREPARED USING STANDARD
ENGINEERING SCALES. REDUCED SIZED PLANS WILL NOT
CONFORM TO STANDARD SCALES. IN MAKING MEASUREMENTS
ON REDUCED PLANS, THE ABOVE SCALES MAY BE USED.

J.U.L.I.E.
JOINT UTILITY LOCATION INFORMATION FOR EXCAVATION
1-800-892-0123 OR 811

CONTRACT NO. 63576

PROJECT LIMIT
STATION 68+03.8
WEBER RD.

PROJECT LIMIT
STATION 70+29.8
WEBER RD.

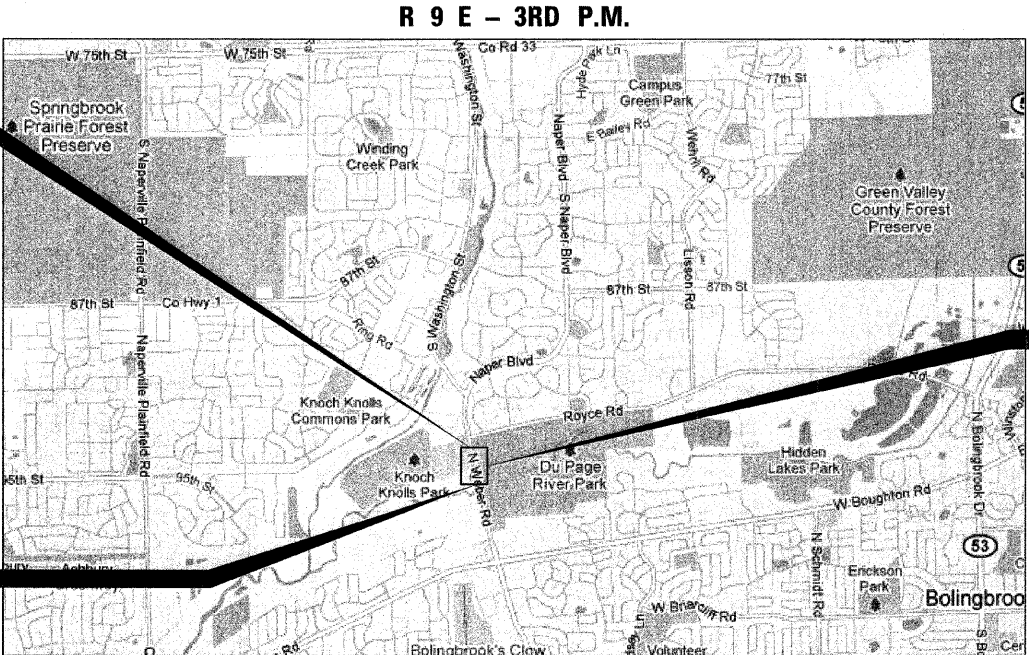

LOCATION MAP
NOT TO SCALE

PROJECT LENGTH
WEBER RD. 226 FT
TOTAL GROSS AND NET PROJECT LENGTH 226 FT (0.043 MILES)

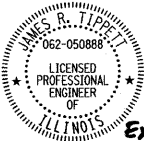

James R. Tippett
JAMES R. TIPPETT, P.E.
LICENSE NO.: 062-050888
EXPIRES: NOVEMBER 30, 2011

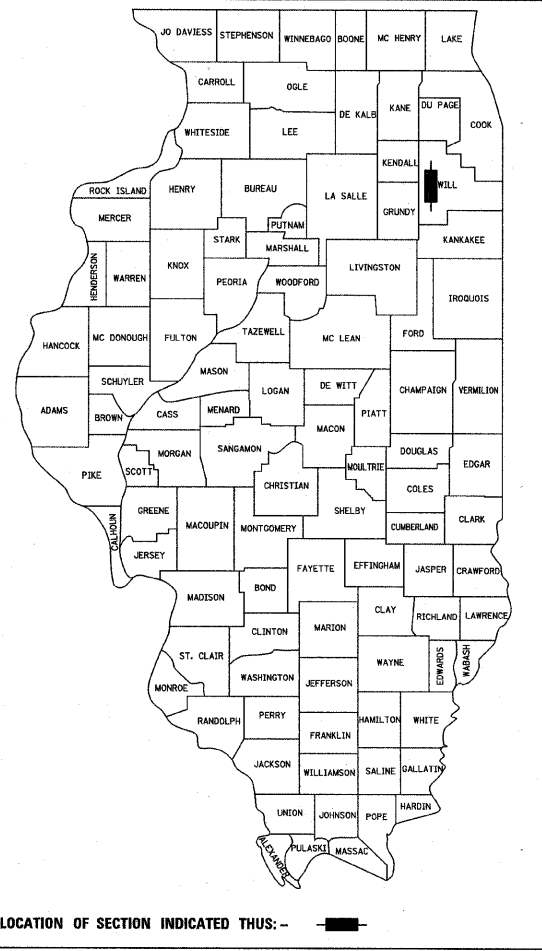

STATE OF ILLINOIS
DEPARTMENT OF TRANSPORTATION
DIVISION OF HIGHWAYS

Approved March 28, 2011
Michael J. Drey
VILLAGE OF BOLINGBROOK

Passed April 11, 2011
Christopher But
DISTRICT 1 ENGINEER OF LOCAL ROADS AND STREETS

Releasing for Bid
Based on Limited
Review April 11, 2011
Diana M. O'Keefe
DEPUTY DIRECTOR OF HIGHWAYS, REGION 1 ENGINEER

PRINTED BY THE AUTHORITY
OF THE STATE OF ILLINOIS

PLANS PREPARED BY:
URS
100 S. WACKER DR., SUITE 500 TEL (312)-939-1000
CHICAGO IL, 60606 FAX (312)-939-4198

PROGRAM AND OFFICE ENGINEER: CHARLES F. RIDDLE, P.E.: 847-708-4406: SCHAUMBURG, IL