

PAVEMENT MARKINGS LEGEND	
ITEM DESCRIPTION	SYMBOL
THERMOPLASTIC PAVEMENT MARKING LINE, 4", SKIP-DASH, YELLOW	(B)
THERMOPLASTIC PAVEMENT MARKING LINE, 6", CROSSWALK, WHITE	(C)
THERMOPLASTIC PAVEMENT MARKING LINE, 24", STOP BAR, WHITE	(D)

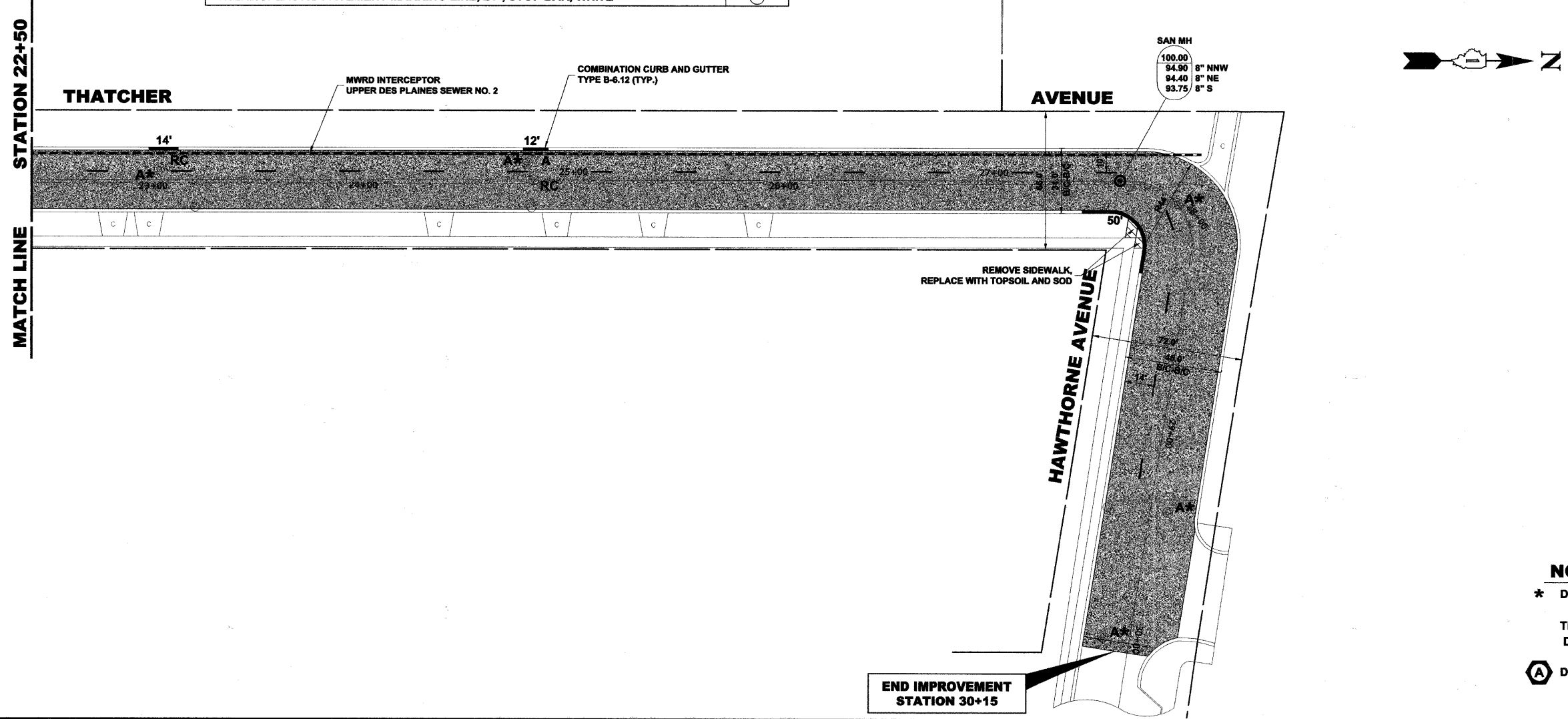

**NOTES:**

- \* DENOTES FRAMES AND LIDS TO BE ADJUSTED (SPECIAL)
- THE LOCATIONS FOR PATCHING "D" WORK TO BE DETERMINED IN FIELD BY THE ENGINEER
- (A) DETECTABLE WARNING

Drawing file: W:\Projects\7401021B - 2010 LAPP Project\Thatcher Ave\Thatcher Ave.dwg Mar 24, 2011 - 3:42pm

**HANCOCK ENGINEERING**  
 Civil Engineers  
 Municipal Consultants  
 Established 1911

9533 Roosevelt Road  
 Westchester, Illinois 60154-2790  
 Phone: 708/965-0300  
 Fax: 708/965-1212

DESIGNED	--	REVISED	--
DRAWN	--	REVISED	--
CHECKED	--	REVISED	--
DATE	01/28/11	REVISED	--

STATE OF ILLINOIS  
 DEPARTMENT OF TRANSPORTATION

PAVING PLAN

SCALE: 1" = 30' SHEET NO. 2 OF 2 SHEETS STA. 15+50 TO STA. 30+15

F.A.U. RTE.	SECTION	COUNTY	TOTAL SHEETS	SHEET NO.
2753	10-00092-00-RS	COOK	12	6
FED. ROAD DIST. NO. 1 ILLINOIS			CONTRACT NO. 63577	
FED. AID PROJECT				