

QUANTITY  
4 (100) LINE = 64.1 ft. (19.7 m)  
21.1 sq. ft. (1.97 sq. m)

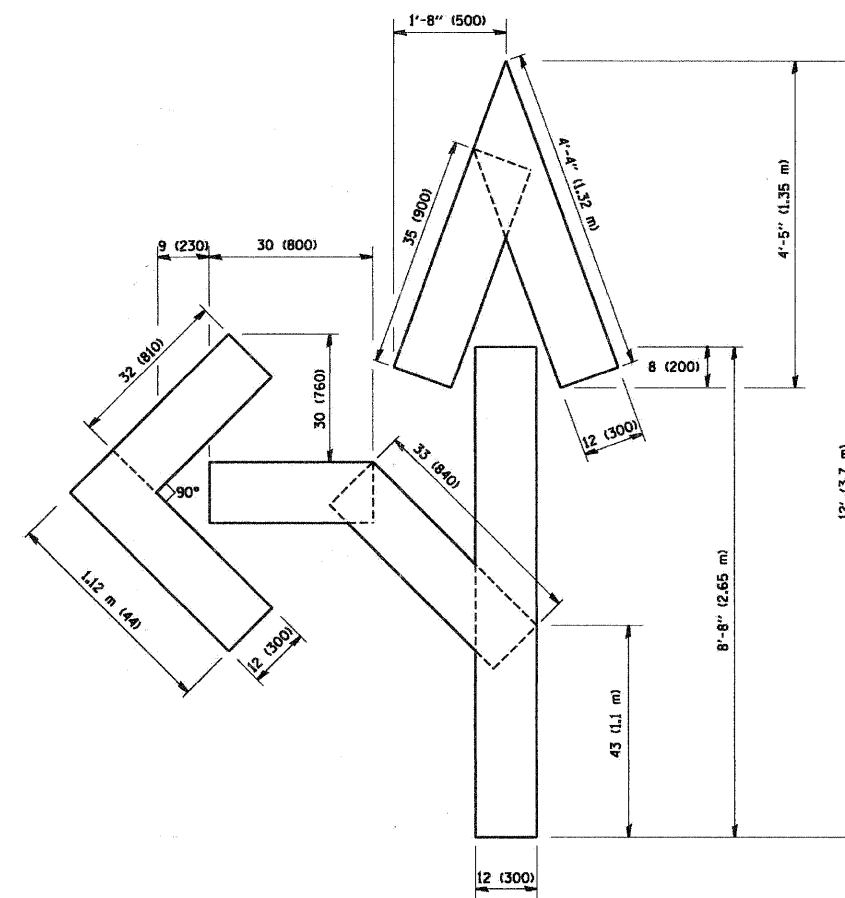

QUANTITY  
4 (100) LINE = 82.5 ft. (25.3 m)  
27.5 sq. ft. (2.53 sq. m)

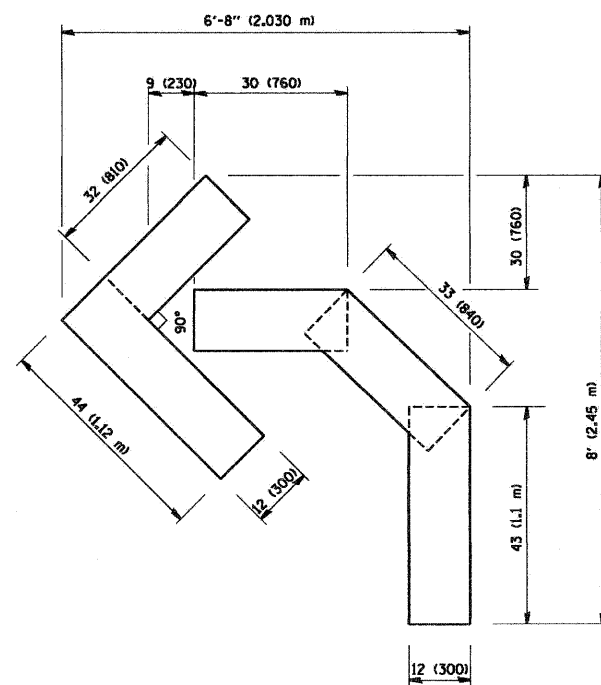

QUANTITY  
4 (100) LINE = 45.5 ft. (13.9 m)  
15.2 sq. ft. (1.39 sq. m)

All dimensions are in inches (millimeters) unless otherwise shown.

FILE NAME = W:\distratd\22x34\tcl15.dgn	USER NAME = geg1enabt	DESIGNED - DRAWN -	REVISOR - REVISOR -
PLOT SCALE = 58.0000 "/ IN.	CHECKED -	REVISOR - REVISOR -	REVISOR - REVISOR -
PLOT DATE = 1/4/2008	DATE = 09-18-94	REVISOR - REVISOR -	REVISOR - REVISOR -

STATE OF ILLINOIS  
DEPARTMENT OF TRANSPORTATION

PAVEMENT MARKING LETTERS AND SYMBOLS  
FOR TRAFFIC STAGING

SCALE: NONE SHEET NO. 1 OF 1 SHEETS STA. TO STA.

F.A.U. RTE. 2659	SECTION 11-00177-00-RS	COUNTY DUPAGE	TOTAL SHEETS 21	SHEET NO. 18
TC-16			CONTRACT NO. 63585	
FED. ROAD DIST. NO. 1 ILLINOIS FED. AID PROJECT				