

CONSTRUCTION NOTES:

- A EXISTING AT&T CONDUIT. CONTRACTOR SHALL COORDINATE WITH AT&T BEFORE CONSTRUCTION.
- B PLACE NEW CONDUIT AS CLOSE TO THE EXISTING R.O.W. AS POSSIBLE.
- C CONTRACTOR SHALL COORDINATE WITH KANE COUNTY DIVISION OF TRANSPORTATION BEFORE CONSTRUCTION.

NOTES:

- ① PROPOSED FIBER OPTIC CABLE IN CONDUIT, SM36F
- ② PROPOSED FIBER OPTIC CABLE IN CONDUIT, SM144F
- ③ PROPOSED ELECTRIC CABLE IN CONDUIT, TRACER, NO. 14 1C
- ④ TERMINATE FIBERS AT DISTRIBUTION ENCLOSURE IN CABINET
- ⑤ SPLICE FIBERS DISTRIBUTION ENCLOSURE IN CABINET
- ⑥ COIL FIBER OPTIC CABLE SLACK AND TRACER IN HANDHOLE

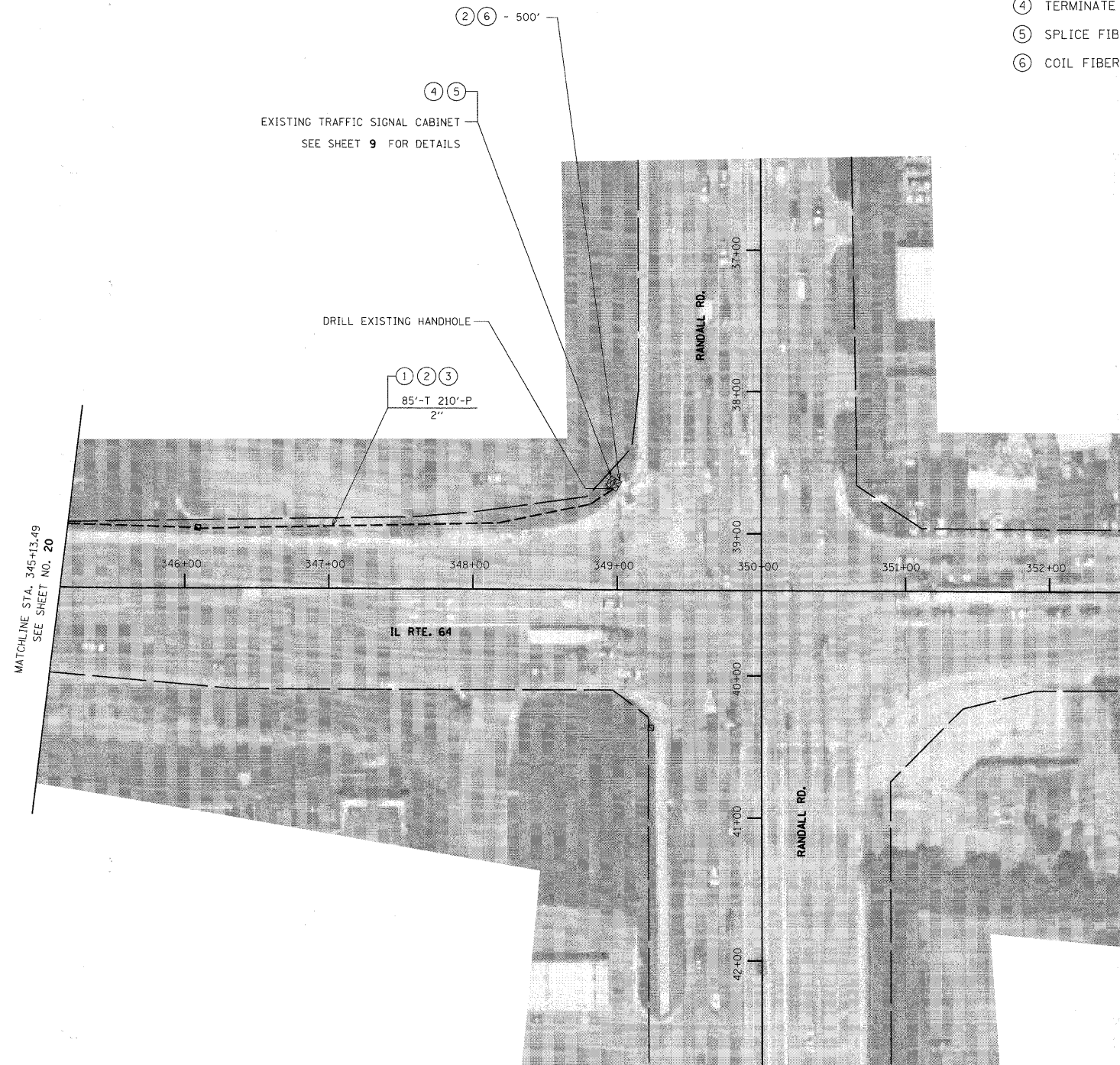
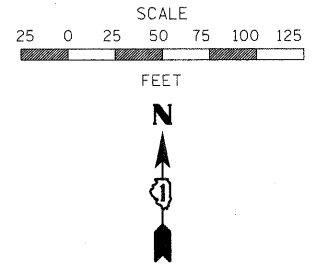

FILE NAME =	USER NAME = #USER#	DESIGNED - DC	REVISED -	STATE OF ILLINOIS DEPARTMENT OF TRANSPORTATION	IL 64 BURLINGTON ROAD TO RANDALL ROAD	F.A.P. RTE.	SECTION	COUNTY	TOTAL SHEETS	SHEET NO.	
#FILEL#	PLOT SCALE = #SCALE#	DRAWN - JM	REVISED -			VARIES	08-00389-00-TL	KANE	28	21	
	PLOT DATE = #DATE#	CHECKED - DB	REVISED -			CONTRACT NO. 63594		ILLINOIS FED. AID PROJECT			
		DATE - 04/11/2011	REVISED -			SCALE: 1" = 50'	SHEET NO. 7 OF 7 SHEETS	STA. 345+13.49 TO STA. 352+00			