

**DEAD LOAD DEFLECTION DIAGRAM**  
(Includes weight of concrete, excluding beams).

Note:  
The above deflections are not to be used in the field if the engineer is working from the grade elevations adjusted for dead load deflections as shown below.

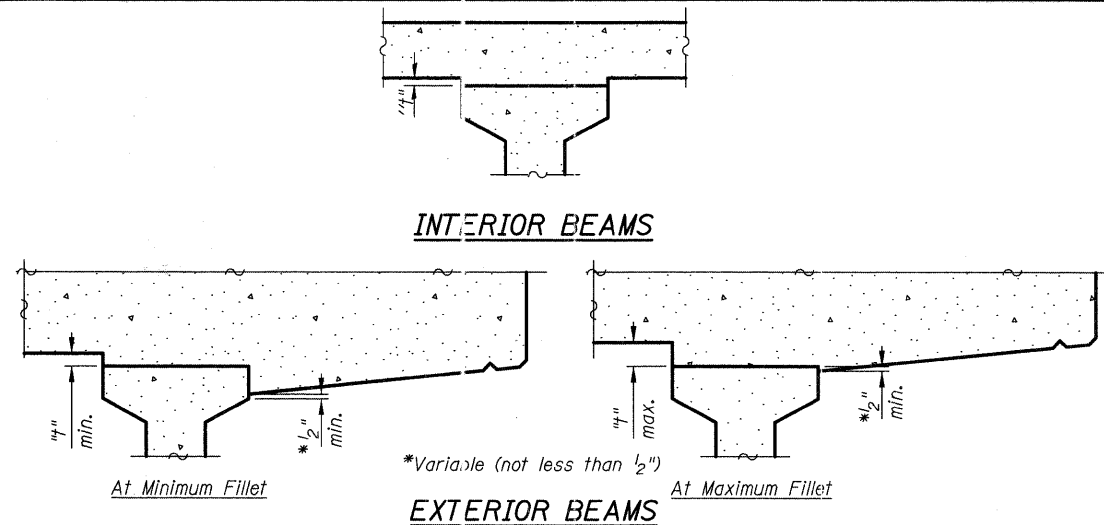

**METHOD OF DETERMINING FILLET HEIGHTS "f"**

After all beams have been erected, elevations of the top flanges of the beams shall be taken at the intervals shown on the plans. These elevations subtracted from the "Theoretical Grade Elevations Adjusted for Dead Load Deflection" shown on the plans, minus slab thickness equals the fillet heights "f" above top flange of beams.

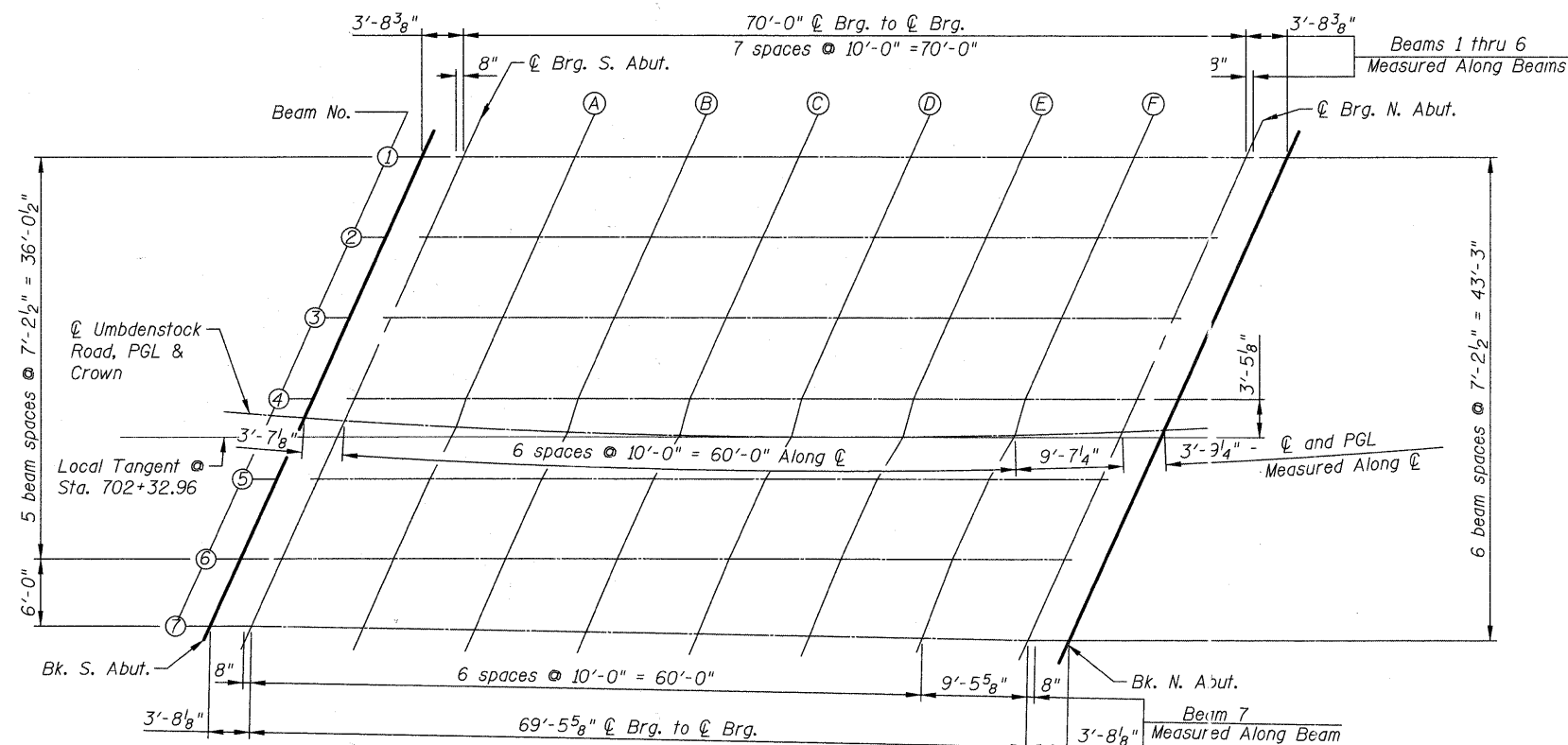

**PLAN**

**BEAM 1**

Location	Station	Offset	Theoretical Grade Elevations	Theoretical Grade Elevations Adjusted For Dead Load Deflection
Bk. S. Abut.	701+94.55	-23.98	818.69	818.69
☉ Brg. S. Abut.	701+98.38	-24.19	818.66	818.66
A	702+08.75	-24.63	818.56	818.60
B	702+19.14	-24.92	818.47	818.54
C	702+29.53	-25.05	818.39	818.47
D	702+39.92	-25.02	818.30	818.38
E	702+50.32	-24.84	818.22	818.28
F	702+60.70	-24.50	818.14	818.17
☉ Brg. N. Abut.	702+71.06	-24.00	818.06	818.06
Bk. N. Abut.	702+74.90	-23.77	818.03	818.03

**BEAM 2**

Location	Station	Offset	Theoretical Grade Elevations	Theoretical Grade Elevations Adjusted For Dead Load Deflection
Bk. S. Abut.	701+91.65	-16.59	818.83	818.83
☉ Brg. S. Abut.	701+95.44	-16.81	818.79	818.79
A	702+05.69	-17.30	818.70	818.74
B	702+15.96	-17.64	818.61	818.68
C	702+26.23	-17.81	818.53	818.61
D	702+36.51	-17.84	818.44	818.52
E	702+46.76	-17.71	818.36	818.42
F	702+57.06	-17.42	818.28	818.32
☉ Brg. N. Abut.	702+67.31	-16.98	818.20	818.20
Bk. N. Abut.	702+71.11	-16.78	818.17	818.17

**BEAM 3**

Location	Station	Offset	Theoretical Grade Elevations	Theoretical Grade Elevations Adjusted For Dead Load Deflection
Bk. S. Abut.	701+88.82	-9.19	818.97	818.97
☉ Brg. S. Abut.	701+92.57	-9.42	818.93	818.93
A	702+02.70	-9.96	818.84	818.88
B	702+12.85	-10.34	818.75	818.82
C	702+23.01	-10.57	818.67	818.74
D	702+33.17	-10.64	818.58	818.66
E	702+43.34	-10.56	818.50	818.56
F	702+53.49	-10.33	818.42	818.46
☉ Brg. N. Abut.	702+63.64	-9.94	818.34	818.34
Bk. N. Abut.	702+67.40	-9.76	818.31	818.31

STATE OF ILLINOIS  
DEPARTMENT OF TRANSPORTATION

TOP OF SLAB ELEVATIONS I  
UMBENSTOCK ROAD OVER CC&P RR  
STRUCTURE NO. 045-3162

F.A.P. RTE. 361	SECTION 06-00214-27-BR	COUNTY KANE	TOTAL SHEETS 87	SHEET NO. 36
FED. ROAD DISTRICT 1 ILLINOIS			FED. AID PROJECT	
CONTRACT NO. 63595				

SHEET NO. 53 OF 528 SHEETS

4/16/27 PM 4:16:27 PM J:\2372\cad\struct\03\_Top of Slab Elev Ldgn



450 E Devon Ave, Suite 300  
Itasca, Illinois 60143  
Tel: 630.773.3900 Fax: 630.773.3975  
www.civiltechinc.com

DESIGNED - D. Atkins	REVISED -
DRAWN - D. Atkins	REVISED -
CHECKED - G. Hatlestad	REVISED -
DATE - March 25, 2011	REVISED -