

EAST EDGE OF SHOULDER

Location	Station	Offset	Theoretical Grade Elevations
S. End S. Appr. Pav't	701+49.80	20.00	819.12
A	701+59.51	20.00	819.04
B	701+69.22	20.00	818.96
N. End S. Appr. Pav't	701+78.82	20.00	818.88
S. End N. Appr. Pav't	702+52.08	20.00	818.28
C	702+61.79	20.00	818.20
D	702+71.49	20.00	818.12
N. End N. Appr. Pav't	702+80.96	20.00	818.04

EAST EDGE OF PAVEMENT

Location	Station	Offset	Theoretical Grade Elevations
S. End S. Appr. Pav't	701+50.40	18.00	819.15
A	701+60.13	18.00	819.07
B	701+69.87	18.00	818.99
N. End S. Appr. Pav't	701+79.52	18.00	818.91
S. End N. Appr. Pav't	702+53.03	18.00	818.30
C	702+62.76	18.00	818.22
D	702+72.50	18.00	818.14
N. End N. Appr. Pav't	702+82.02	18.00	818.07

UMBENSTOCK RD., PGL & CROWN

Location	Station	Offset	Theoretical Grade Elevations
S. End S. Appr. Pav't	701+55.94	0.00	819.38
A	701+65.94	0.00	819.30
B	701+75.94	0.00	819.22
N. End S. Appr. Pav't	701+85.94	0.00	819.14
S. End N. Appr. Pav't	702+61.83	0.00	818.51
C	702+71.83	0.00	818.43
D	702+81.83	0.00	818.35
N. End N. Appr. Pav't	702+91.83	0.00	818.27

WEST EDGE OF PAVEMENT

Location	Station	Offset	Theoretical Grade Elevations
S. End S. Appr. Pav't	701+61.80	-18.00	819.05
A	701+72.08	-18.00	818.97
B	701+82.36	-18.00	818.88
N. End S. Appr. Pav't	701+92.75	-18.00	818.80
S. End N. Appr. Pav't	702+71.24	-18.10	818.15
C	702+81.52	-18.00	818.07
D	702+91.80	-18.00	817.99
N. End N. Appr. Pav't	703+02.27	-18.00	817.90

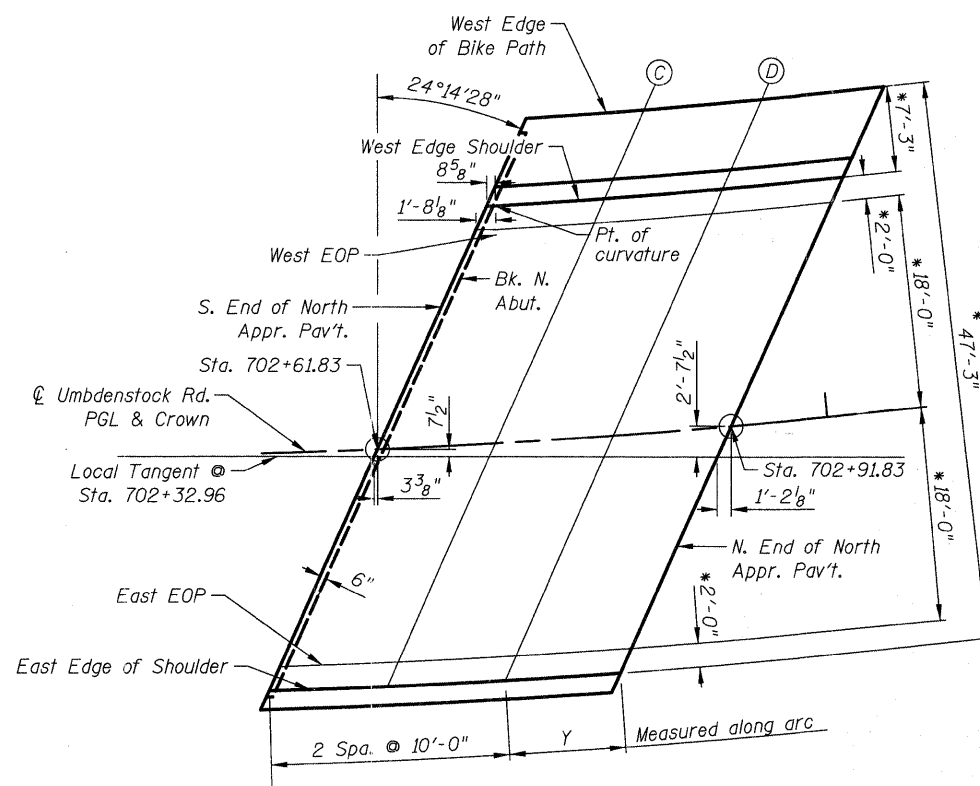
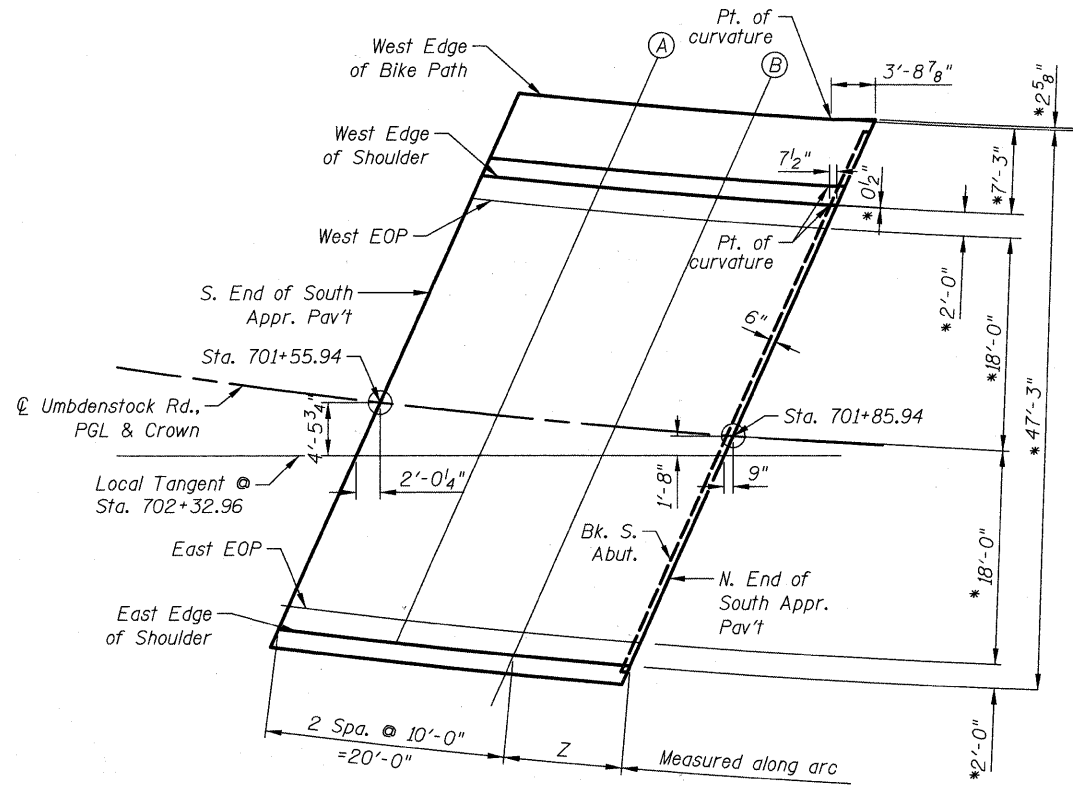

PLAN

* - indicates dimensions are radial

WEST EDGE OF SHOULDER

Location	Station	Offset	Theoretical Grade Elevations
S. End S. Appr. Pav't	701+62.48	-20.00	819.02
A	701+72.79	-20.00	818.93
B	701+83.10	-20.00	818.85
N. End S. Appr. Pav't	701+93.53	-20.04	818.76
S. End N. Appr. Pav't	702+72.29	-20.05	818.11
C	702+82.60	-20.00	818.03
D	702+92.91	-20.00	817.95
N. End N. Appr. Pav't	703+03.48	-20.00	817.86

WEST EDGE OF BIKE PATH

Location	Station	Offset	Theoretical Grade Elevations
S. End S. Appr. Pav't	701+64.96	-27.25	818.88
A	701+75.39	-27.25	818.80
B	701+85.82	-27.25	818.71
N. End S. Appr. Pav't	701+96.49	-27.47	818.62
S. End N. Appr. Pav't	702+76.23	-27.25	817.97
C	702+86.66	-27.25	817.88
D	702+97.09	-27.25	817.80
N. End N. Appr. Pav't	703+07.92	-27.25	817.71

LENGTH ALONG ARC, "Z" & "Y"

Location	Arc Length "Z"	Arc Length "Y"
West Edge of Bike Path	10'-3" **	10'-4 1/2"
West Edge of Shoulder	10'-1 1/2" **	10'-3"
West Edge of Pavement	10'-1 1/4"	10'-2 3/8"
Umbdenstock Rd., Profile Grade	10'-0"	10'-0"
East Edge of Pavement	9'-10 7/8"	9'-9 3/8"
East Edge of Shoulder	9'-10 3/4"	9'-9 1/8"

** Indicates total length of tangent and arc

**STATE OF ILLINOIS
DEPARTMENT OF TRANSPORTATION**

**TOP OF APPROACH SLAB ELEVATIONS
UMBENSTOCK ROAD OVER CC&P RR
STRUCTURE NO. 045-3162**

F.A.P. RTE.	SECTION	COUNTY	TOTAL SHEETS	SHEET NO.
361	06-00214-27-BR	KANE	87	38

CONTRACT NO. 63595

SHEET NO. S5 OF S28 SHEETS

FED. ROAD DISTRICT 1 ILLINOIS FED. AID PROJECT

4/16/2011 4:16:29 PM J:\2372\road\struct\05_Top of Appr Slab Elev.dgn