

DATE	
BY	
SURVEYED	
PLOTTED	
NOTE BOOK	
AREAS CHECKED	

DATE	
BY	
SURVEYED	
PLOTTED	
NOTE BOOK	
AREAS CHECKED	

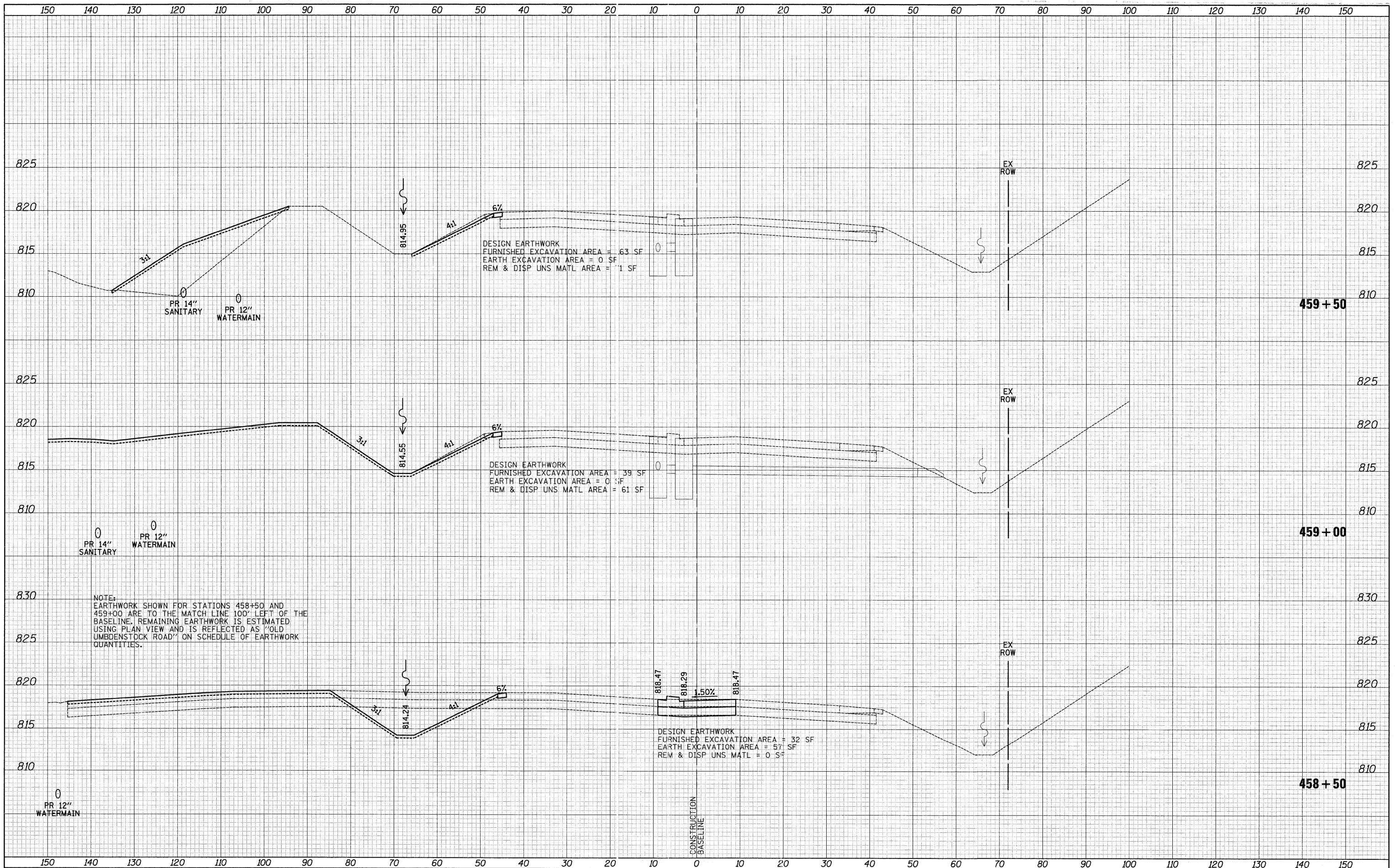

NOTE:  
EARTHWORK SHOWN FOR STATIONS 458+50 AND 459+00 ARE TO THE MATCH LINE 100' LEFT OF THE BASELINE. REMAINING EARTHWORK IS ESTIMATED USING PLAN VIEW AND IS REFLECTED AS "OLD UMBDENSTOCK ROAD" ON SCHEDULE OF EARTHWORK QUANTITIES.

**CIVILTECH**  
480 E Devon Ave, Suite 300  
Itasca, Illinois 60143  
Tel: 630.773.3900 Fax: 630.773.3975  
www.civiltechinc.com

DESIGNED - PK	REVISED -
DRAWN - PK	REVISED -
CHECKED - RTM	REVISED -
DATE - 3/25/2011	REVISED -

**STATE OF ILLINOIS  
DEPARTMENT OF TRANSPORTATION**

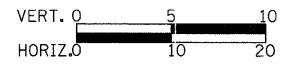

**CROSS SECTIONS - STEARNS ROAD**

SHEET NO. 5 OF 8 SHEETS STA. 458+50 TO STA. 459+50

F.A.P. RTE. 361	SECTION 06-00214-27-BR	COUNTY KANE	TOTAL SHEETS 87	SHEET NO. 78
CONTRACT NO. 63595			FED. ROAD DIST. NO. 1 ILLINOIS FED. AID PROJECT	