

- LEGEND:**
- PAVEMENT REMOVAL
  - DRIVEWAY PAVEMENT REMOVAL
  - SHOULDER REMOVAL
  - TREE REMOVAL, ACRES
  - BUILDING REMOVAL
  - GUTTER REMOVAL
  - 12" TREE REMOVAL (UNIT DIAMETER)
  - CHAINLINK FENCE REMOVAL
- EXISTING UTILITIES LEGEND**
- UNDERGROUND TELEPHONE LINE
  - UNDERGROUND FIBER OPTIC LINE
  - UNDERGROUND GAS LINE
  - AERIAL LINE

**EXISTING PLAN AND REMOVAL NOTES**

ADDITIONAL REMOVALS SHOWN IN THE DRAINAGE PLANS, SIGNAL PLANS.

ALL FENCE MATERIAL OTHER THAN CHAIN LINK WILL BE INCLUDED IN CLEARING.

BITUMINOUS DRIVEWAYS ON AGGREGATE BASE COURSE REMOVAL WILL BE INCLUDED IN EARTH EXCAVATION.

ANY HOT-MIX ASPHALT PAVEMENT REMOVAL WHICH IS LESS THAN 6" IN THICKNESS WILL BE PART OF EARTH EXCAVATION.

MAILBOX LOCATIONS WILL BE UPDATED BASED ON DISTRICT 2 STANDARDS (SEE GENERAL NOTES).

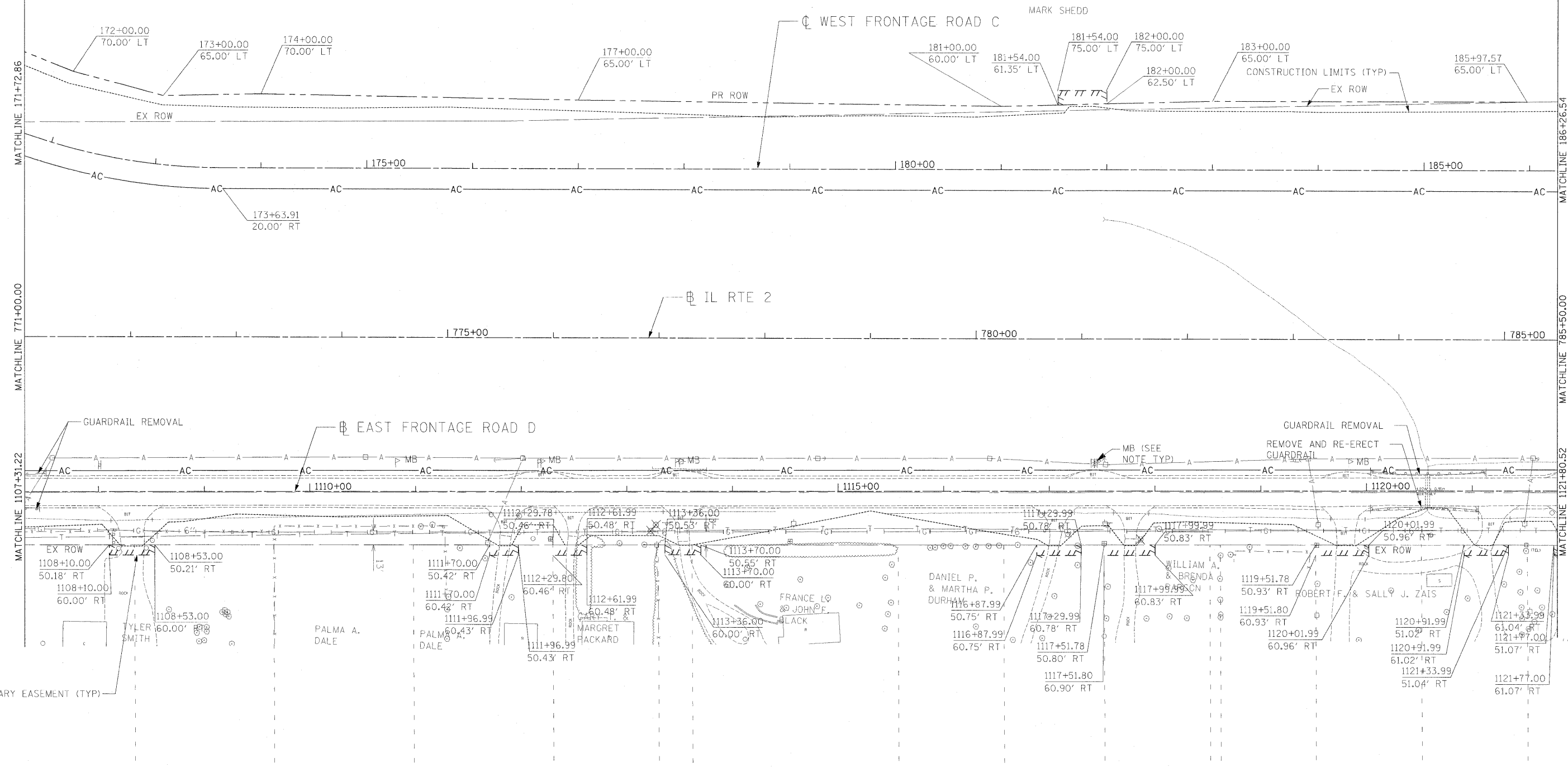

USER NAME = zuikowad	DESIGNED STS/GC	REVISED -	<b>STATE OF ILLINOIS DEPARTMENT OF TRANSPORTATION</b>		ILLINOIS ROUTE 2 EXISTING PLAN AND REMOVALS 7 STA 771+00 TO 785+50		F.A.P. RTE.	SECTION	COUNTY	TOTAL SHEETS	SHEET NO.
PLOT SCALE = 50.0000 FT / IN.	DRAWN RDT	REVISED -					734	77-2-2 & 77-2B-1	WINNEBAGO	530	58
PLOT DATE = 2/2/2011	CHECKED GC	REVISED -					CONTRACT NO. 64813				
DATE 01-14-11	REVISIONS	REVISED -					ILLINOIS FED. AID PROJECT				