

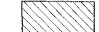

KEY

- 1 HOT-MIX ASPHALT PAVEMENT (FULL-DEPTH), 12.5'
SEE NOTE #3
- 2 2" HOT-MIX ASPHALT SURFACE COURSE, MIX "D", N70
- 3 10.5" HOT-MIX ASPHALT BINDER COURSE, IL-19.0, N70
- 4 HOT-MIX ASPHALT SURFACE COURSE, MIX "C", N50
- 5 HOT-MIX ASPHALT SHOULDERS
- 6 SUB-BASE GRANULAR MATERIAL, TYPE A
- 7 AGGREGATE SHOULDERS, TYPE A
- 8 INCIDENTAL HOT-MIX ASPHALT SURFACING
(2" AT DRIVEWAYS)
- 9 COMBINATION CONCRETE CURB & GUTTER, TYPE M-4.24
- 10 COMBINATION CONCRETE CURB & GUTTER, TYPE M-4.06
- 11 CONCRETE MEDIAN SURFACE, 4" OR CONCRETE MEDIAN, TYPE SM-4.24
- 12 TOPSOIL FURNISH AND PLACE, 6" OR 12"
- 13 AGGREGATE BASE COURSE, TYPE B
- 14 PIPE UNDERDRAIN, 4"
- 15 AGGREGATE BASE COURSE, TYPE A (SEE SCHEDULES FOR VARIABLE THICKNESS AREAS)

LEGEND

-  HOT-MIX ASPHALT DRIVEWAY
-  AGGREGATE DRIVEWAY (AGGREGATE BASE COURSE, TYPE B, 8")
-  HOT-MIX ASPHALT SURFACE COURSE OVER EX. PAVEMENT
- * CONCRETE MEDIAN SURFACE, 4 INCH
- ** CONCRETE MEDIAN, TYPE SM-4.24

NOTES

1. DRIVEWAYS ARE AT 90° ANGLE TO C ROADWAY UNLESS OTHERWISE SHOWN.
2. ALL DIMENSIONS SHOWN EOP-TO-EOP UNLESS OTHERWISE NOTED.
3. PROPOSED HOT-MIX ASPHALT SHOULDERS IN AREA OF RETURNS AND ADJACENT TO RIGHT-TURN LANE TO BE 4.0' IN WIDTH.
4. LAYOUT OF ALL DRIVEWAYS AND MAILBOX RETURNS, AS WELL AS MAILBOX TURNOUTS SHALL COMPLY WITH ILLINOIS DISTRICT 2 STANDARD 20.1
5. REFER TO PROPOSED ALIGNMENT SHEETS 1 THRU 5 FOR ALL ALIGNMENT INFORMATION.
6. SEE DRAINAGE DETAIL SHEETS AND CULVERT PLANS FOR RELATED DRAINAGE ITEMS.
7. CORNER ISLANDS TO BE CONSTRUCTED IN ACCORDANCE WITH HIGHWAY STD. 606301 (PC CORNER ISLANDS & MEDIANS)
8. SEE TYPICAL SECTIONS FOR WOVEN WIRE FENCE LOCATIONS ALONG ACCESS CONTROL (AC).
9. EAST FRONTAGE RD. BASELINE (B) DOES NOT REFLECT THE EXISTING CROWNLINE OF THE ROAD. IT PROVIDES A BASELINE FOR REFERENCE PURPOSES ONLY.

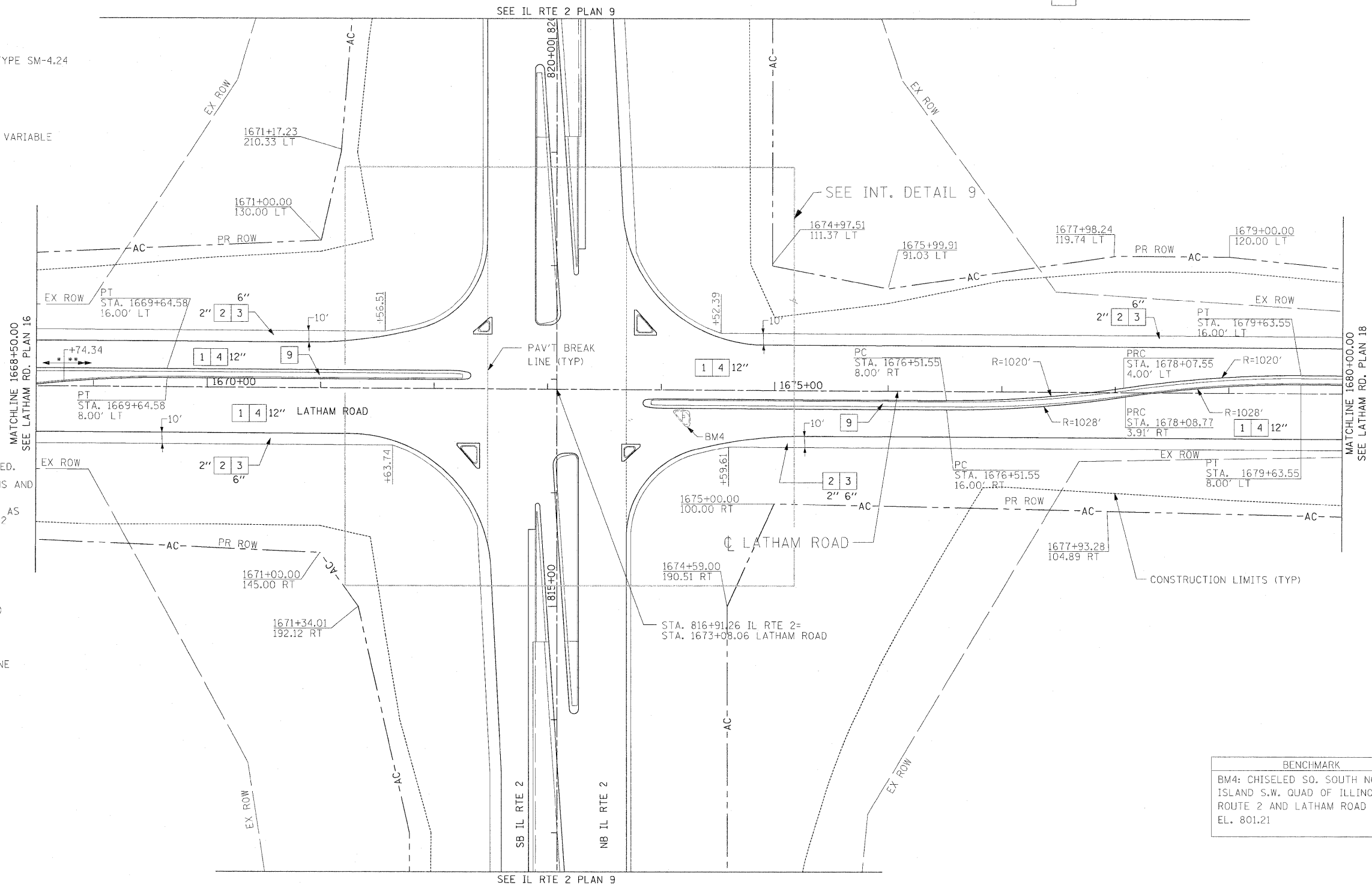
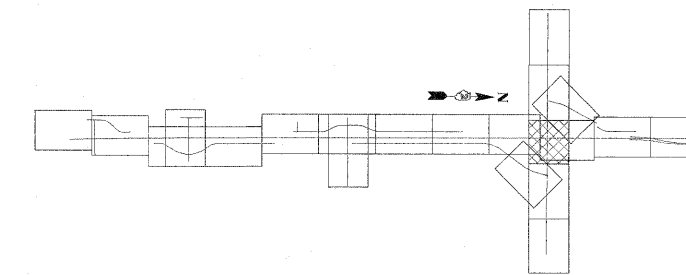

BENCHMARK
 BM4: CHISELED SO. SOUTH NOSE OF ISLAND S.W. QUAD OF ILLINOIS ROUTE 2 AND LATHAM ROAD
 EL. 801.21

R:\projects\11251\segment_1\sheet\civil\plan_sheets\0264813\sh-17.dgn

USER NAME = zulkowsd	DESIGNED STS/GC	REVISED -	STATE OF ILLINOIS DEPARTMENT OF TRANSPORTATION	ILLINOIS ROUTE 2 PLAN 17		F.A.P. RTE.	SECTION	COUNTY	TOTAL SHEETS	SHEET NO.	
PLOT SCALE = 50.0000 FT / IN.	DRAWN RDT	REVISED -		LATHAM RD STA 1668+50 TO STA 1680+00		734	77-2-2 & 77-2B-1	WINNEBAGO	530	89	
PLOT DATE = 2/2/2011	CHECKED GC	REVISED -		SCALE: 1"=50'	SHEET NO. 89 OF 530 SHEETS	STA.	TO STA.	CONTRACT NO. 64813			
	DATE 01-14-11	REVISED -		FED. ROAD DIST. NO. ILLINOIS FED. AID PROJECT							