

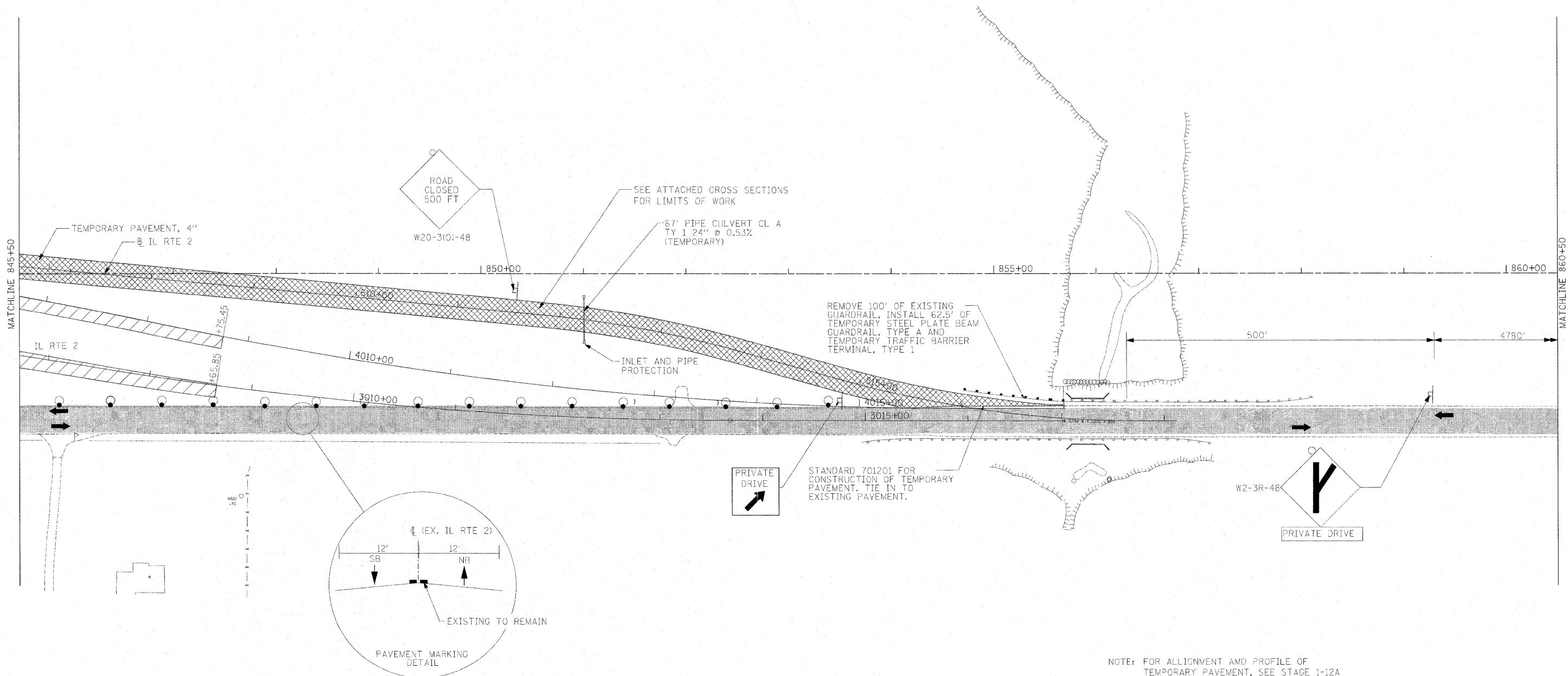

LEGEND

- EXISTING OR NEWLY CONSTRUCTED PAVEMENT USED FOR TRAFFIC
- CONSTRUCTION ZONE DURING STAGE
- DIRECTION OF TRAVEL
- TEMPORARY PAVEMENT (SEE TYPICAL SECTION FOR WIDENING)
- BARRICADE, TYPE III
- DRUM WITH STEADY BURNING LIGHT
- ARROW BOARD



NOTE: FOR ALIGNMENT AND PROFILE OF TEMPORARY PAVEMENT, SEE STAGE 1-12A

W:\p\sect\11226\segment 1\sheet\trf\Traffic Control\0264813-htr-3-stage1-12.dwg

USER NAME = zulkowsd	DESIGNED STS/RDT	REVISED -
	DRAWN RDT	REVISED -
PLOT SCALE = 5/8" = 100' FT / IN.	CHECKED GC	REVISED -
PLOT DATE = 2/2/2011	DATE 01-14-11	REVISED -

**STATE OF ILLINOIS
DEPARTMENT OF TRANSPORTATION**

**ILLINOIS ROUTE 2
SUGGESTED STAGES OF CONSTRUCTION
AND TRAFFIC CONTROL STAGE 1 - 12**

SCALE: 1"=50' SHEET NO. 125 OF 530 SHEETS STA. 845+50 TO STA. 860+50

F.A.P. RTE. 734	SECTION 77-2-2 & 77-2B-1	COUNTY WINNEBAGO	TOTAL SHEETS 530	SHEET NO. 125
FED. ROAD DIST. NO.		ILLINOIS FED. AID PROJECT		
CONTRACT NO. 64813				