

**NOTES:**  
 THE CONTRACTOR SHALL APPLY EROSION CONTROL MEASURES PRIOR TO ANY EARTH DISTURBING ACTIVITIES.  
 EROSION CONTROL FEATURES SHALL REMAIN IN PLACE AND BE MAINTAINED FOR THE DURATION OF THE CONSTRUCTION PERIOD OR AS DIRECTED BY THE ENGINEER.  
 POSITIVE DRAINAGE SHALL BE MAINTAINED DURING ALL STAGES OF CONSTRUCTION.  
 PERIMETER EROSION BARRIER SHALL BE PLACED AT LOCATIONS SHOWN ON THE PLANS OR AS DIRECTED BY THE ENGINEER WHERE THE SLOPE IS SUCH THAT SOIL WILL WASH AWAY FROM THE PROJECT LIMITS.  
 TEMPORARY DITCH CHECKS SHALL BE PLACED IN ALL EXISTING AND PROPOSED DITCHES, AT EVERY 1ft DROP IN ELEVATION.  
 ALL EXISTING INLETS AND PIPES WITHIN LIMITS OF CONSTRUCTION OR WHICH WILL RECEIVE RUNOFF FROM DISTURBED AREAS WILL BE PROTECTED AS SHOWN ON THE PLANS AND AS DIRECTED BY THE ENGINEER.  
 INLET AND PIPE PROTECTIONS SHALL STAY IN PLACE UNTIL SURFACES THAT DRAIN TO THEM ARE PAVED OR REVEGETATED.  
 EXCAVATED AREAS AND EMBANKMENT SHALL BE PERMANENTLY SEEDED IMMEDIATELY AFTER FINAL GRADING. IF NOT, THEY SHALL BE TEMPORARILY SEEDED IF NO CONSTRUCTION ACTIVITY IN THE AREA IS PLANNED FOR 7 DAYS.

**EROSION CONTROL LEGEND**

- STONE RIPRAP (CLASS & DIMENSIONS SHOWN ON PLAN)
- SEEDING, CLASS 1 (AREAS BEING MOWED)
- SEEDING, CLASS 4A AND CLASS 5 (SPECIAL)
- SEEDING, CLASS 2A (8' WIDE STRIP OUTSIDE EDGE OF SHOULDER)
- EXISTING TREE TO REMAIN
- TEMPORARY DITCH CHECK
- INLET & PIPE PROTECTION
- EARTH MEDIAN DITCH CHECK
- PERIMETER EROSION BARRIER
- AGGREGATE MEDIAN DITCH CHECK

DISREGARD SEEDING CLASSES SHOWN ON EROSION CONTROL PLAN 2 THRU 21.  
 USE THE FOLLOWING SEEDING CLASSES:  
 - CLASS 1 (AREAS BEING MOWED)  
 - CLASS 2A (8' WIDE STRIP OUTSIDE THE EDGE OF SHOULDER)  
 - CLASS 4A AND CLASS 5 (ALL OTHER AREAS DISTURBED BY CONSTRUCTION)  
 ESTIMATED QUANTITIES FOR SEEDING CLASS 2A = 20 ACRES,  
 SEEDING CLASS 4A AND SEEDING CLASS 5 (SPECIAL) = 75 ACRES EACH.

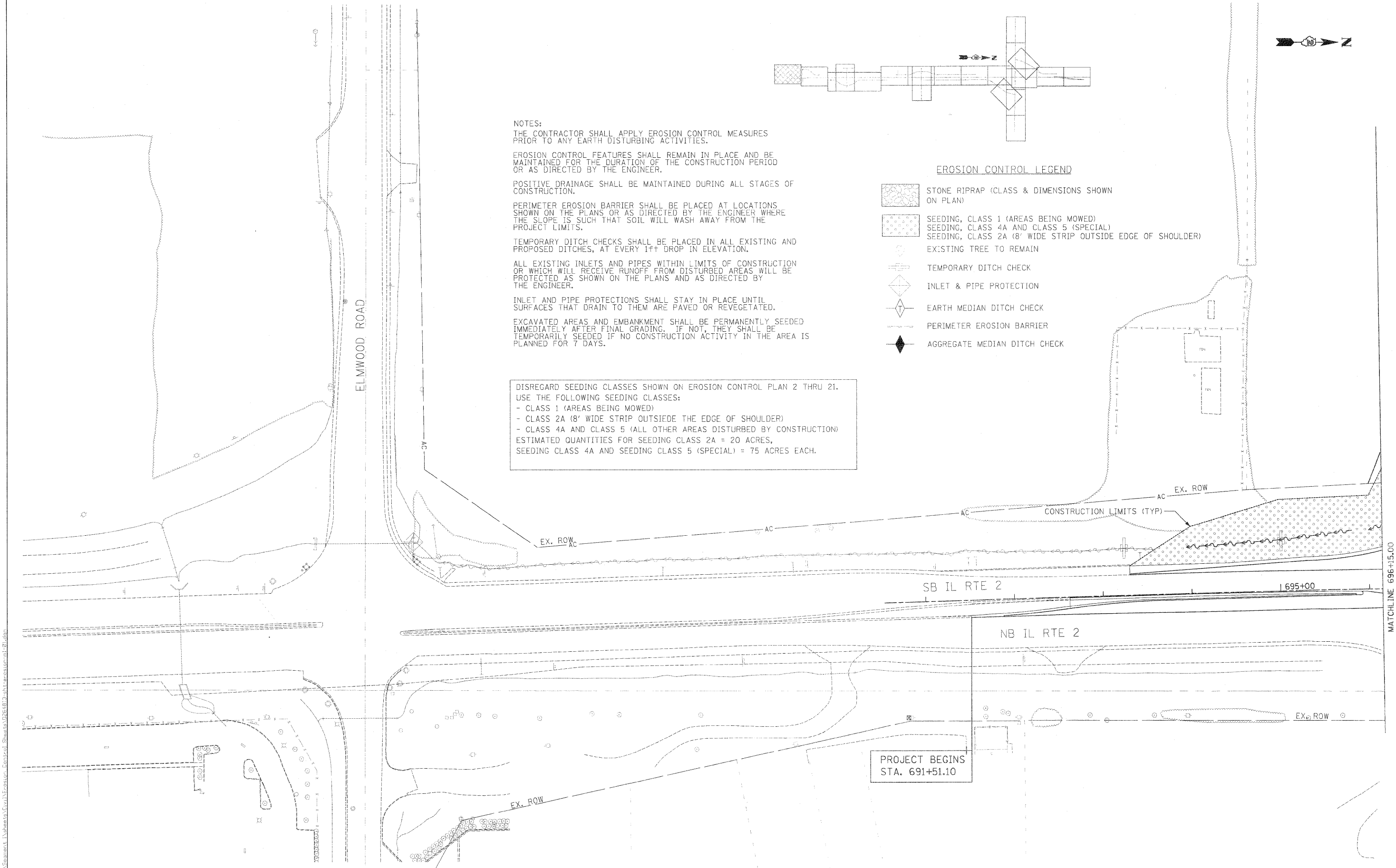

MATCHLINE 696+15.00

I:\projects\11212\11212A\Statement\Utilities\Civil\Erosion\_Control\_Sheets\0261819.dwg

|                                                                                     |  |  |                                                  |  |  |                                                                 |  |  |                                                                                                                                   |  |  |                                                                                             |  |
|-------------------------------------------------------------------------------------|--|--|--------------------------------------------------|--|--|-----------------------------------------------------------------|--|--|-----------------------------------------------------------------------------------------------------------------------------------|--|--|---------------------------------------------------------------------------------------------|--|
| USER NAME = thompson<br>DESIGNED STS/GC<br>DRAWN RDT<br>CHECKED GC<br>DATE 01-14-11 |  |  | REVISIONS<br>REVISIONS<br>REVISIONS<br>REVISIONS |  |  | <b>STATE OF ILLINOIS</b><br><b>DEPARTMENT OF TRANSPORTATION</b> |  |  | ILLINOIS ROUTE 2<br>EROSION CONTROL PLAN 1<br>ELMWOOD RD. TO STA 696+15<br>SCALE: 1"=50' SHEET NO. 169 OF 530 SHEETS STA. TO STA. |  |  | F.A.P. RTE. SECTION COUNTY TOTAL SHEETS SHEET NO.<br>734 77-2-2 & 77-2B-1 WINNEBAGO 530 169 |  |
| PLOT SCALE = 50,000 FT / IN.<br>PLOT DATE = 4/2/2011                                |  |  | DATE 01-14-11                                    |  |  | PROJECT BEGINS STA. 691+51.10                                   |  |  | CONTRACT NO. 64813<br>FED. ROAD DIST. NO. ILLINOIS FED. AID PROJECT                                                               |  |  |                                                                                             |  |