

**DRAINAGE LEGEND**

- PRC PRECAST REINFORCED CONCRETE
- FES FLARED END SECTION
- EORS ELLIPTICAL EQUIVALENT ROUND SIZE
- CL CLASS
- T TYPE

**DRAINAGE GENERAL NOTES:**

1. THE CONTRACTOR SHALL COORDINATE THE PROPOSED DRAINAGE SYSTEM CONSTRUCTION WITH ALL OTHER UTILITY ADJUSTMENTS AND INSTALLATIONS AS APPROVED BY THE ENGINEER. THIS WORK SHALL BE INCLUDED IN CONSTRUCTION OF THE PROPOSED DRAINAGE SYSTEM.
2. DURING CONSTRUCTION, THE CONTRACTOR SHALL MAINTAIN ALL SURFACE DRAINAGE WITHIN THE PROJECT LIMITS. ALL STORM FLOW MUST BE MAINTAINED AT ALL TIMES, UNLESS OTHERWISE DIRECTED BY THE ENGINEER.
3. ANY EXISTING DRAINAGE FACILITIES DISTURBED OR DAMAGED DURING CONSTRUCTION SHALL BE REPAIRED OR REPLACED AT CONTRACTORS EXPENSE. THIS WORK SHALL MEET THE SATISFACTION OF THE ENGINEER.
4. ROADWAY AND DITCH PROFILES ARE SHOWN ON PROFILE SHEETS.
5. SEE BOX CULVERT PLANS FOR DETAILS OF BOX CULVERTS.
6. LATERAL DISTANCES FROM THE CENTERLINES/BASELINES ON ALL INLETS IN A CURB LINE ARE AT THE EDGE OF PAVEMENT. LATERAL DISTANCES FROM THE CENTERLINES/BASELINES ON ALL INLETS OR MANHOLES ARE TO THE CENTER OF LID.
7. ALL CULVERT PIPES UNDER DRIVEWAYS SHALL MATCH FLOW LINES OF DITCH.
8. ALL PIPE UNDERDRAIN HEADWALLS INSTALLED PER STANDARD 601001.
9. ALL CORRUGATED METAL PIPE (CMP) REMOVALS SHALL BE INCLUDED IN EARTH EXCAVATION.
10. ALL RIPRAP DIMENSIONS AND CLASS SHOWN ON EROSION CONTROL PLANS.

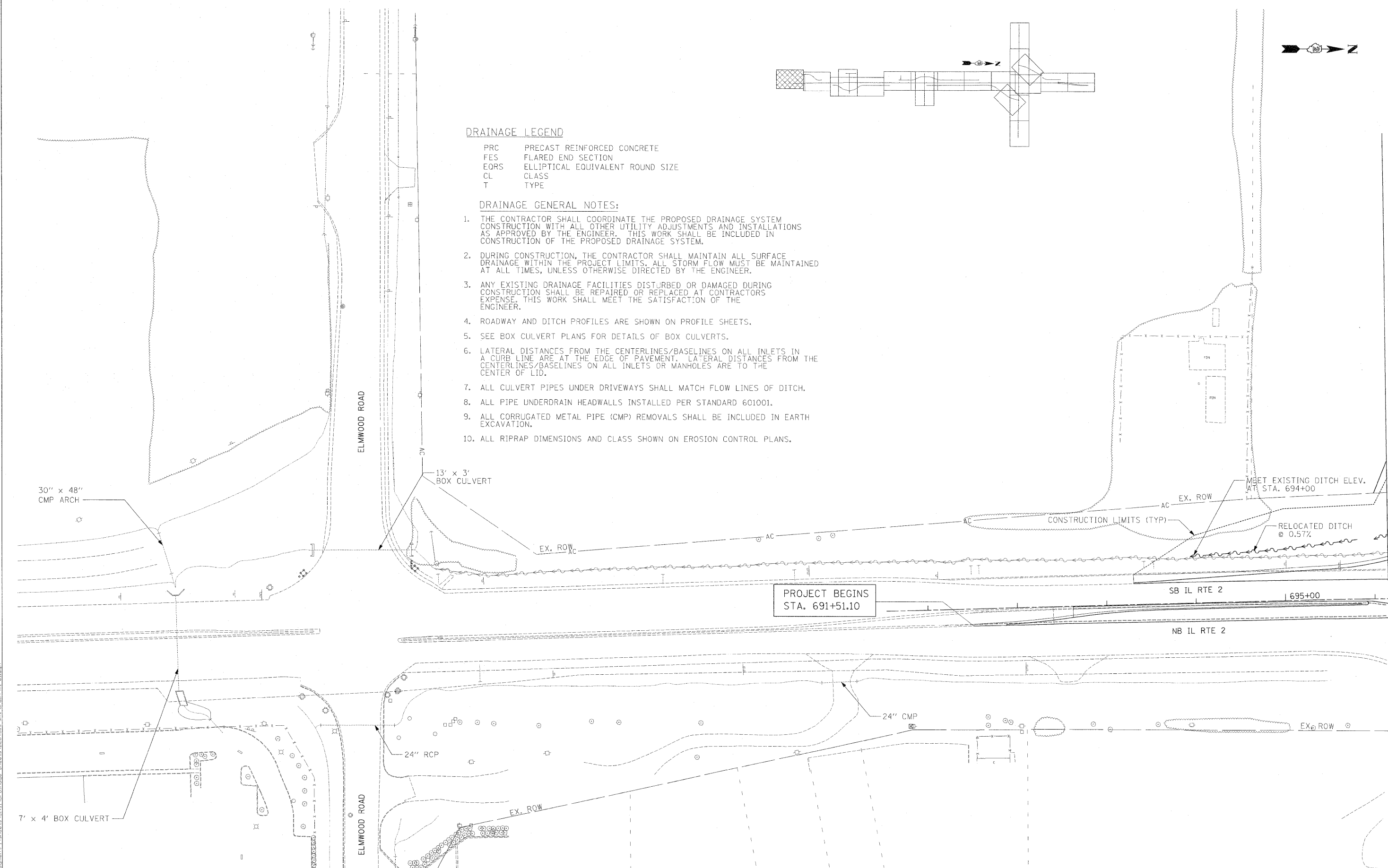

I:\projects\11254\segment\1\sheet\civil\ drainage\Sheet\0264813.dwg

USER NAME = zairowd	DESIGNED STS/GC	REVISED -
	DRAWN RDT	REVISED -
PLOT SCALE = 50.0000 FT / IN.	CHECKED GC	REVISED -
PLOT DATE = 2/2/2011	DATE 01-14-11	REVISED -

**STATE OF ILLINOIS  
DEPARTMENT OF TRANSPORTATION**

ILLINOIS ROUTE 2 DRAINAGE PLAN 1 ELMWOOD RD. TO STA 696+15	
SCALE: 1"=50'	SHEET NO. 190 OF 530 SHEETS
STA.	TO STA.

F.A.P. RTE. 734	SECTION 77-2-2 & 77-2B-1	COUNTY WINNEBAGO	TOTAL SHEETS 530	SHEET NO. 190
FED. ROAD DIST. NO. [ILLINOIS] FED. AID PROJECT			CONTRACT NO. 64813	