

FOR CASTLE DRIVE SEE DRAINAGE PLAN 13

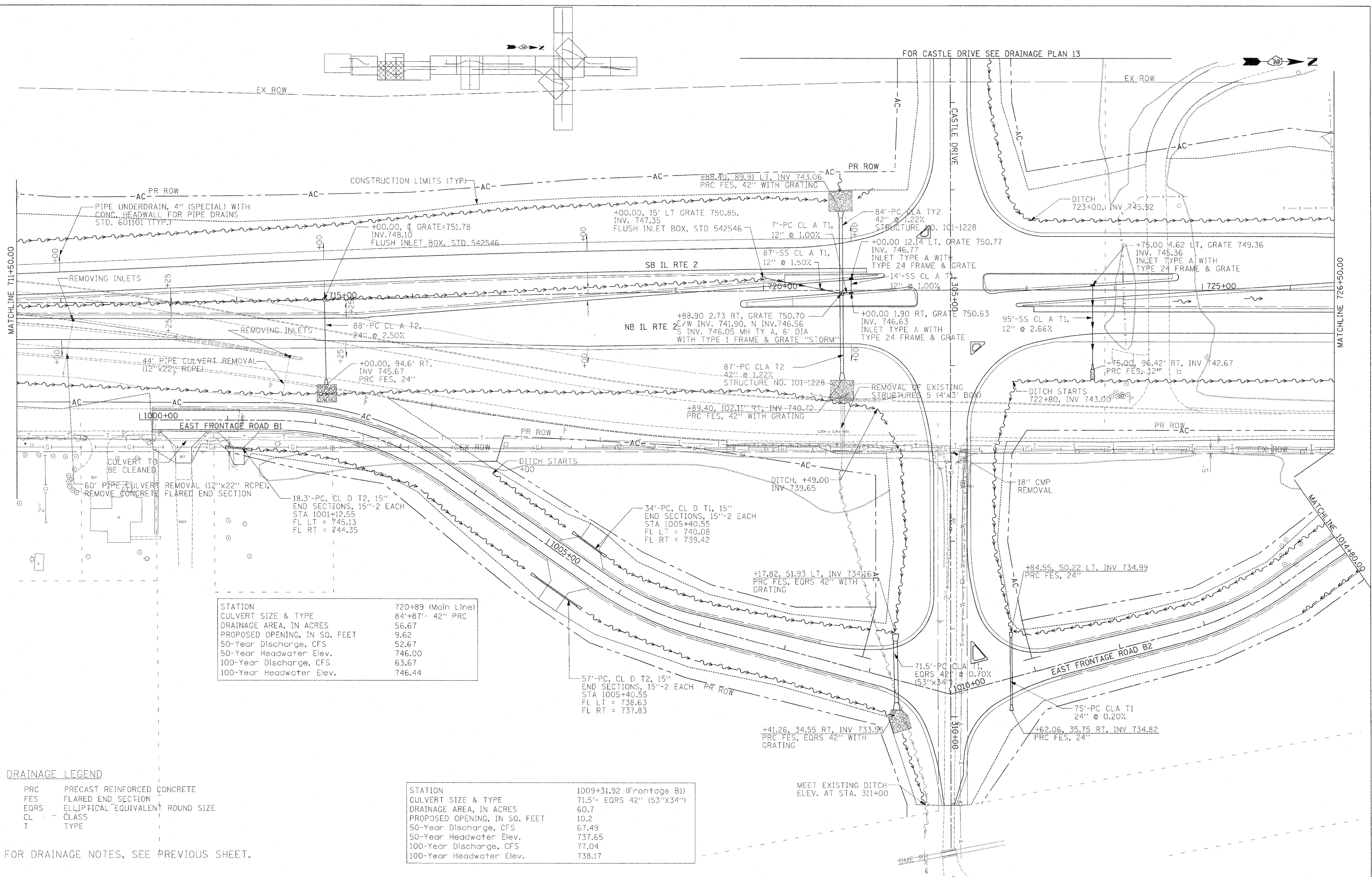

STATION	720+89 (Main Line)
CULVERT SIZE & TYPE	84'+87'- 42" PRC
DRAINAGE AREA, IN ACRES	56.67
PROPOSED OPENING, IN SQ. FEET	9.62
50-Year Discharge, CFS	52.67
50-Year Headwater Elev.	746.00
100-Year Discharge, CFS	63.67
100-Year Headwater Elev.	746.44

STATION	1009+31.92 (Frontage B1)
CULVERT SIZE & TYPE	71.5'- EORS 42" (53"x34")
DRAINAGE AREA, IN ACRES	60.7
PROPOSED OPENING, IN SQ. FEET	10.2
50-Year Discharge, CFS	67.49
50-Year Headwater Elev.	737.65
100-Year Discharge, CFS	77.04
100-Year Headwater Elev.	738.17

DRAINAGE LEGEND

- PRC PRECAST REINFORCED CONCRETE
- FES FLARED END SECTION
- EORS ELLIPTICAL EQUIVALENT ROUND SIZE
- CL CLASS
- T TYPE

FOR DRAINAGE NOTES, SEE PREVIOUS SHEET.

**STATE OF ILLINOIS
DEPARTMENT OF TRANSPORTATION**

ILLINOIS ROUTE 2 DRAINAGE PLAN 3 STA 711+50 TO 726+50		F.A.P. RTE. 734	SECTION 77-2-2 & 77-2B-1	COUNTY WINNEBAGO	TOTAL SHEETS 530	SHEET NO. 192
SCALE: 1"=50'	SHEET NO. 192 OF 530 SHEETS	STA.	TO STA.	FED. ROAD DIST. NO.	ILLINOIS FED. AID PROJECT	CONTRACT NO. 64813