

DRAINAGE LEGEND

- PRC PRECAST REINFORCED CONCRETE
- FES FLARED END SECTION
- EQRS ELLIPTICAL EQUIVALENT ROUND SIZE
- CL CLASS
- T TYPE

DRAINAGE GENERAL NOTES:

1. THE CONTRACTOR SHALL COORDINATE THE PROPOSED DRAINAGE SYSTEM CONSTRUCTION WITH ALL OTHER UTILITY ADJUSTMENTS AND INSTALLATIONS AS APPROVED BY THE ENGINEER. THIS WORK SHALL BE INCLUDED IN CONSTRUCTION OF THE PROPOSED DRAINAGE SYSTEM.
2. DURING CONSTRUCTION, THE CONTRACTOR SHALL MAINTAIN ALL SURFACE DRAINAGE WITHIN THE PROJECT LIMITS. ALL STORM FLOW MUST BE MAINTAINED AT ALL TIMES, UNLESS OTHERWISE DIRECTED BY THE ENGINEER.
3. ANY EXISTING DRAINAGE FACILITIES DISTURBED OR DAMAGED DURING CONSTRUCTION SHALL BE REPAIRED OR REPLACED AT CONTRACTORS EXPENSE. THIS WORK SHALL MEET THE SATISFACTION OF THE ENGINEER.
4. ROADWAY AND DITCH PROFILES ARE SHOWN ON PROFILE SHEETS.
5. SEE BOX CULVERT PLANS FOR DETAILS OF BOX CULVERTS.

6. LATERAL DISTANCES FROM THE CENTERLINES/BASELINES ON ALL INLETS IN A CURB LINE ARE AT THE EDGE OF PAVEMENT. LATERAL DISTANCES FROM THE CENTERLINES/BASELINES ON ALL INLETS OR MANHOLES ARE TO THE CENTER OF LID.
7. ALL CULVERT PIPES UNDER DRIVEWAYS SHALL MATCH FLOW LINES OF DITCH.
8. ALL PIPE UNDERDRAIN HEADWALLS INSTALLED PER STANDARD 601001.
9. ALL CORRUGATED METAL PIPE (CMP) REMOVALS SHALL BE INCLUDED IN EARTH EXCAVATION.
10. ALL RIPRAP DIMENSIONS AND CLASS SHOWN ON EROSION CONTROL PLANS.

FOR WET BASIN DATA POINT STATIONING AND OFFSET, SEE DRAINAGE PLAN 5 FOR DETAILS.

STATION	783+48 (Main Line)
CULVERT SIZE & TYPE	2-18"-EQRS 48" (60"x38")
DRAINAGE AREA, IN ACRES	80.7
PROPOSED OPENING, IN SQ. FEET	25.8
50-Year Discharge, CFS	97.04
50-Year Headwater Elev.	748.28
100-Year Discharge, CFS	111.45
100-Year Headwater Elev.	748.52

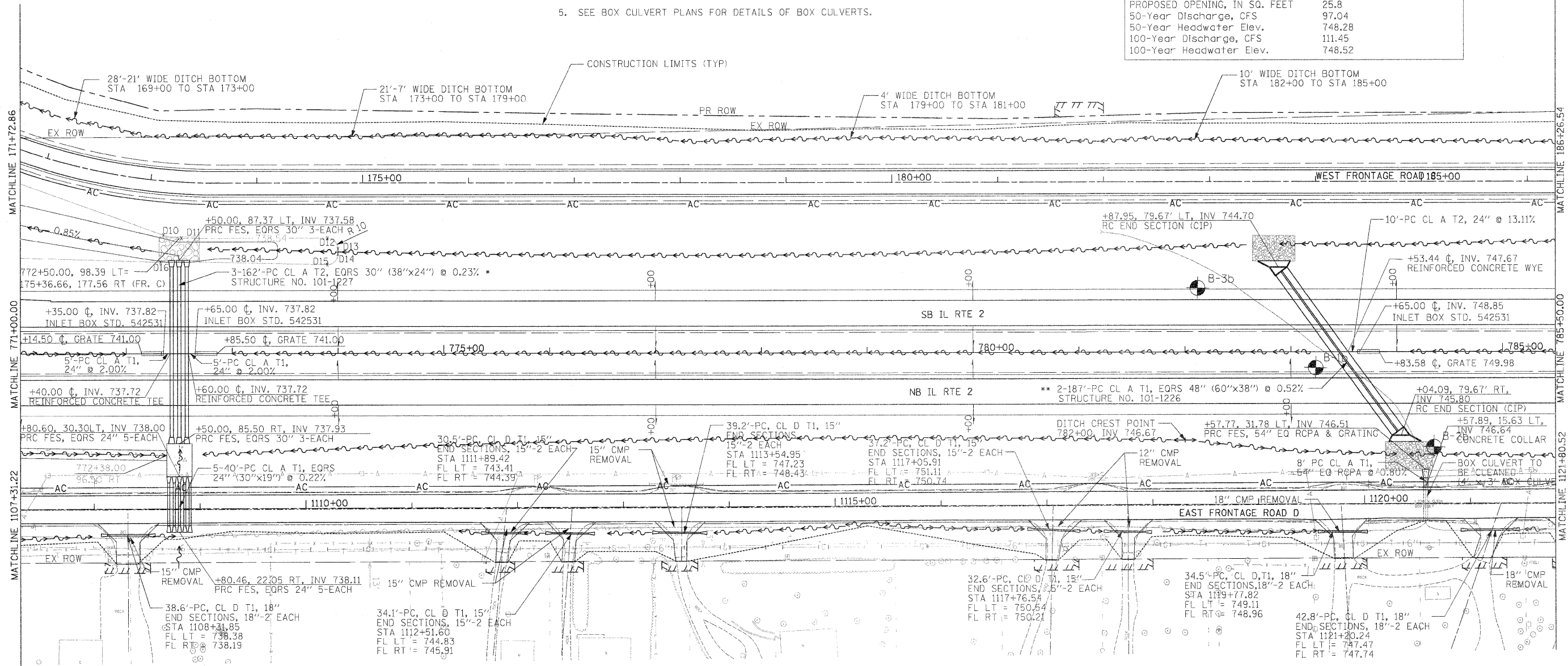

STATION	772+50 (Main Line)
CULVERT SIZE & TYPE	3-16"-EQRS 30" (38"x24")
DRAINAGE AREA, IN ACRES	74.4
PROPOSED OPENING, IN SQ. FEET	15.3
50-Year Discharge, CFS	71.26
50-Year Headwater Elev.	740.21
100-Year Discharge, CFS	83.83
100-Year Headwater Elev.	740.53

STATION	1108+80 (Front. Rd. D)
CULVERT SIZE & TYPE	5-41"-EQRS 24" (30"x19")
DRAINAGE AREA, IN ACRES	71
PROPOSED OPENING, IN SQ. FEET	15.7
50-Year Discharge, CFS	68
50-Year Headwater Elev.	740.46
100-Year Discharge, CFS	80
100-Year Headwater Elev.	741.07

* WORKING PLATFORM OF 12" THICK BREAKER-RUN CRUSHED STONE SHALL BE USED. THE CAPPING AGGREGATE 6" SHOULD BE CA 7 AND IS INCLUDED IN THE COST OF THE PIPE CULVERT.

** WORKING PLATFORM OF 18" THICK BREAKER-RUN CRUSHED STONE SHALL BE USED. THE CAPPING AGGREGATE 6" SHOULD BE CA 7 AND IS INCLUDED IN THE COST OF THE PIPE CULVERT.

USER NAME = unomper	DESIGNED STS/GC	REVISED
PLOT SCALE = 500.0000 FT / IN.	DRAWN RDT	REVISED
PLOT DATE = 4/4/2011	CHECKED GC	REVISED
	DATE 01-14-11	REVISED

**STATE OF ILLINOIS
DEPARTMENT OF TRANSPORTATION**

ILLINOIS ROUTE 2 DRAINAGE PLAN 7 STA 777+40 TO 793+70	
SCALE: 1"=50'	SHEET NO. 196 OF 530 SHEETS
STA.	TO STA.

F.A.P. RTE.	SECTION	COUNTY	TOTAL SHEETS	SHEET NO.
734	77-2-2 & 77-2B-1	WINNEBAGO	530	196
FED. ROAD DIST. NO.		ILLINOIS FED. AID PROJECT		
CONTRACT NO. 64813				