

DATE	
BY	
SUPERVISED	
DESIGNED	
DRAWN	
CHECKED	
PLotted	
NO. OF SHEETS	
NO. OF BOOKS	
AREAS CHECKED	

DATE	
BY	
SUPERVISED	
DESIGNED	
DRAWN	
CHECKED	
PLotted	
NO. OF SHEETS	
NO. OF BOOKS	
AREAS CHECKED	

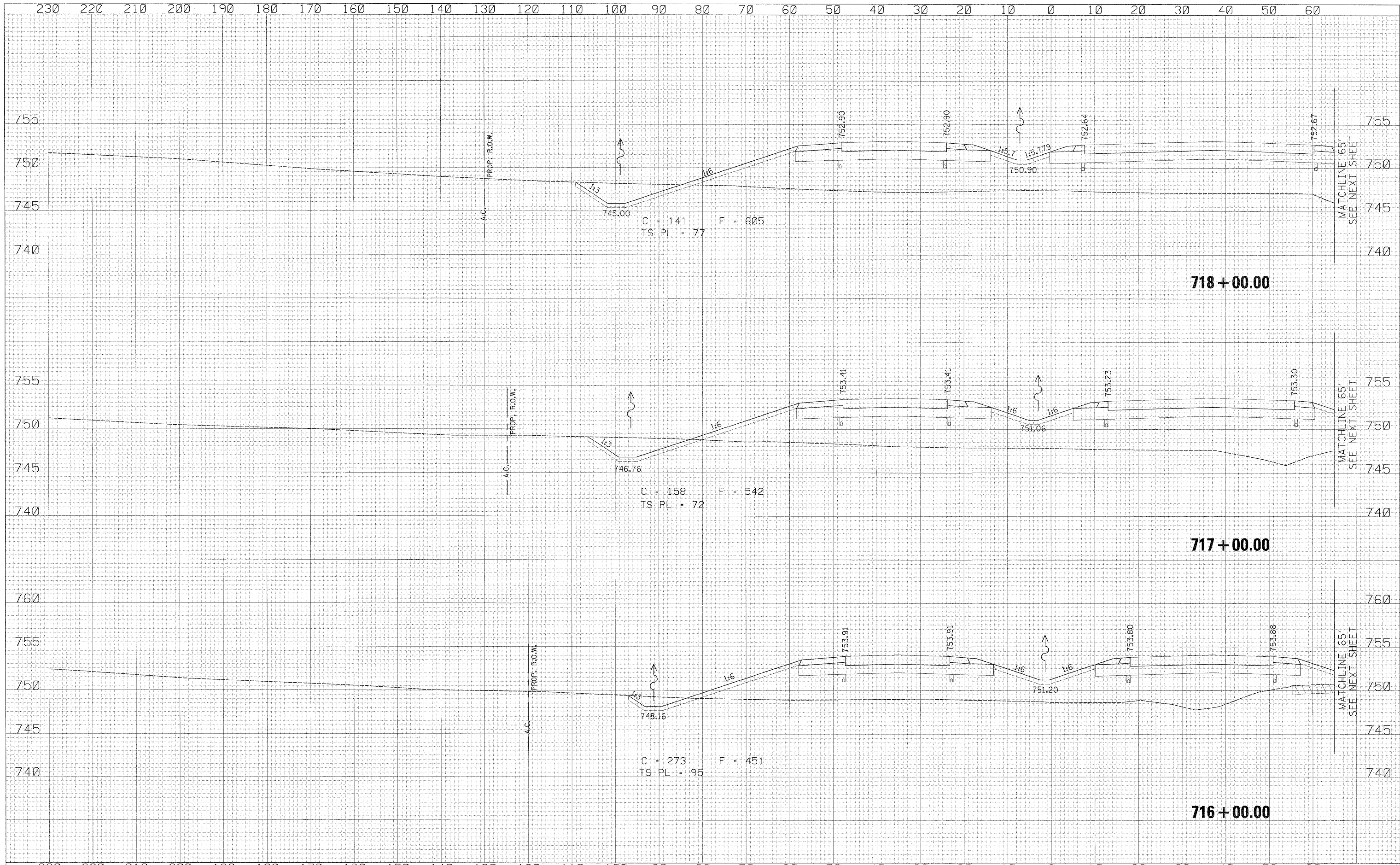

USER NAME = zulkowad	DESIGNED - RDT	REVISED -
PLotted SCALE = 10.0000 "/td> <td>DRAWN - RDT</td> <td>REVISED -</td>	DRAWN - RDT	REVISED -
PLotted DATE = 2/2/2011	CHECKED - GC	REVISED -
	DATE - 01-14-11	REVISED -

**STATE OF ILLINOIS  
DEPARTMENT OF TRANSPORTATION**

ILLINOIS ROUTE 2  
CROSS SECTIONS

SCALE:  $\frac{1}{2}$ " = 10'  
SHEET NO. 338 OF 530 SHEETS STA. 716+00.00 TO STA. 718+00.00

F.A.P. RTE.	SECTION	COUNTY	TOTAL SHEETS	SHEET NO.
734	77-2-2 & 77-2B-1	WINNEBAGO	530	338
CONTRACT NO. 64813				

ILLINOIS FED. AID PROJECT

I:\projects\11254\segment 1\sheet\civil\section\0264813.sht xssht IL2.dgn