

DATE	
BY	
SUPERVISED	
PLOTTED	
NOTE BOOK	
AREAS CHECKED	
NO.	

DATE	
BY	
SUPERVISED	
PLOTTED	
NOTE BOOK	
AREAS CHECKED	
NO.	

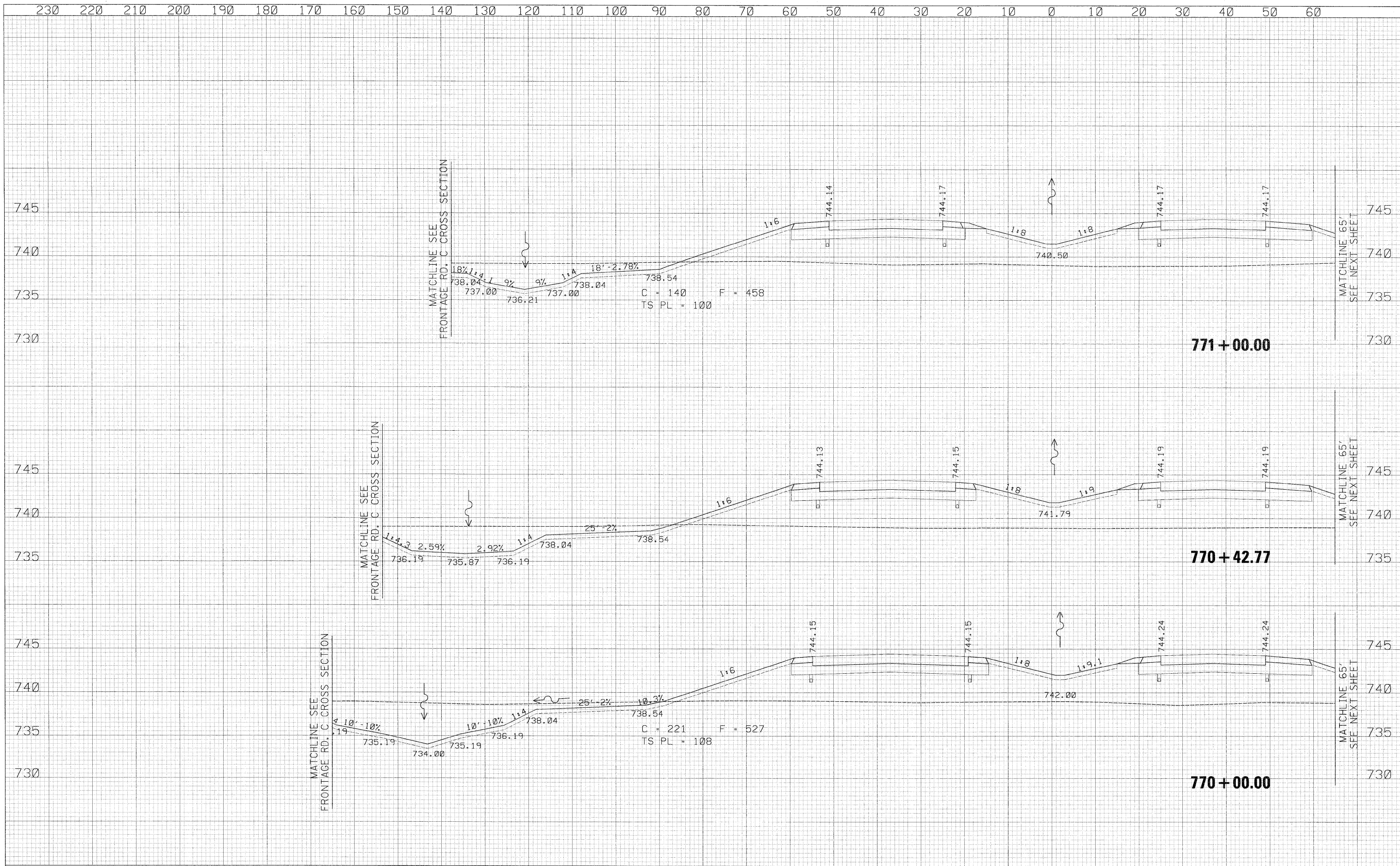

230	220	210	200	190	180	170	160	150	140	130	120	110	100	90	80	70	60	50	40	30	20	10	0	10	20	30	40	50	60				
USER NAME = zulkowsd												DESIGNED - RDT		REVISED -		ILLINOIS ROUTE 2 CROSS SECTIONS SCALE: 1" = 10' SHEET NO. 396 OF 530 SHEETS STA. 770+00.00 TO STA. 771+00.00												F.A.P. RTE. 734	SECTION 77-2-2 & 77-28-1		COUNTY WINNEBAGO	TOTAL SHEETS 530	SHEET NO. 396
PLOT SCALE = 10.0000' / IN.												DRAWN - RDT		REVISED -														CONTRACT NO. 64813					
PLOT DATE = 2/2/2011												CHECKED - GC		REVISED -														[ILLINOIS] FED. AID PROJECT					
DATE = 01-14-11												REVISED -																					

h:\projects\11254\segment 1\sheet\civil\section\0264613-shr-xsh1-IL2.dgn