

DATE	
BY	
REVISIONS	
NO.	
DATE	
BY	
REVISIONS	
NO.	
DATE	
BY	
REVISIONS	
NO.	

DATE	
BY	
REVISIONS	
NO.	
DATE	
BY	
REVISIONS	
NO.	
DATE	
BY	
REVISIONS	
NO.	

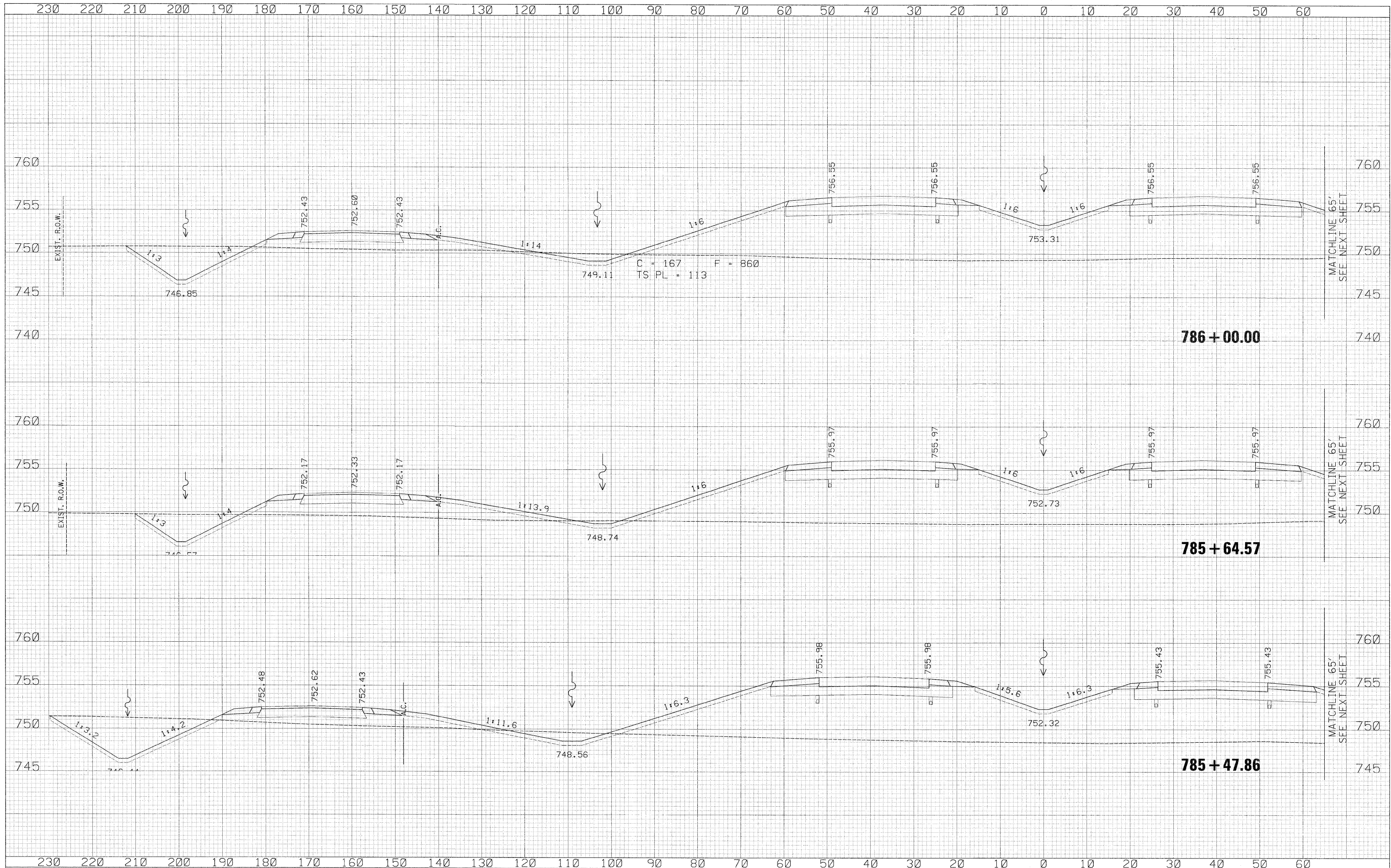

USER NAME = zulkwad	DESIGNED - RDT	REVISED -	ILLINOIS ROUTE 2 CROSS SECTIONS SCALE: $H:V = 1:10$ SHEET NO. 414 OF 530 SHEETS   STA. 785+47.86 TO STA. 786+00.00	F.A.P. R.T.E. 734	SECTION 77-2-2 & 77-2B-1	COUNTY WINNEBAGO	TOTAL SHEETS 530	SHEET NO. 414
PLOT SCALE = 10.0000' / IN.	DRAWN - RDT	REVISED -		STATE OF ILLINOIS DEPARTMENT OF TRANSPORTATION	CONTRACT NO. 64813		ILLINOIS FED. AID PROJECT	
PLOT DATE = 2/2/2011	CHECKED - GC	REVISED -						
	DATE - 01-14-11	REVISED -						

\\projects\11254\segment 1\sheet\civil\section\0284813-sht-ssht-1L2.dgn