

230 220 210 200 190 180 170 160 150 140 130 120 110 100 90 80 70 60 50 40 30 20 10 0 10 20 30 40 50 60

DATE	
BY	
FINAL SURVEY	
NOTED	
PLATTED	
TEMPLATE	
AREAS	
CHECKED	
NO.	

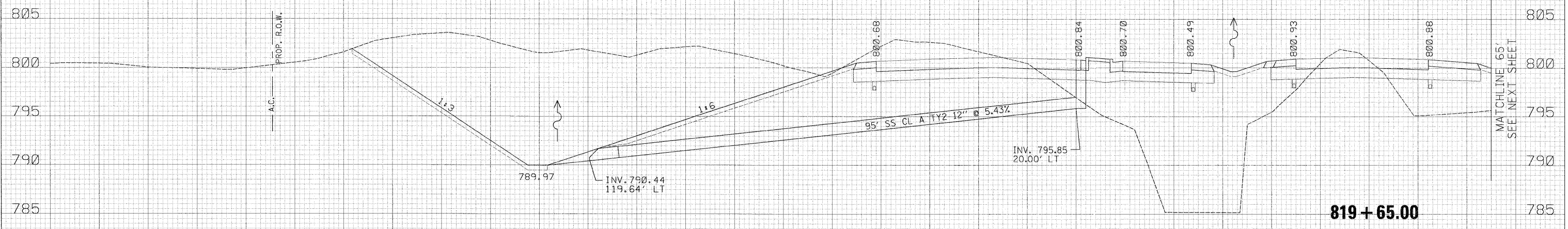

DATE	
BY	
ORIGINAL SURVEY	
NOTED	
PLATTED	
TEMPLATE	
AREAS	
CHECKED	
NO.	

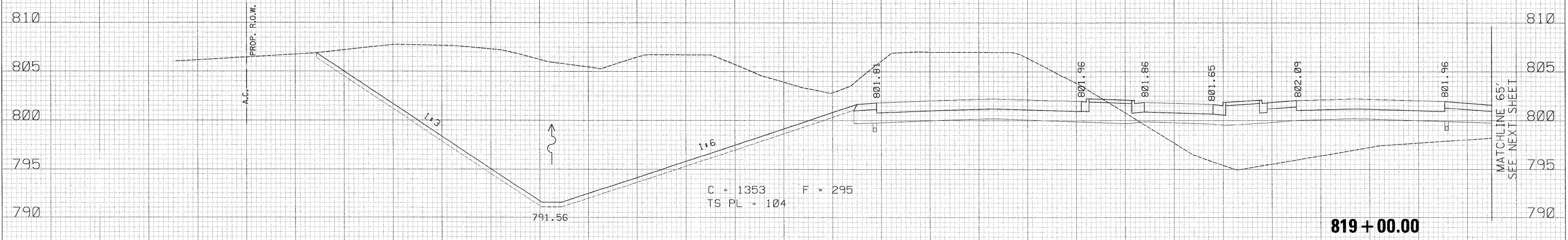

230 220 210 200 190 180 170 160 150 140 130 120 110 100 90 80 70 60 50 40 30 20 10 0 10 20 30 40 50 60

USER NAME = zulkowd	DESIGNED - RDT	REVISED -
PLOT SCALE = 10.0000' / IN.	DRAWN - RDT	REVISED -
PLOT DATE = 2/2/2011	CHECKED - GC	REVISED -
	DATE - 01-14-11	REVISED -

STATE OF ILLINOIS  
DEPARTMENT OF TRANSPORTATION

ILLINOIS ROUTE 2  
CROSS SECTIONS

SCALE: 1" = 10' SHEET NO. 446 OF 530 SHEETS STA. 819+00.00 TO STA. 819+65.00

F.A.P. RTE.	SECTION	COUNTY	TOTAL SHEETS	SHEET NO.
734	77-2-2 & 77-23-1	WINNEBAGO	530	446
CONTRACT NO. 64813			ILLINOIS FED. AID PROJECT	

H:\projects\11254\segment 1\sheet\civil\section\0264813-aht-xaht-ll2.dgn