

DATE	
BY	
DESIGNED	
DRAWN	
CHECKED	
DATE	

DATE	
BY	
DESIGNED	
DRAWN	
CHECKED	
DATE	

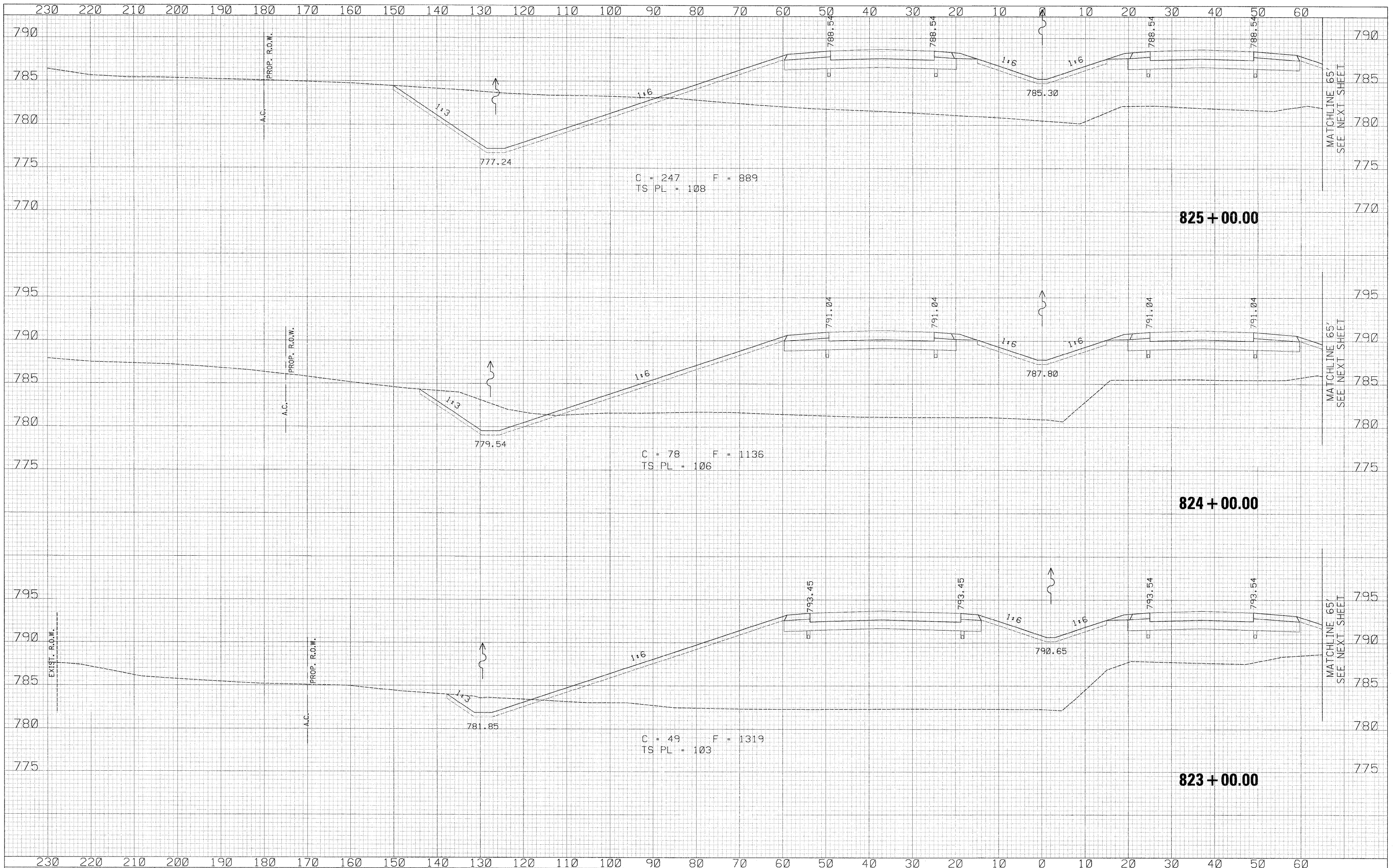

USER NAME = zuluowad	DESIGNED - RDT	REVISED -	STATE OF ILLINOIS DEPARTMENT OF TRANSPORTATION	ILLINOIS ROUTE 2 CROSS SECTIONS		F.A.P. RTE. 734	SECTION 77-2-2 & 77-28-1	COUNTY WINNEBAGO	TOTAL SHEETS 530	SHEET NO. 450
PLOT SCALE = 10.0000' / IN.	DRAWN - RDT	REVISED -		SCALE: 1" = 10'	SHEET NO. 450 OF 530 SHEETS	STA. 823+00.00 TO STA. 825+00.00	CONTRACT NO. 64813		ILLINOIS FED. AID PROJECT	
PLOT DATE = 2/2/2011	CHECKED - GC	REVISED -								

\\projects\11254\segment 1\sheet\civil\section\0264813-sht\ssht-1_2.dgn