

DATE	
BY	
SURVISED	
PLOTTED	
TEMPLATE	
NOTE BOOK	
NO.	
AREAS CHECKED	

DATE	
BY	
SURVISED	
PLOTTED	
TEMPLATE	
NOTE BOOK	
NO.	
AREAS CHECKED	

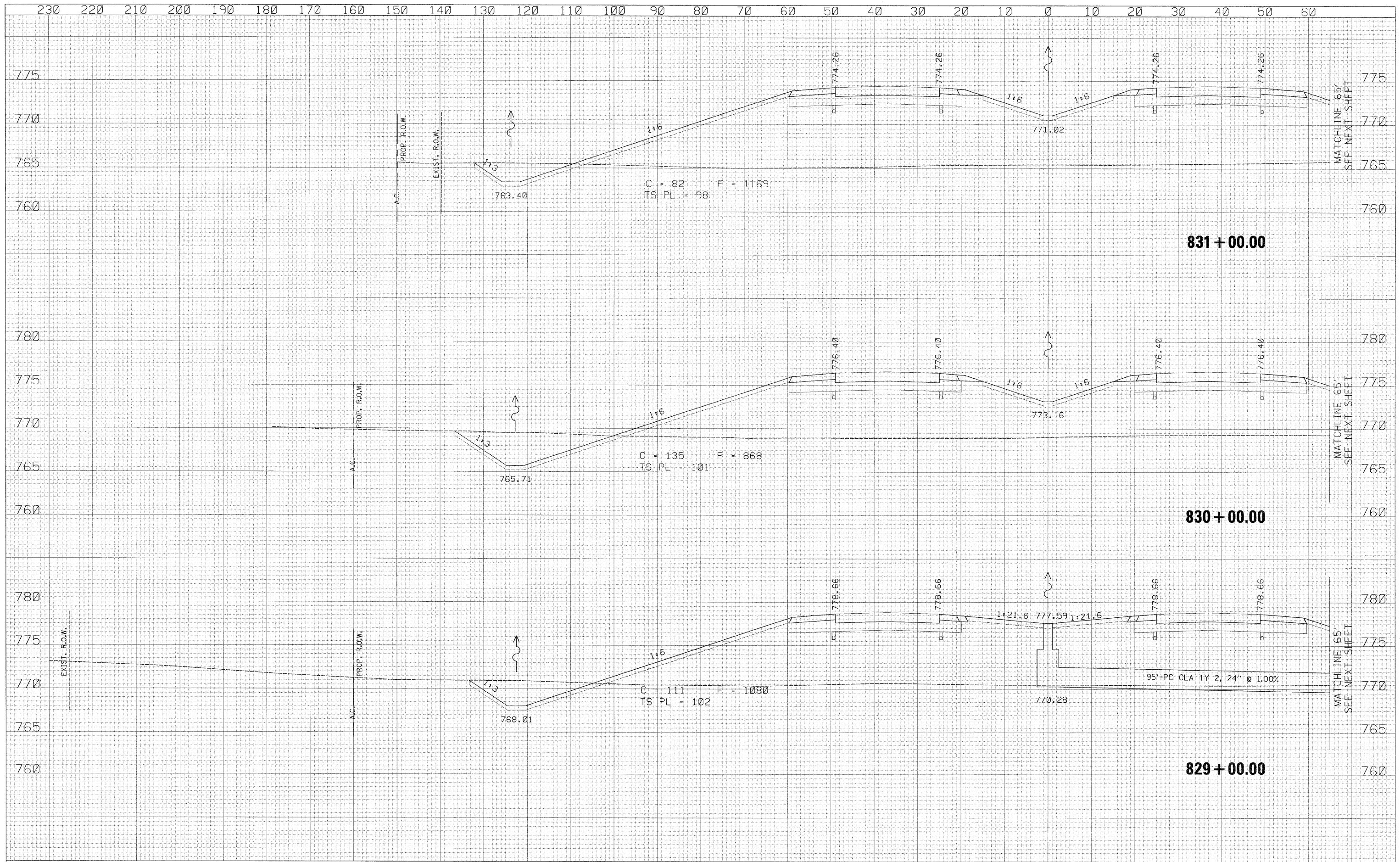

230	220	210	200	190	180	170	160	150	140	130	120	110	100	90	80	70	60	50	40	30	20	10	0	10	20	30	40	50	60										
USER NAME = zulkowd DESIGNED - RDT DRAWN - RDT CHECKED - GC DATE - 01-14-11												REVISIONS REVISIONS REVISIONS REVISIONS												STATE OF ILLINOIS DEPARTMENT OF TRANSPORTATION ILLINOIS ROUTE 2 CROSS SECTIONS SCALE: H:V = 1:10 SHEET NO. 454 OF 530 SHEETS STA. 829+00.00 TO STA. 831+00.00												F.A.P. RTE. 734 SECTION 77-2-2 & 77-2B-1 COUNTY WINNEBAGO TOTAL SHEETS 530 SHEET NO. 454 CONTRACT NO. 64813			

z:\projects\11254\segment 1\sheet\civil\section\0264813-ah-t-xsh-t-ll2.dgn