

DATE	
BY	
FINAL SURVEY	
SURVEY PLOTTED	
NOTE BOOK	
AREAS CHECKED	
NO.	

DATE	
BY	
ORIGINAL SURVEY	
SURVEY PLOTTED	
NOTE BOOK	
AREAS CHECKED	
NO.	

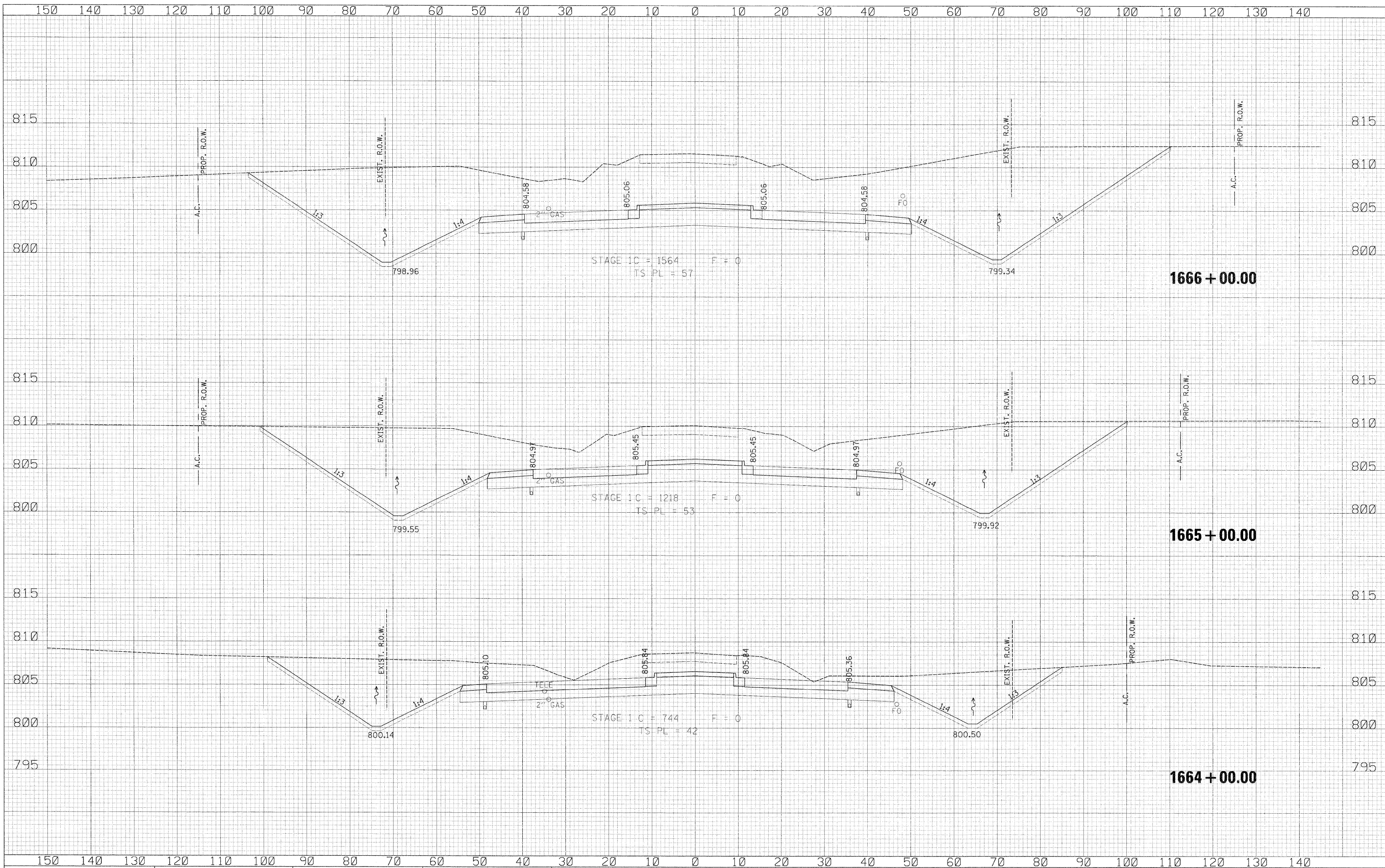

USER NAME = zulkowd	DESIGNED RDT	REVISED -	STATE OF ILLINOIS DEPARTMENT OF TRANSPORTATION	LATHAM ROAD CROSS SECTIONS		F.A.P. RTE.	SECTION	COUNTY	TOTAL SHEETS	SHEET NO.	
PLOT SCALE = 10.0000' / IN.	DRAWN RDT	REVISED -		SCALE: 1/4" = 10'	SHEET NO. 490 OF 530 SHEETS	STA. 1664+00.00 TO STA. 1666+00.00	734	77-2-2 & 77-2B-1	WINNEBAGO	530	490
PLOT DATE = 2/2/2011	CHECKED GC	REVISED -		CONTRACT NO. 64813							
DATE 01-14-11	DATE 01-14-11	REVISED -		ILLINOIS FED. AID PROJECT							

\\projects\11254\segment 1\sheet\civil\section\0261013-sh1-xssht-Latham.dgn