

DATE	
BY	
DESIGNED	
PLOTTED	
TEMPLATE	
NOTE BOOK	
AREAS CHECKED	
NO.	

DATE	
BY	
DESIGNED	
PLOTTED	
TEMPLATE	
NOTE BOOK	
AREAS CHECKED	
NO.	

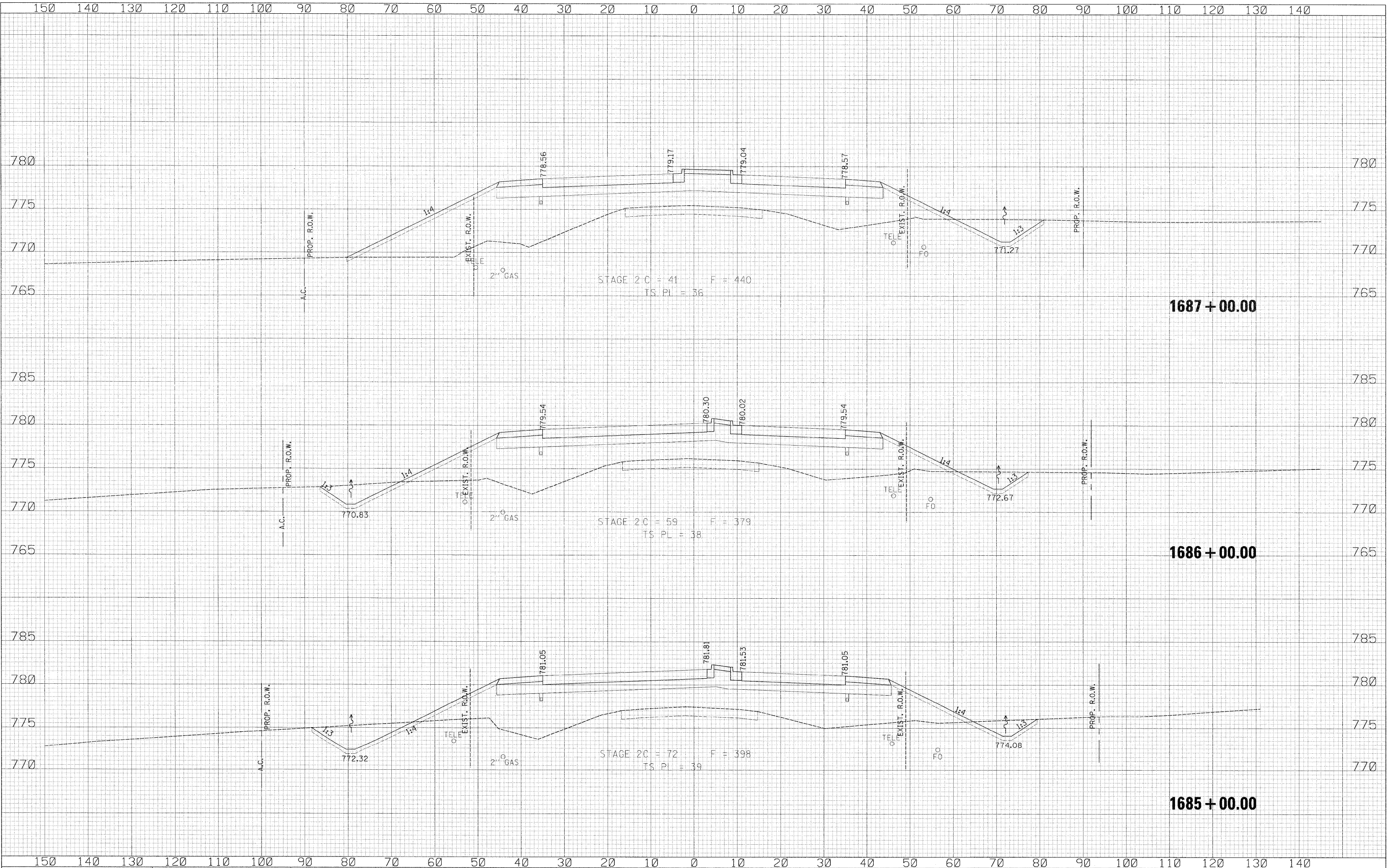

USER NAME = zuluward DESIGNED RDT DRAWN RDT CHECKED GC DATE 01-14-11	REVISED - REVISED - REVISED - REVISED -	STATE OF ILLINOIS DEPARTMENT OF TRANSPORTATION	LATHAM ROAD CROSS SECTIONS	F.A.P. R.T.E. 734 SECTION 77-2-2 & 77-2B-1 COUNTY WINNEBAGO TOTAL SHEETS 530 SHEET NO. 500 CONTRACT NO. 64813
--	--	---	-------------------------------	--