

DATE	
BY	
FINAL SURVEY	SURVEYED
NOTE BOOK	PLOTTED
NO.	TEMPLATE
	AREAS CHECKED

DATE	
BY	
ORIGINAL SURVEY	SURVEYED
NOTE BOOK	PLOTTED
NO.	TEMPLATE
	AREAS CHECKED

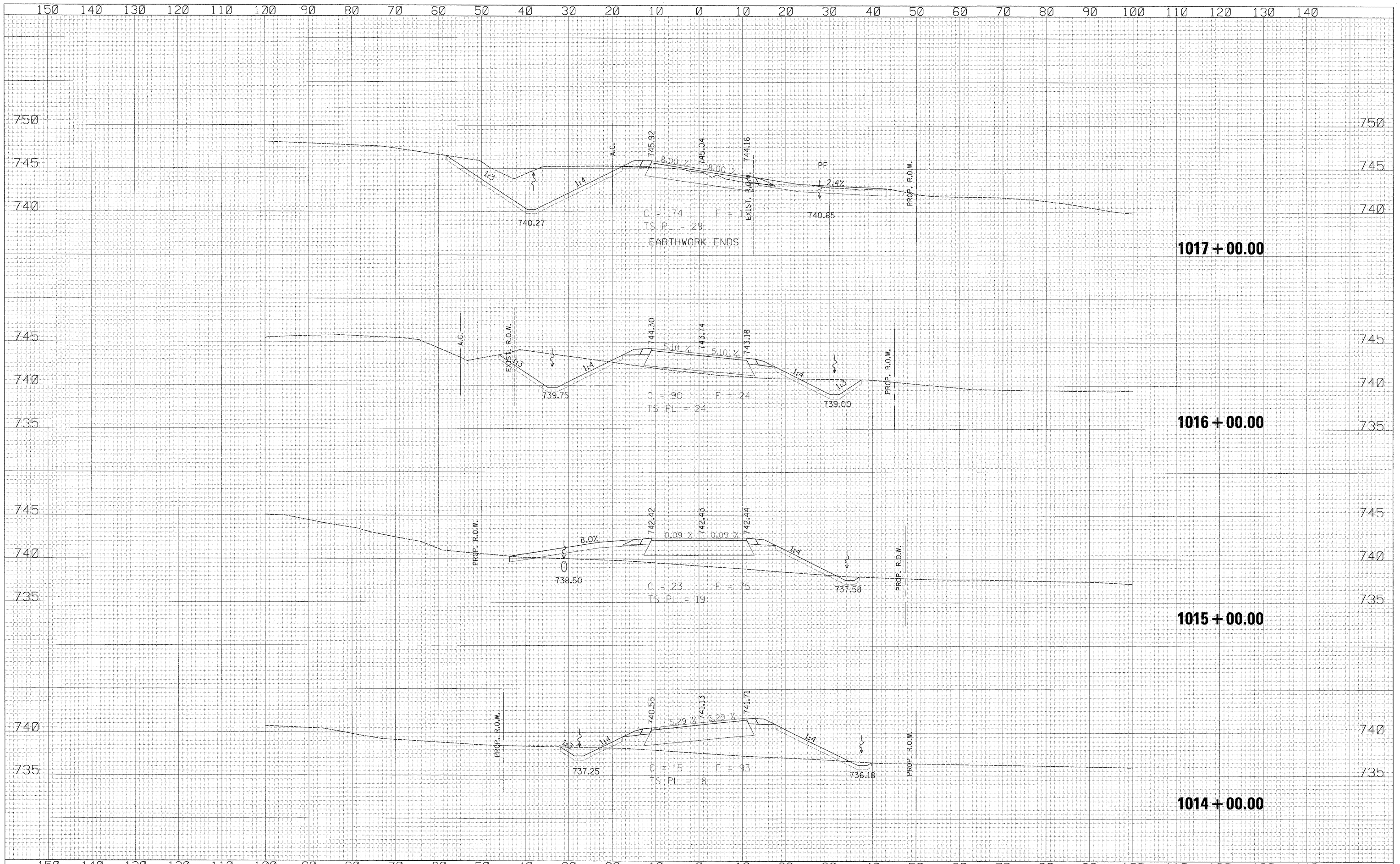

USER NAME = zulkowd	DESIGNED RDT	REVISED -	STATE OF ILLINOIS DEPARTMENT OF TRANSPORTATION	FRONTAGE ROAD B2		F.A.P. RTE.	SECTION	COUNTY	TOTAL SHEETS	SHEET NO.
PLOT SCALE = 10,000' / IN.	DRAWN RDT	REVISED -		CROSS SECTIONS		734	77-2-2 & 77-2B-1	WINNEBAGO	530	514
PLOT DATE = 2/2/2011	CHECKED GC	REVISED -		SCALE: 1" = 10'		SHEET NO. 514 OF 530 SHEETS		CONTRACT NO. 64813		ILLINOIS FED. AID PROJECT
DATE 01-14-11	DATE 01-14-11	REVISED -		STA. 1014+00.00 TO STA. 1017+00.00						

\\projects\11204\segment 1\sheet\civil\section\1026481\sheet\ssht-FR-B2.dgn