

150 140 130 120 110 100 90 80 70 60 50 40 30 20 10 0 10 20 30 40 50 60 70 80 90 100 110 120 130 140

DATE	
BY	
CHECKED	
DESIGNED	
DRAWN	
NOTED	
NO.	

DATE	
BY	
CHECKED	
DESIGNED	
DRAWN	
NOTED	
NO.	

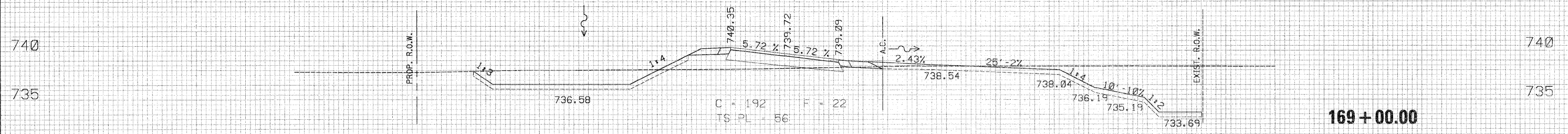

169+00.00

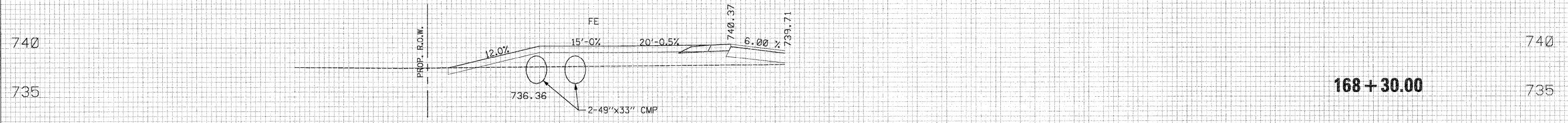

168+30.00

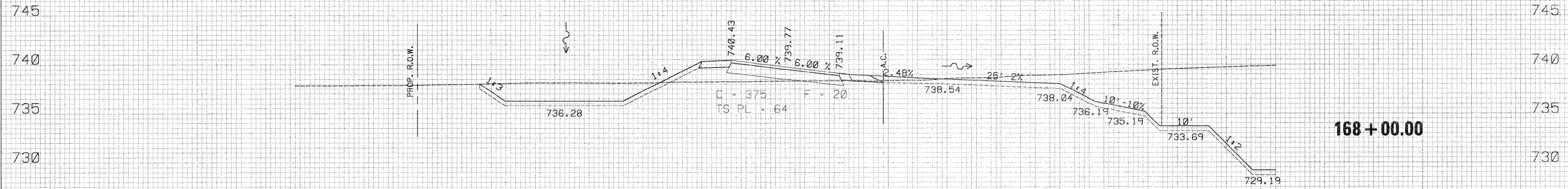

168+00.00

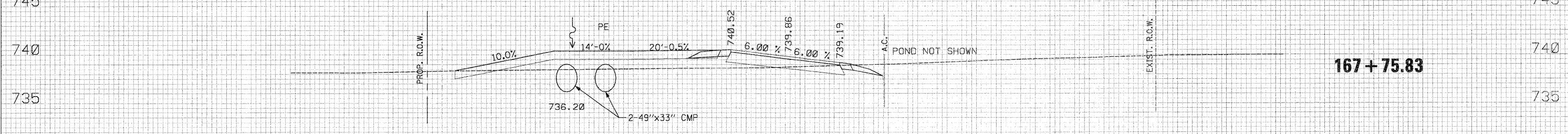

167+75.83

150 140 130 120 110 100 90 80 70 60 50 40 30 20 10 0 10 20 30 40 50 60 70 80 90 100 110 120 130 140

USER NAME: thompson
 PROJECT SCALE: 1/4" = 10'-00"
 PROJECT DATE: 4/4/2011

DESIGNED: RDT
 DRAWN: RDT
 CHECKED: GC
 DATE: 01-14-11

REVISED: -
 REVISED: -
 REVISED: -
 REVISED: -

STATE OF ILLINOIS
 DEPARTMENT OF TRANSPORTATION

FRONTAGE ROAD C
 CROSS SECTIONS

SCALE: 1/4" = 10'-00" SHEET NO. 519 OF 530 SHEETS STA. 167+75.83 TO STA. 170+00.00

F.A.P. RTE.	SECTION	COUNTY	TOTAL SHEETS	SHEET NO.
734	77-2-2 & 77-2B-1	WINNEBAGO	530	519
CONTRACT NO. 64813				
ILLINOIS FED. AID PROJECT				

\\projects\11254\Segment 1\Sheets\Civil\Section\10264813-sht-519-FR-C.dgn