

MATCH LINE 868+00.00

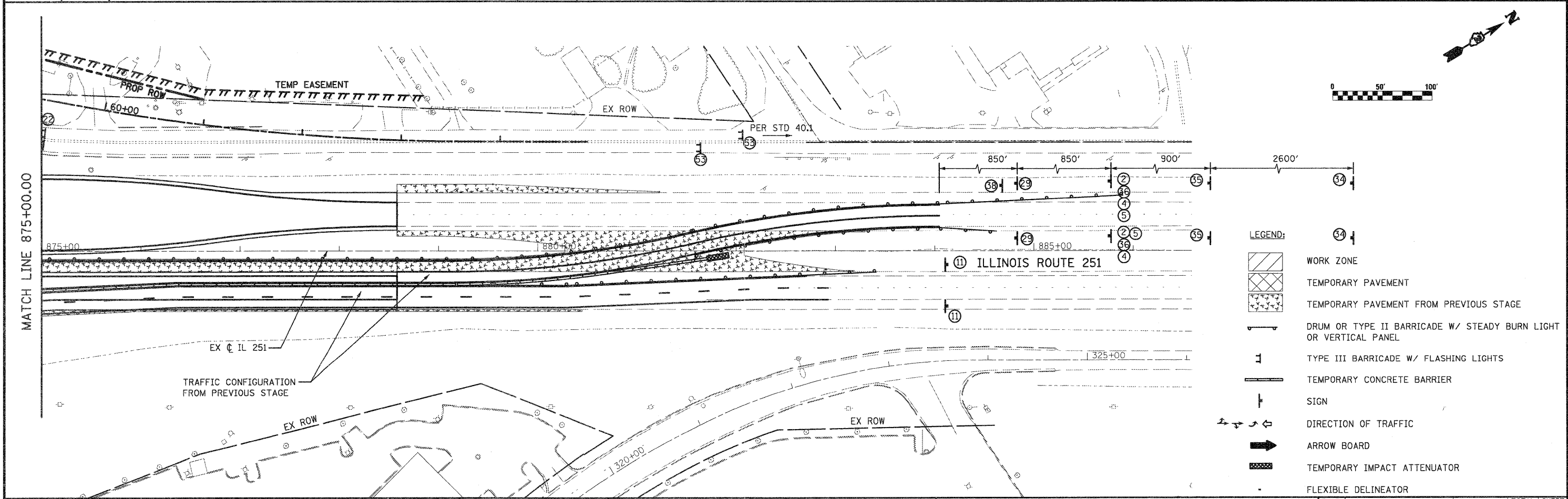

MATCH LINE 875+00.00

- LEGEND:**
- WORK ZONE
 - TEMPORARY PAVEMENT
 - TEMPORARY PAVEMENT FROM PREVIOUS STAGE
 - DRUM OR TYPE II BARRICADE W/ STEADY BURN LIGHT OR VERTICAL PANEL
 - TYPE III BARRICADE W/ FLASHING LIGHTS
 - TEMPORARY CONCRETE BARRIER
 - SIGN
 - DIRECTION OF TRAFFIC
 - ARROW BOARD
 - TEMPORARY IMPACT ATTENUATOR
 - FLEXIBLE DELINEATOR

FILE NAME = D264987-shr:staging-285.dgn	USER NAME = 3282090971	DESIGNED - LOM	REVISED -	STATE OF ILLINOIS	STAGING AND TRAFFIC CONTROL PLAN	F.A.P. RTE. 303	SECTION 129K-1	COUNTY WINNEBAGO	TOTAL SHEETS 401	SHEET NO. 117	
DRAWN - MD				DEPARTMENT OF TRANSPORTATION				STAGE 2A			
CHECKED - PDK				SCALE:				SHEET NO. OF SHEETS STA. 855+00.00 TO STA. 885+00.00			
DATE - 01-19-2011				ILLINOIS ROUTE 251				CONTRACT NO. 64987			
PLOT SCALE = 100.0000' / IN.				FED. ROAD DIST. NO. 2 ILLINOIS FED. AID PROJECT							
PLOT DATE = 1/18/2011											