











**LEGEND**

-  TEMPORARY DITCH CHECK
-  INLET & PIPE PROTECTION
-  PERIMETER EROSION BARRIER
- ① REMOVE EXISTING CLOSED LID FROM TYPE 1 FRAME AND REPLACE W/ OPEN LID, ADJUST RIM TO GRADE
- ② REMOVE TOP OF EXISTING INLET AND COVER W/ STEEL PLATE
- ③ TEMPORARY STEEL PLATE ON PROPOSED STRUCTURE
-  TEMPORARY DITCH
-  TEMPORARY SWALE
-  CONSTRUCTION ZONE
-  TEMPORARY PAVEMENT
-  TEMPORARY PAVEMENT FROM PREVIOUS STAGE
-  PERMANENT DITCH
-  EXISTING STORM SEWER
-  TEMPORARY/PROPOSED STORM SEWER

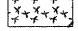
**NOTES:**

1. FOR MORE DRAINAGE INFORMATION SEE PROPOSED DRAINAGE PLANS.
2. PERIMETER EROSION BARRIER IS LOCATED ON TEMP. EASEMENT/PERM. EASEMENT/R.O.W. LINE AS SHOWN ON THE PLANS.
3. FOR MORE STAGE CONSTRUCTION INFORMATION SEE STAGING AND TRAFFIC CONTROL PLANS.

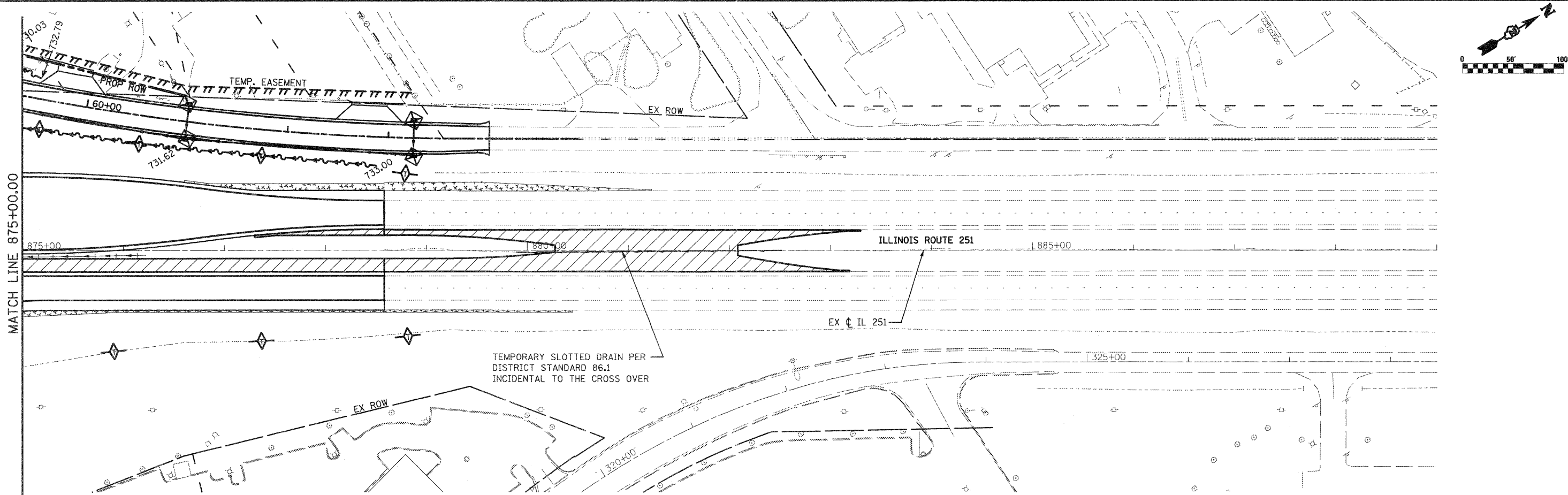
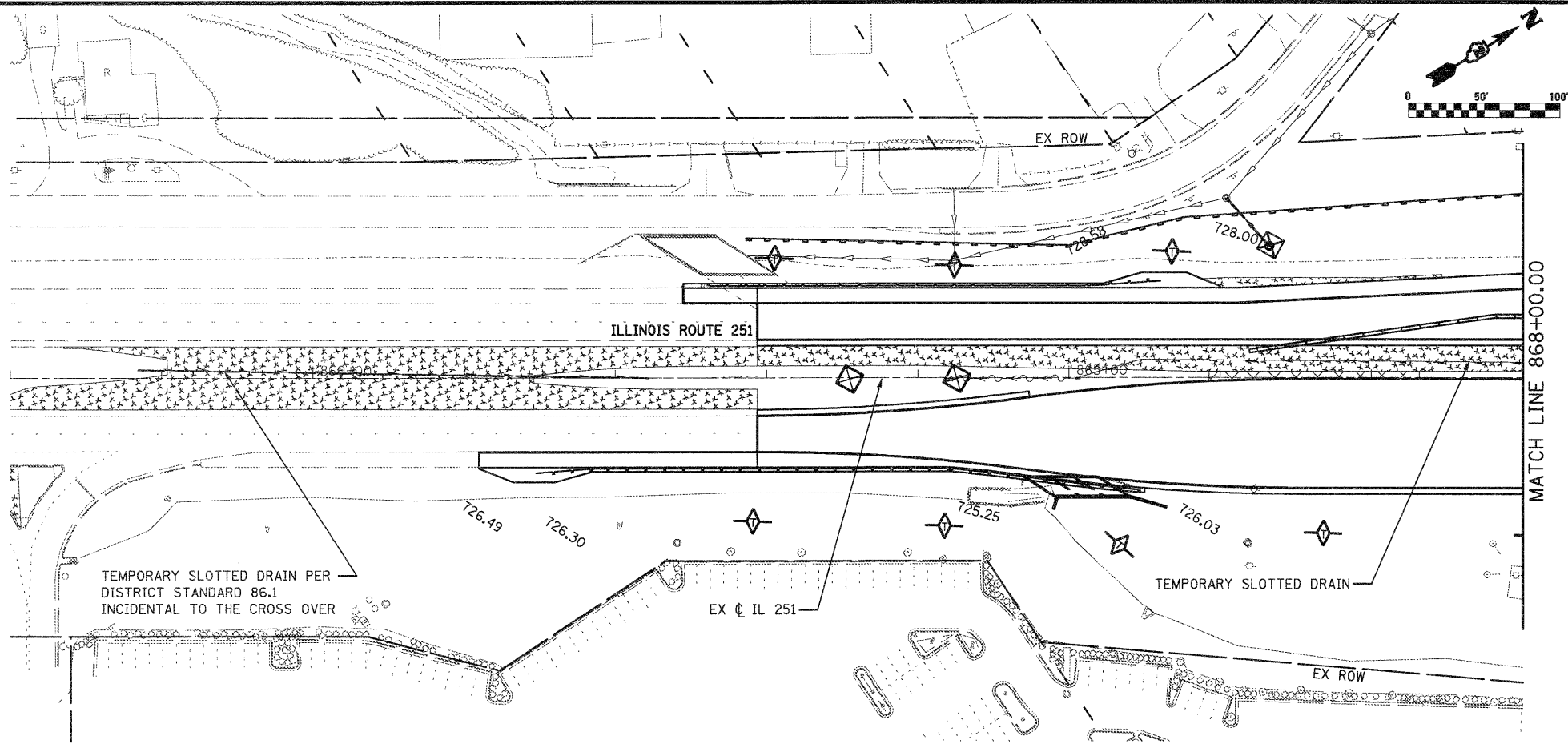

FILE NAME =  
D264987-ah-eros2C5.dgn

USER NAME = 328289971  
PLOT SCALE = 1/8" = 100.0000' / IN.  
PLOT DATE = 1/18/2011

DESIGNED - LOM  
DRAWN - MD  
CHECKED - PDK  
DATE - 01-19-2011

REVISED -  
REVISED -  
REVISED -  
REVISED -

**STATE OF ILLINOIS  
DEPARTMENT OF TRANSPORTATION**

**STORM WATER POLLUTION PREVENTION PLAN  
& TEMPORARY DRAINAGE**  
STAGE 2C 858+00.00 868+00.00  
SCALE: SHEET NO. OF SHEETS STA. 875+00.00 TO STA. 889+00.00

F.A.P. RTE.	SECTION	COUNTY	TOTAL SHEETS	SHEET NO.
303	129K-1	WINNEBAGO	401	208
				CONTRACT NO. 64987

FED. ROAD DIST. NO. 2 ILLINOIS FED. AID PROJECT