

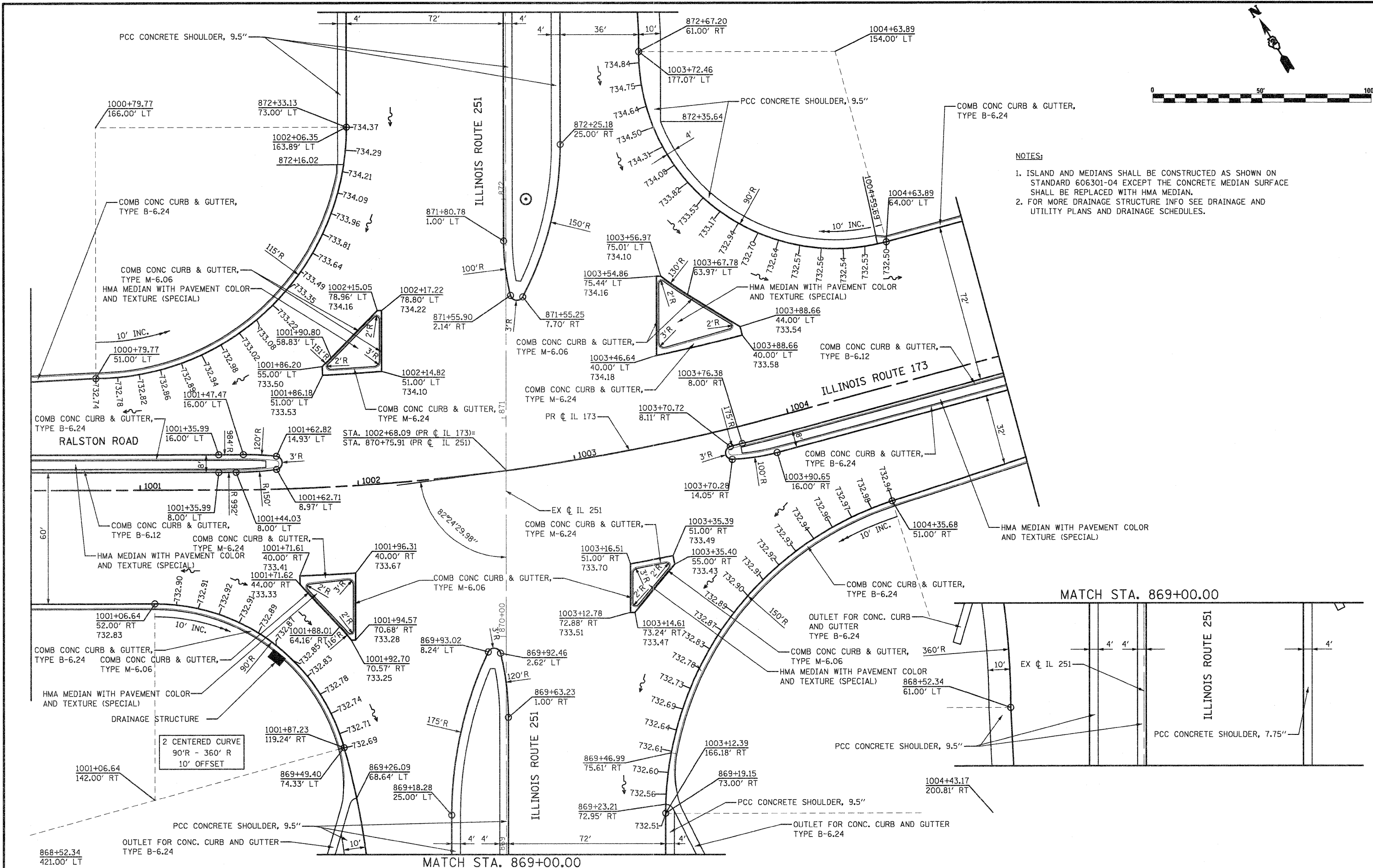

NOTES:

1. ISLAND AND MEDIANS SHALL BE CONSTRUCTED AS SHOWN ON STANDARD 606301-04 EXCEPT THE CONCRETE MEDIAN SURFACE SHALL BE REPLACED WITH HMA MEDIAN.
2. FOR MORE DRAINAGE STRUCTURE INFO SEE DRAINAGE AND UTILITY PLANS AND DRAINAGE SCHEDULES.



FILE NAME = D264987-shr-intersec-02.dgn
 USER NAME = 320209971
 PLOT SCALE = 48.0000' / IN.
 PLOT DATE = 1/18/2011

DESIGNED - LOM	REVISIONS -
DRAWN - MD	REVISIONS -
CHECKED - PDK	REVISIONS -
DATE - 01-19-2011	REVISIONS -

**STATE OF ILLINOIS
 DEPARTMENT OF TRANSPORTATION**

**INTERSECTION AND PAVEMENT ELEVATION DETAILS
 RALSTON ROAD (ILLINOIS ROUTE 173) & ILLINOIS ROUTE 251**

SCALE: SHEET NO. OF SHEETS STA. TO STA.

F.A.P. RTE. 303	SECTION 129K-1	COUNTY WINNEBAGO	TOTAL SHEETS 401	SHEET NO. 242
FED. ROAD DIST. NO. 2 ILLINOIS FED. AID PROJECT			CONTRACT NO. 64987	