

INLET SPECIAL NO. 7 & 8 REINFORCEMENT DETAIL

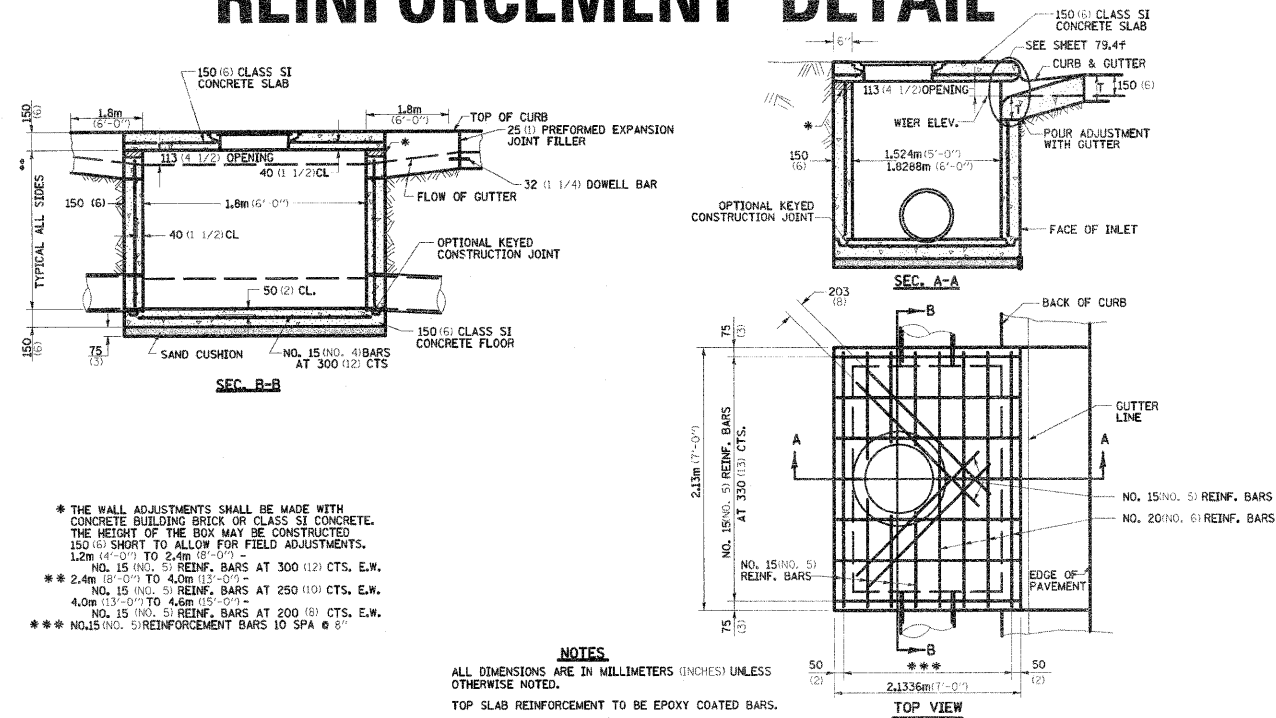

REVISED - 9-29-10

INLET SPECIAL NO. 7 & 8 REINFORCEMENT DETAIL 79.4h

TYPICAL MARKING FOR PAINTED ISLANDS

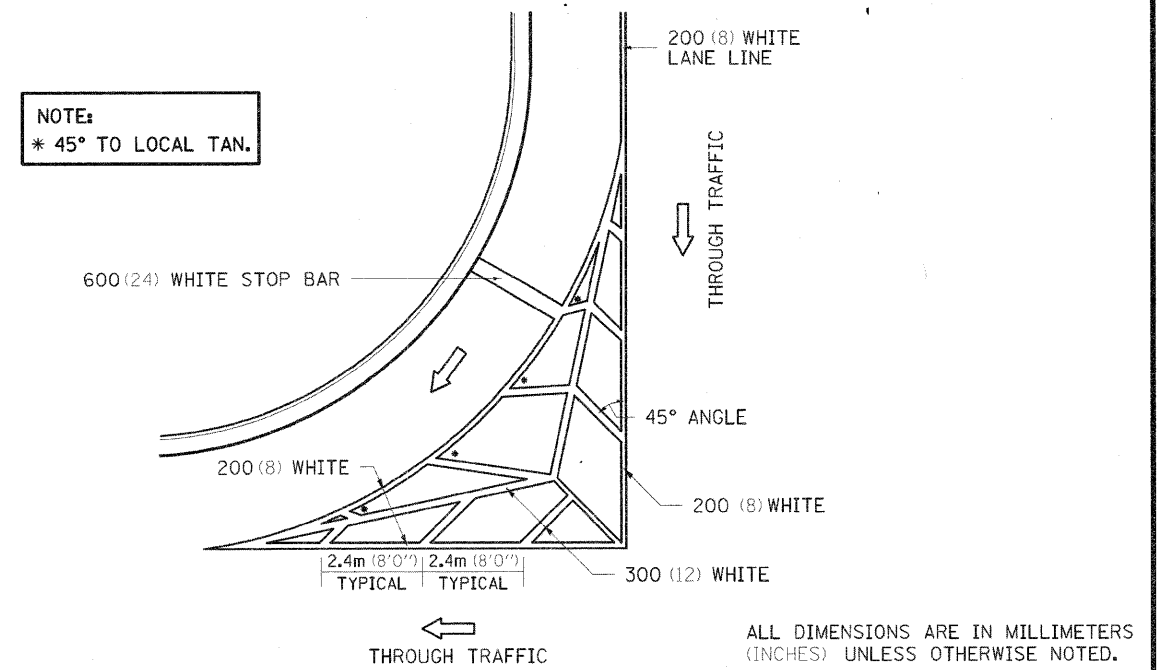

REVISED - 2-07-05

TYPICAL MARKING FOR PAINTED ISLANDS 93.4

TYPICAL MEDIAN CROSSOVER CLOSURE

GENERAL NOTES

WOOD POSTS, CABLE, AND SIGN SUPPORTS SHALL BE IN ACCORDANCE WITH SECTION 634 & 636 OF THE STANDARD SPECIFICATIONS FOR ROAD AND BRIDGE CONSTRUCTION. THE PANELS SHALL BE ANCHORED TO THE (3/8) CABLE IN SUCH A MANNER SO THEY CANNOT SLIDE ALONG THE CABLE.

THE REFLECTIVE SHEETING USED FOR THE PANELS SHALL MEET THE REQUIREMENTS OF SECTION 1091 OF THE STANDARD SPECIFICATIONS FOR ROAD & BRIDGE CONSTRUCTION AND SHALL BE ON BOTH SIDES.

ALL PANELS SHALL HAVE ALTERNATING REFLECTORIZED WHITE & RED STRIPES SLOPING DOWNWARD AT 45° TOWARD THE SIDE ON WHICH TRAFFIC WILL PASS AND ON BOTH SIDES OF PANEL, THE DRILLING OF 75 (3) HOLES SHALL BE INCLUDED TO THE MEDIAN CLOSURE.

THIS WORK SHALL BE PAID FOR AT THE CONTRACT UNIT PRICE EACH FOR MEDIAN CLOSURE.

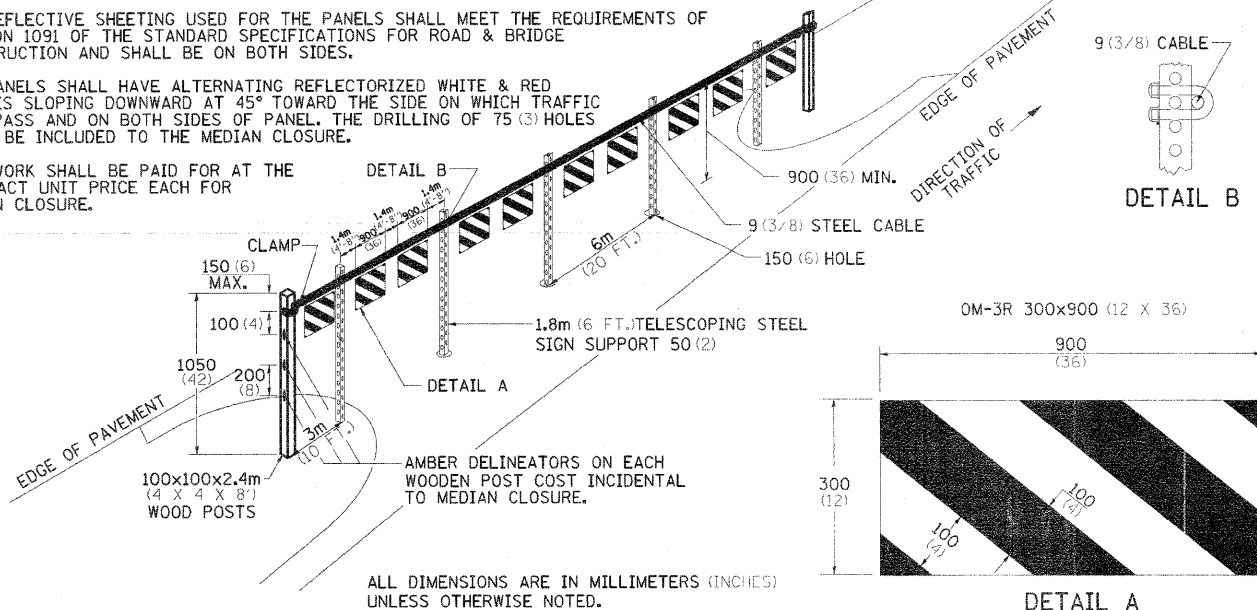

REVISED - 5-27-09

TYPICAL MEDIAN CROSSOVER CLOSURE 98.4

REVISED -	REGION 2 / DISTRICT 2 STANDARD	F.A. RTE.	SECTION	COUNTY	TOTAL SHEETS	SHEET NO.	
REVISED -		303	129K-1	WINNEBAGO	401	291	
REVISED -		SCALE: 100,000 / 1" = 100'				CONTRACT NO. 64987	
REVISED -		SHEET NO. OF SHEETS STA. TO STA.				FED. ROAD DIST. NO. 2 ILLINOIS FED. AID PROJECT	
REVISED -		PLOT DATE = 1/18/2011					