

DATE	
BY	
SPAWERD	
PLOTTED	
TEMPLATE	
NOTE BOOK	
AREAS CHECKED	

DATE	
BY	
ORIGINAL SURVEY	
SPAWERD	
PLOTTED	
TEMPLATE	
NOTE BOOK	
AREAS CHECKED	

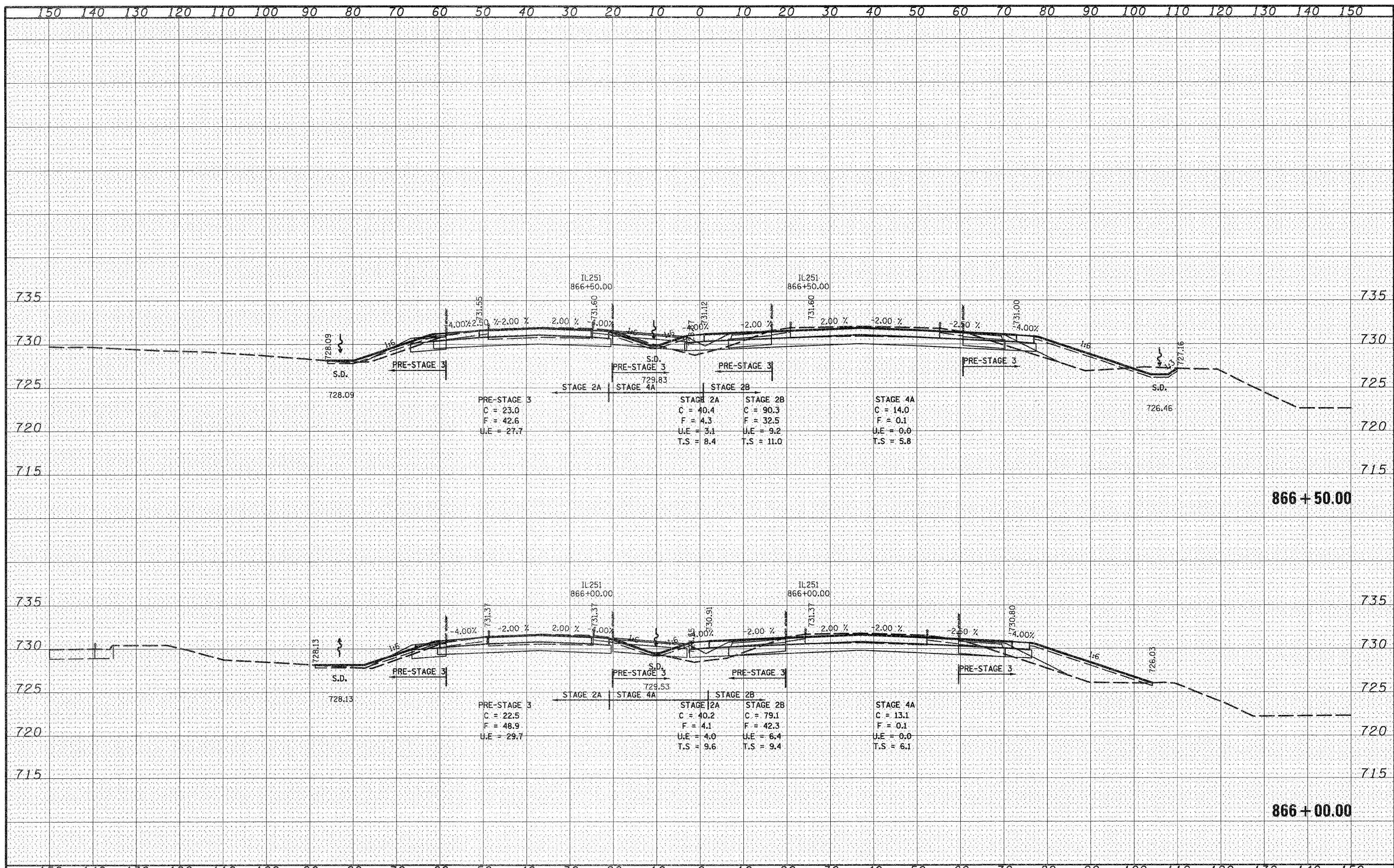

FILE NAME = 0264987-shr-xac-IL251-L.dgn	USER NAME = 320209071	DESIGNED - PDK	REVISED -	<b>STATE OF ILLINOIS DEPARTMENT OF TRANSPORTATION</b>	<b>ILLINOIS ROUTE 251 CROSS SECTIONS</b>			F.A. RTE. 303	SECTION 129K-1	COUNTY WINNEBAGO	TOTAL SHEETS 401	SHEET NO. 366	
PLOT SCALE = 20.0000' / IN.	CHECKED - PDK	REVISOR -	REVISOR -		SCALE:	SHEET NO.	OF SHEETS	STA. 866+00.00	TO STA. 866+50.00	FED. ROAD DIST. NO. 2 ILLINOIS FED. AID PROJECT			
PLOT DATE = 1/17/2011	DATE - 01/19/2011	REVISOR -	REVISOR -										
CONTRACT NO. 64987													