

DATE	
BY	
REVISIONS	
NO.	
DATE	
BY	
REVISIONS	
NO.	
DATE	
BY	
REVISIONS	
NO.	
DATE	
BY	
REVISIONS	
NO.	
DATE	
BY	
REVISIONS	
NO.	

DATE	
BY	
REVISIONS	
NO.	
DATE	
BY	
REVISIONS	
NO.	
DATE	
BY	
REVISIONS	
NO.	
DATE	
BY	
REVISIONS	
NO.	

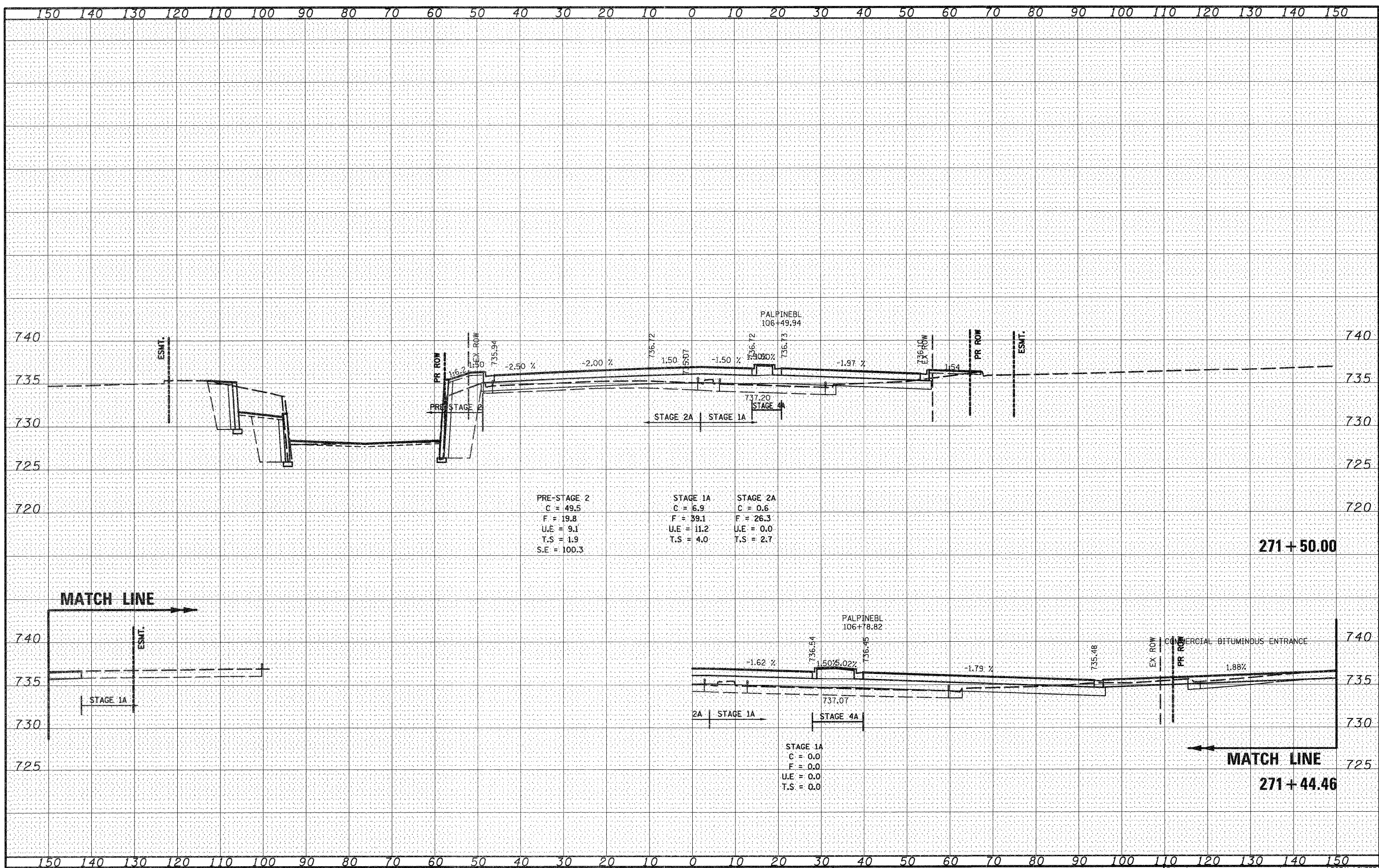

PRE-STAGE 2	STAGE 1A	STAGE 2A
C = 49.5	C = 6.9	C = 0.6
F = 19.8	F = 39.1	F = 26.3
U.E = 9.1	U.E = 11.2	U.E = 0.0
T.S = 1.9	T.S = 4.0	T.S = 2.7
S.E = 100.3		

STAGE 1A
C = 0.0
F = 0.0
U.E = 0.0
T.S = 0.0

FILE NAME = D264987.sht:xso-alpine.dgn

USER NAME = 3202090971  
 PLOT SCALE = 20,0000' / IN.  
 PLOT DATE = 1/17/2011

DESIGNED - PDK  
 DRAWN - GAP  
 CHECKED - PDK  
 DATE - 12/01/2010

REVISED -  
 REVISED -  
 REVISED -  
 REVISED -

**STATE OF ILLINOIS  
 DEPARTMENT OF TRANSPORTATION**

**ALPINE ROAD  
 CROSS SECTIONS**

SCALE: SHEET NO. OF SHEETS STA. 271+44.46 TO STA. 271+50.00

F.A. RTE.	SECTION	COUNTY	TOTAL SHEETS	SHEET NO.
303	129K-1	WINNEBAGO	401	395
CONTRACT NO. 64987				
FED. ROAD DIST. NO. 2 ILLINOIS FED. AID PROJECT				