

RESTORATION OF WORK AREA, RESTORATION OF THE TRAFFIC SIGNAL WORK AREA SHALL BE INCIDENTAL TO THE RELATED PAY ITEM SUCH AS FOUNDATION, CONDUIT, HANDHOLE, TRENCH AND BACKFILL, ETC. AND NO EXTRA COMPENSATION SHALL BE ALLOWED. ALL ROADWAY SURFACES SUCH AS SHOULDERS, MEDIAN, SIDEWALKS, PAVEMENT ETC. SHALL BE REPLACED IN KIND. ALL DAMAGE TO MOWED LAWNS SHALL BE REPLACED WITH AN APPROVED SOD, AND ALL DAMAGE TO UNMOWED FIELDS SHALL BE SEEDED IN ACCORDANCE WITH STANDARD SPECIFICATIONS 252 AND 250 RESPECTIVELY.

TWO ELECTRICAL SERVICE INSTALLATIONS, ONE EACH FOR LIGHTING AND FOR TRAFFIC SIGNALS, WILL BE REQUIRED. REFER TO SECTIONS 804 AND 805 OF THE STANDARD SPECIFICATIONS AND HIGHWAY STANDARDS 805001 AND 825021 FOR FURTHER DETAILS. MOUNT TRAFFIC SIGNAL SERVICE INSTALLATION ON LIGHTING POLE.

TYPE E FOUNDATION DEPTHS			
MAST ARM	STATION	OFFSET	DEPTH
SW MAST ARM	672+17.7	48.0 LT	15
NW MAST ARM	673+28.0	70.5 LT	15
NE MAST ARM	673+47.8	34.0 RT	14
SE MAST ARM	672+59.0	60.3 RT	14

LOCATIONS OF TRAFFIC SIGNAL POSTS AND MAST ARM ASSEMBLIES MAY BE CHANGED IN THE FIELD AS NECESSARY TO AVOID UTILITIES. THE NEW LOCATIONS SHALL BE COORDINATED WITH THE ENGINEER AND APPROVED BY THE DISTRICT TRAFFIC SIGNAL SECTION TO ENSURE THE NEW LOCATIONS MEET OPERATIONAL OFFSET/CLEAR ZONE REQUIREMENTS AND MAINTAIN PROPER POSITION OF SIGNAL HEADS IN RELATION TO THE TRAVELED LANES.

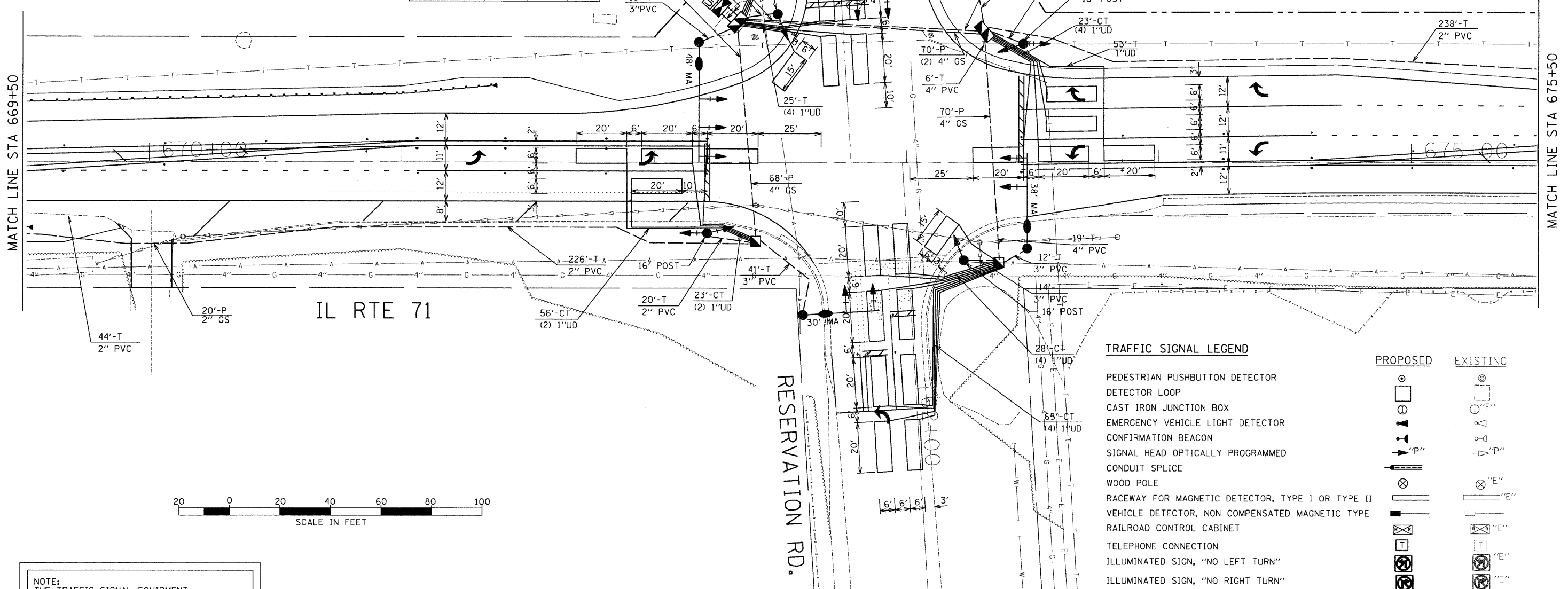

NOTE:  
THE TRAFFIC SIGNAL EQUIPMENT  
FOR THIS PROJECT SHALL BE "ECONOLITE"  
TO MATCH THE EXISTING ADJACENT SYSTEM

USER NAME = _USER_	DESIGNED - RS	REVISED -
	DRAWN - RS	REVISED -
PLOT SCALE = 20.0000' / IN.	CHECKED - RS	REVISED -
PLOT DATE = 3/31/2011	DATE - 03/31/2011	REVISED -

**STATE OF ILLINOIS**  
**DEPARTMENT OF TRANSPORTATION**

**FAP 311 (IL 71) AT VAN EMMON / RESERVATION ROADS  
TRAFFIC SIGNAL PLAN**

F.A.P. RTE.	SECTION	COUNTY	TOTAL SHEETS	SHEET NO.
311	(1-1)N TS	KENDALL	92	60
		CONTRACT NO. 66955		
ILLINOIS		FED. AID PROJECT		

Rev.