

DATE	
BY	
PLANNED	
DESIGNED	
DRAWN	
CHECKED	
REVISIONS	
NO.	

DATE	
BY	
PLANNED	
DESIGNED	
DRAWN	
CHECKED	
REVISIONS	
NO.	

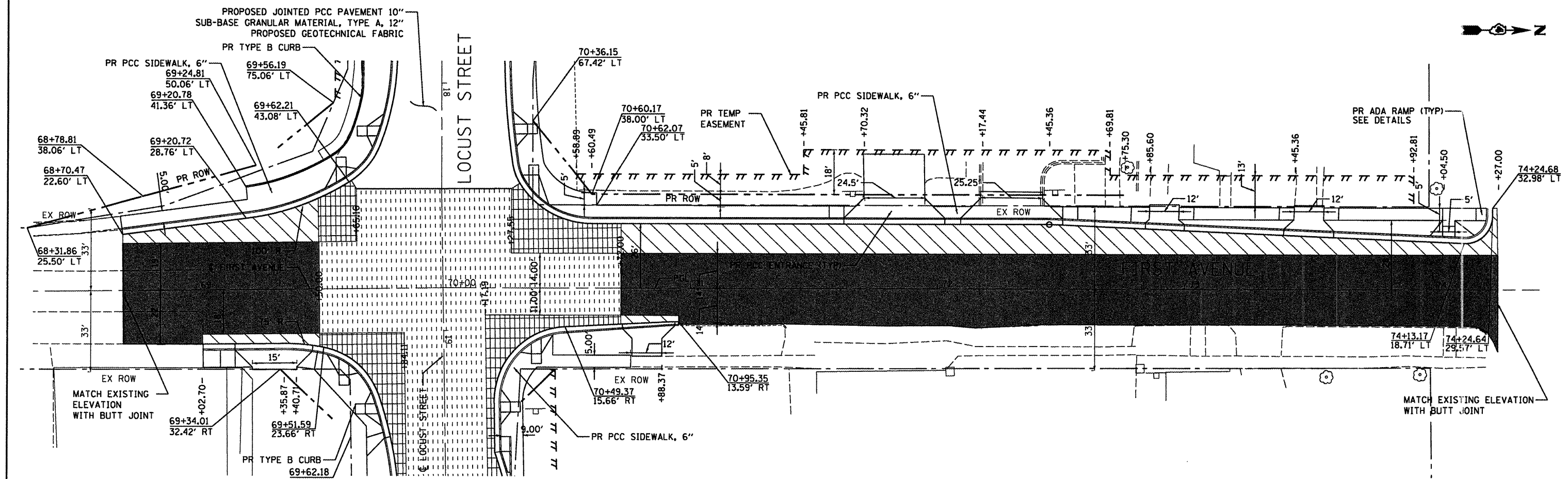

- LEGEND**
- HOT-MIX ASPHALT SURFACE REMOVAL, 3/4"
  - PROPOSED HOT-MIX ASPHALT SURFACE COURSE, MIX "D", N50, 1- 1/2"
  - PROPOSED POLYMERIZED HOT-MIX ASPHALT BINDER COURSE, IL-19.0, N50 1- 1/2"
  - PROPOSED PORTLAND CEMENT CONCRETE BASE COURSE 8"
  - PROPOSED STABILIZED SUB-BASE 4"
  - PROPOSED GEOTECHNICAL FABRIC FOR GROUND STABILIZATION
  - HOT-MIX ASPHALT SURFACE REMOVAL, 3/4"
  - PROPOSED HOT-MIX ASPHALT SURFACE COURSE, MIX "D", N50, 1- 1/2"
  - PROPOSED POLYMERIZED LEVELING BINDER (MACHINE METHOD), IL-4.75, N50 (VARIABLE DEPTH)

NOTE: ENTRANCE AND DRIVEWAY SIDEWALK CROSSINGS SHALL BE ADA COMPLIANT, SEE DETAILS

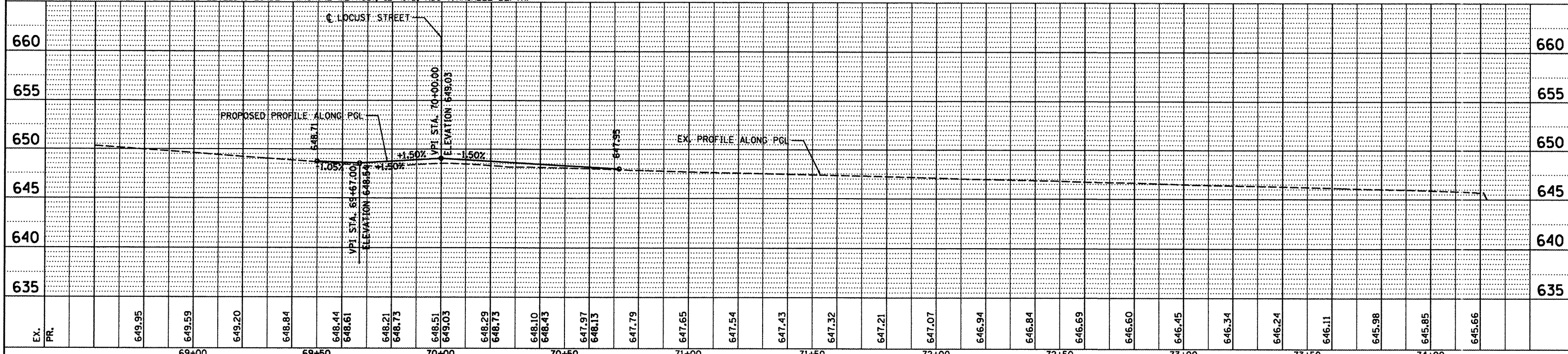
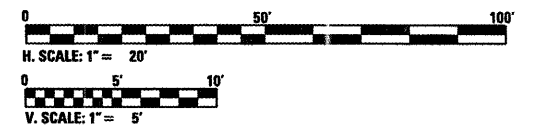

FILE NAME =	USER NAME =	DESIGNED RP	REVISED -	<p><b>INFRASTRUCTURE ENGINEERING</b> 456 Fulton Street   Suite 104   Peoria, IL 61602 P: 309.677.9000   F: 309.677.9210   www.infrastructure-eng.com</p>	<p align="center"><b>STATE OF ILLINOIS</b> <b>DEPARTMENT OF TRANSPORTATION</b></p>	<p align="center"><b>PLAN AND PROFILE</b> <b>FIRST AVENUE</b></p>		F.A.P. RTE.	SECTION	COUNTY	TOTAL SHEETS	SHEET NO.
P:\P-09\2193 - 1DDT DUR\Task-04\DWG\SH168_D4-9488909-plan06.dgn	DRWN SV	REVISED -	885/22			(41Z, 135) R, N; (ICS) I	FULTON	125	31			
PLOT SCALE = 1/20	CHECKED JRS	REVISED -	SCALE: H. 1" = 20' V. 1" = 5'			SHEET NO. 06 OF 07 SHEETS		STA. 68+70.47 TO STA. 74+24.68	CONTRACT NO. 68877			
PLOT DATE = 12/21/2010	DATE 12/21/2010	REVISED -	ILLINOIS FED. AID PROJECT 04-94-009-09									