

PROPOSED CABLE DIAGRAM

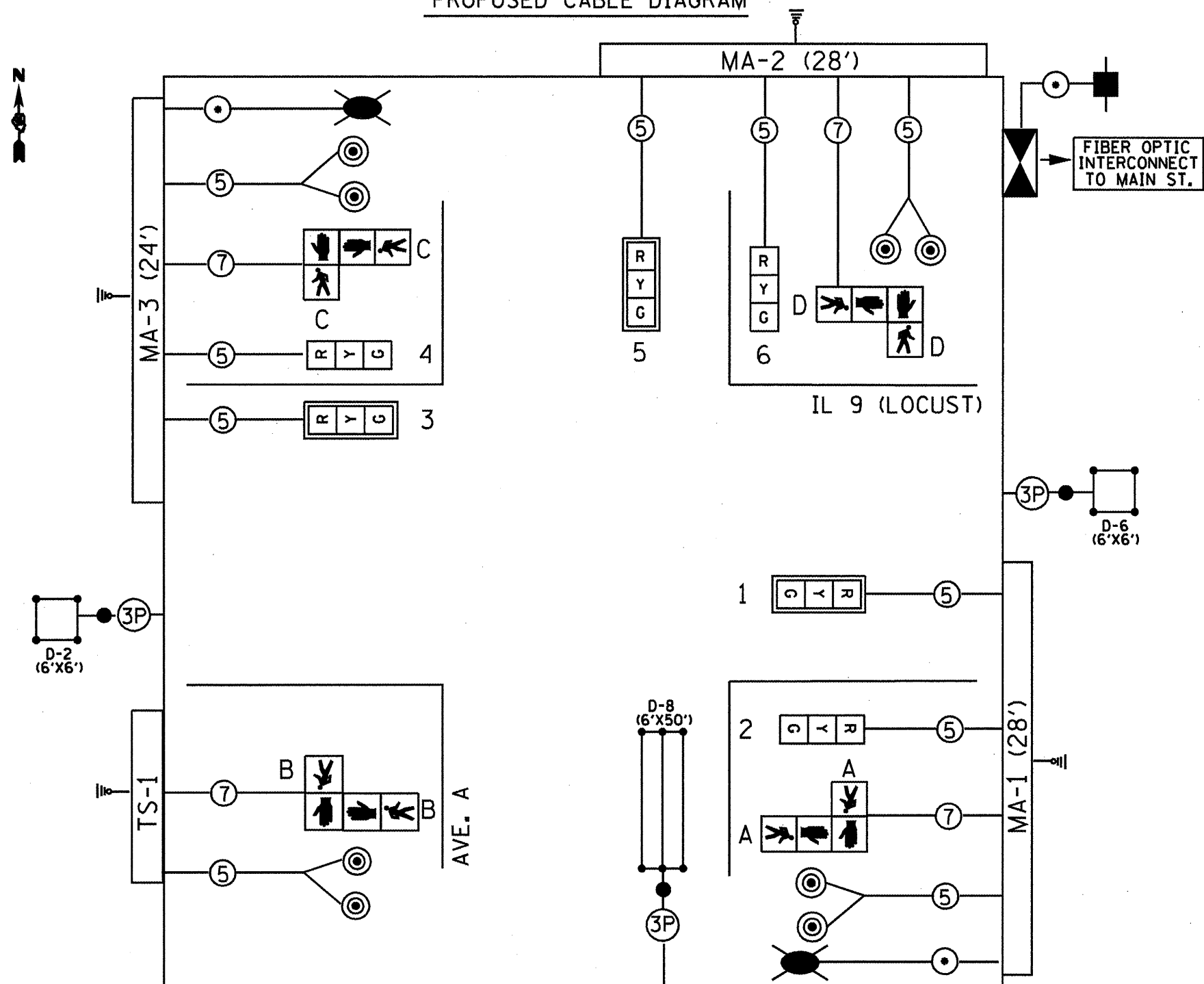

PROPOSED PHASE DIAGRAM

NAME OF INTERSECTION IL 9 (LOCUST) & AVE. A
 PROPOSED CONTROLLER: FULL ACTUATED CONTROLLER
ECONOLITE ASC/3-2100 (TS-2), TYPE IV CABINET
TS-2 BACKPANEL (16 POSITION)

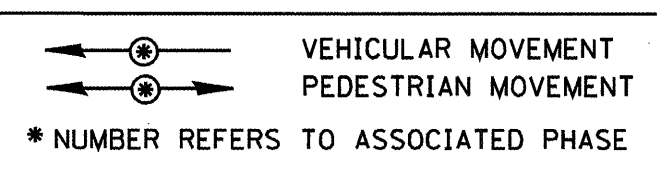
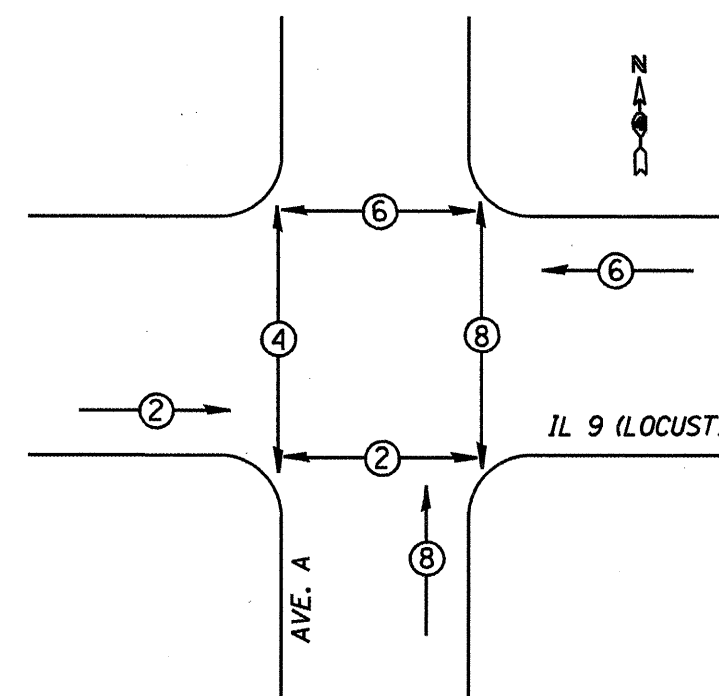

TRAFFIC SIGNALS LEGEND

- | | | | | | |
|--|--------------------------------------|--|------------------------------|--|-----------------------------------|
| | PROP. CONTROLLER (SIGNAL) | | *18 3-PR DETECTOR LOOP CABLE | | PROP. SERVICE INSTALLATION |
| | PROP. 3 SEC. SIGNAL HEAD W/BACKPLATE | | 5/C NO. 14 SIGNAL CABLE | | PROP. GROUND/SAFETY BOND |
| | PROP. 3 SEC. SIGNAL HEAD | | 7/C NO. 14 SIGNAL CABLE | | PROP. TYPE II SPLICE |
| | PROP. PEDESTRIAN HEAD | | *6 1/C X 3 (WITH GROUND) | | PROP. DETECTOR LOOP (6'X6') |
| | PROP. PEDESTRIAN PUSHBUTTON | | PROP. LUMINAIRE WITH PC | | PROP. DETECTOR LOOP (6'X50' QUAD) |

NOT TO SCALE
 TRAFFIC SIGNALS
 SHEET 5 OF 23

| | | | | | | | | | | | |
|-------------|---------------------|------------|-----------|---|--|---------------------|---------------|---------------------|---------------------------|--------------------|-----------|
| FILE NAME * | USER NAME * USER* | DESIGNED - | REVISED - | STATE OF ILLINOIS DEPARTMENT OF TRANSPORTATION | IL 9 (LOCUST ST.) & AVENUE A PROPOSED TRAFFIC SIGNAL CABLE PLAN AND PHASE DIAGRAM | | F.A.I.L. RTE. | SECTION | COUNTY | TOTAL SHEETS | SHEET NO. |
| *FILE# | | DRAWN - | REVISED - | | | | 685 (IL 9) | (4)Z.135R.AW(CS) | FULTON | 125 | 65 |
| | PLOT SCALE * SCALE* | CHECKED - | REVISED - | | SCALE: | SHEET NO. OF SHEETS | STA. TO STA. | FED. ROAD DIST. NO. | ILLINOIS FED. AID PROJECT | CONTRACT NO. 68877 | |
| | PLOT DATE * DATE* | DATE - | REVISED - | | | | | | | | |