

F.A. RTE.	SECTION	COUNTY	TOTAL SHEETS	SHEET NO.
VAR	D4 Bridge Washing 2011	TAZEWELL	8	1

INDEX OF SHEETS

- 1 Plan Sheet
- 2 Commitments & General Notes
- 3 Summary of Quantities
- 4 Location 1 S.N. 090-0001
- 5-7 Location 2 S.N. 090-0030
- 8 Attenuator Truck Detail

HIGHWAY STANDARDS

- 701001-02
- 701006-03
- 701101-02
- 701201-04
- 701406-06
- 701411-07
- 701606-07
- 701901-01
- 701421-03
- ADT

Location 1 59,000
 Location 2 10,100

STATE OF ILLINOIS
 DEPARTMENT OF TRANSPORTATION
 DIVISION OF HIGHWAYS

PROPOSED HIGHWAY PLANS

F.A.I. ROUTE 74 (I-74)
 F.A.P. ROUTE 669 (IL-8/29/116)

SECTION D4 BRIDGE WASHING 2011

PROJECT N/A

TAZEWELL COUNTY

C-94-062-11

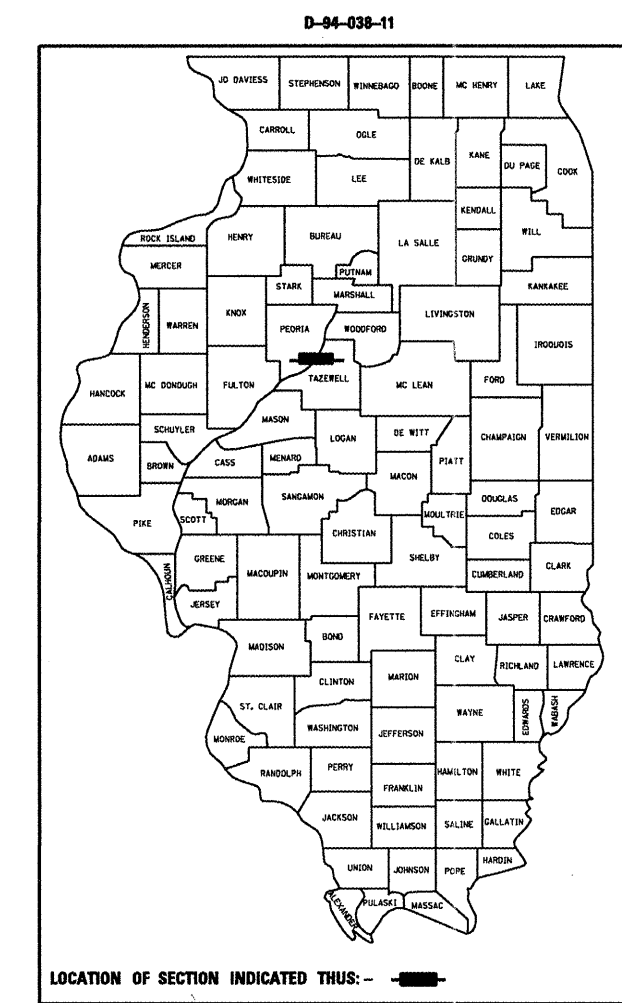

LOCATION OF SECTION INDICATED THUS: - [black bar] -

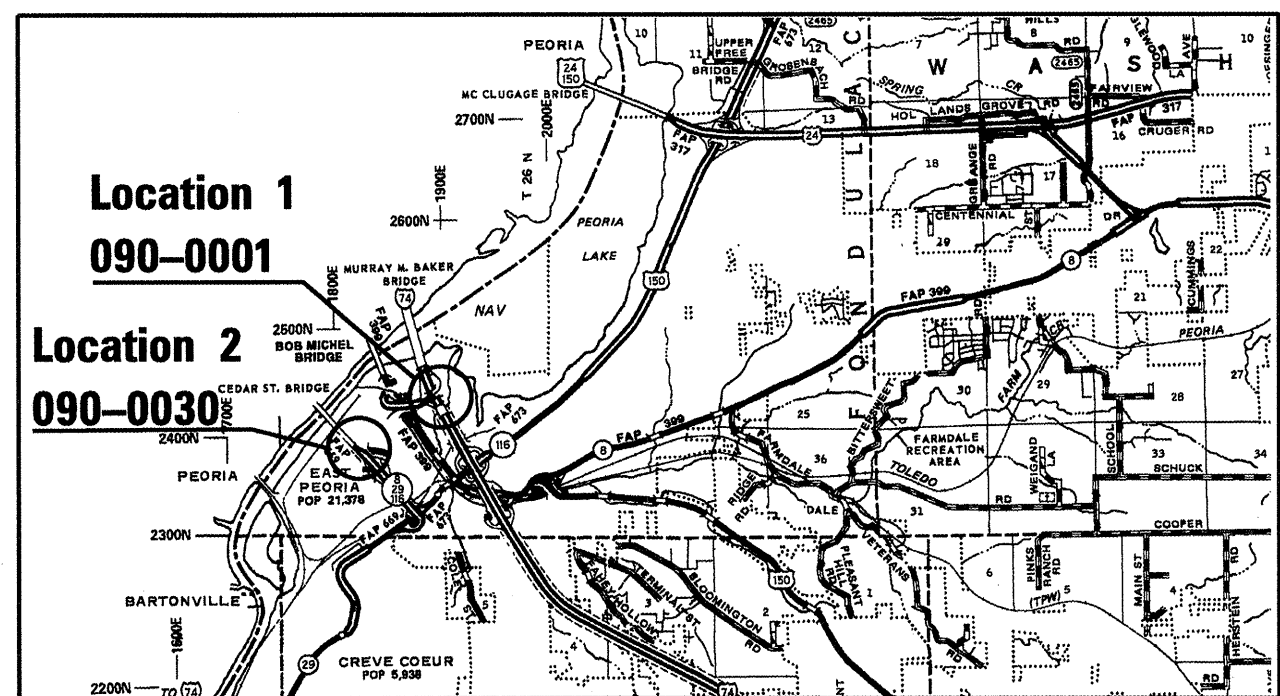

DESCRIPTION OF WORK
 This project consists of washing two structures over the Illinois River in District 4.

J.U.L.I.E.
 JOINT UTILITY LOCATION INFORMATION FOR EXCAVATION
 1-800-892-0123

STATE OF ILLINOIS
 DEPARTMENT OF TRANSPORTATION
 DIVISION OF HIGHWAYS

SUBMITTED MARCH 29, 2011

DEPUTY DIRECTOR OF HIGHWAYS, REGION ENGINEER
May 13, 2011
 Scott E. Stett, P.E. ICA
 acting ENGINEER OF DESIGN AND ENVIRONMENT

May 13, 2011
 Christine M. Reed ICA
 DIRECTOR OF HIGHWAYS, CHIEF ENGINEER

PRINTED BY THE AUTHORITY
 OF THE STATE OF ILLINOIS

Design Engineer Jim Miller (309) 671-3451 Designer Tom Inglis (309) 671-3481

COMMITMENTS

There are no commitments for this project.

GENERAL NOTES

All bridge washing shall be done in accordance with Section 592 of the Standard Specifications.

No additional compensation shall be allowed for the work in section 592.04. This work shall be included in the bridge washing pay item for each structure.

FILE NAME = S:\GEN\DRFT\STD&PLNS\ SQUAD\Josh KV Bridge Washing 68866.dgn	USER NAME = knowlesjd	DESIGNED - Josh Knowles	REVISED -	STATE OF ILLINOIS DEPARTMENT OF TRANSPORTATION	COMMITMENTS & GENERAL NOTES	F.A. RTE.	SECTION	COUNTY	TOTAL SHEETS	SHEET NO.
		DRAWN - Josh Knowles	REVISED -			Var.	D4 Bridge Washing 2009	Various	6	2
	PLOT SCALE = 1/32" = 1' / IN.	CHECKED -	REVISED -			CONTRACT NO. 68866				
PLOT DATE = 1/30/2009	DATE - 01/30/09	REVISED -		SCALE: _____ SHEET NO. 2 OF 9 SHEETS	STA. _____ TO STA. _____	ILLINOIS FED. AID PROJECT				

Summary of Quantities

Code Order

ROUTE		SECTION	COUNTY	SHEET	
VAR		D4 BRIDGE WASHING 2011	TAZEWELL	TOTAL	NO.
VAR				8	3
			CONTRACT NO.	68A44	

CONSTRUCTION TYPE CODE

TAZEWELL	TAZEWELL
0014	0014
100% STATE	100% STATE
FAI-74	FAP 669

CODE No.	ITEM	UNIT	Tot.QTY		
59200101	BRIDGE WASHING NO. 1	EACH	1	1	
59200102	BRIDGE WASHING NO. 2	EACH	1		1
67100100	MOBILIZATION	L SUM	1	0.5	0.5
70100420	TRAFFIC CONTROL AND PROTECTION, STANDARD 701411	EACH	2	1	1
70100700	TRAFFIC CONTROL AND PROTECTION, STANDARD 701406	L SUM	1	0.5	0.5
70100800	TRAFFIC CONTROL AND PROTECTION, STANDARD 701401	L SUM	1	0.5	0.5
70102625	TRAFFIC CONTROL AND PROTECTION, STANDARD 701606	L SUM	1	0.5	0.5
X7015005	CHANGEABLE MESSAGE SIGN	CAL DA	6	3	3

LOCATION 1

180' of truss removed in 2005

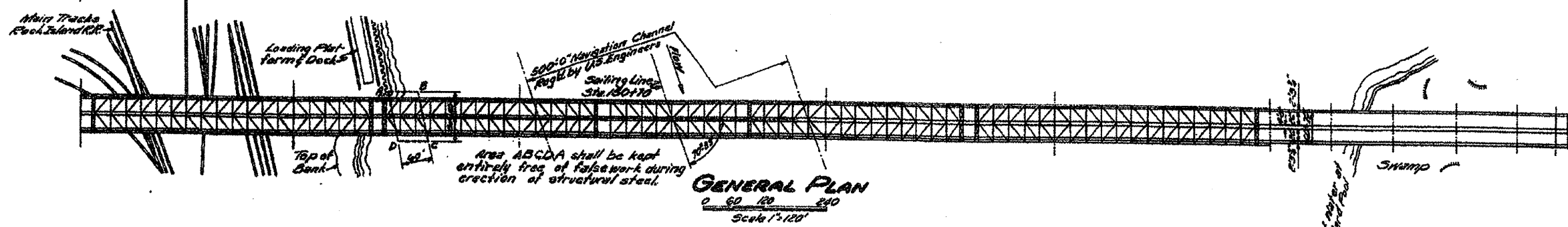
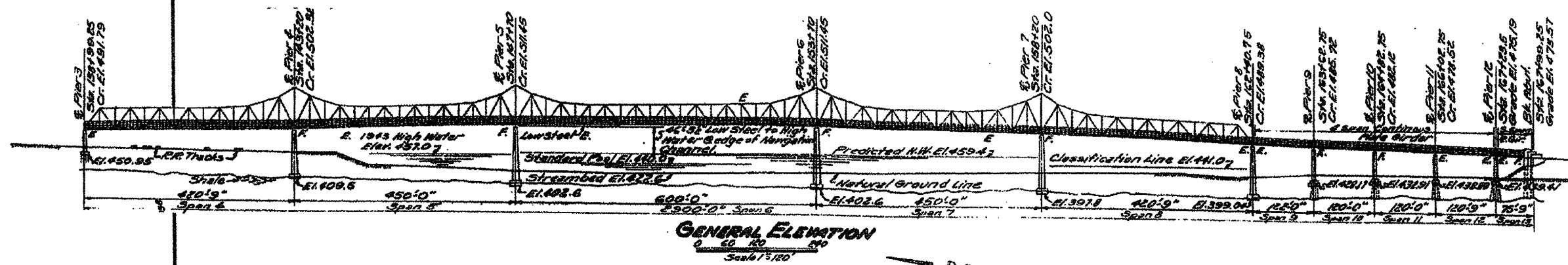

090 - 0001

FILE NAME = bridge washing 6-17-11.dgn	USER NAME = inglistj	DESIGNED -	REVISED -	STATE OF ILLINOIS DEPARTMENT OF TRANSPORTATION	SCALE: _____ SHEET NO. _____ OF _____ SHEETS STA. _____ TO STA. _____			F.A. -	SECTION	COUNTY	TOTAL SHEETS	SHEET NO.
	PLOT SCALE = 1.0006 1/16 IN.	DRAWN -	REVISED -		VAR	D4 BRIDGE WASHING 2011	TAZEWELL	8	4			
PLOT DATE = 3/30/2011	CHECKED -	DATE -	REVISED -	CONTRACT NO. 68A44			ILLINOIS FED. AID PROJECT					

LOCATION 2 090-0030 INFORMATION ONLY

Existing Structure: Structure No. 090-0030. Completed in 1932: Thirty four spans. 7 simple multibeam, 17 simple riveted two plate girder spans; 7 simple deck truss and 3 haunched cantilever truss units. Total length = 3700' back to back abuts. 49'-2" roadway.

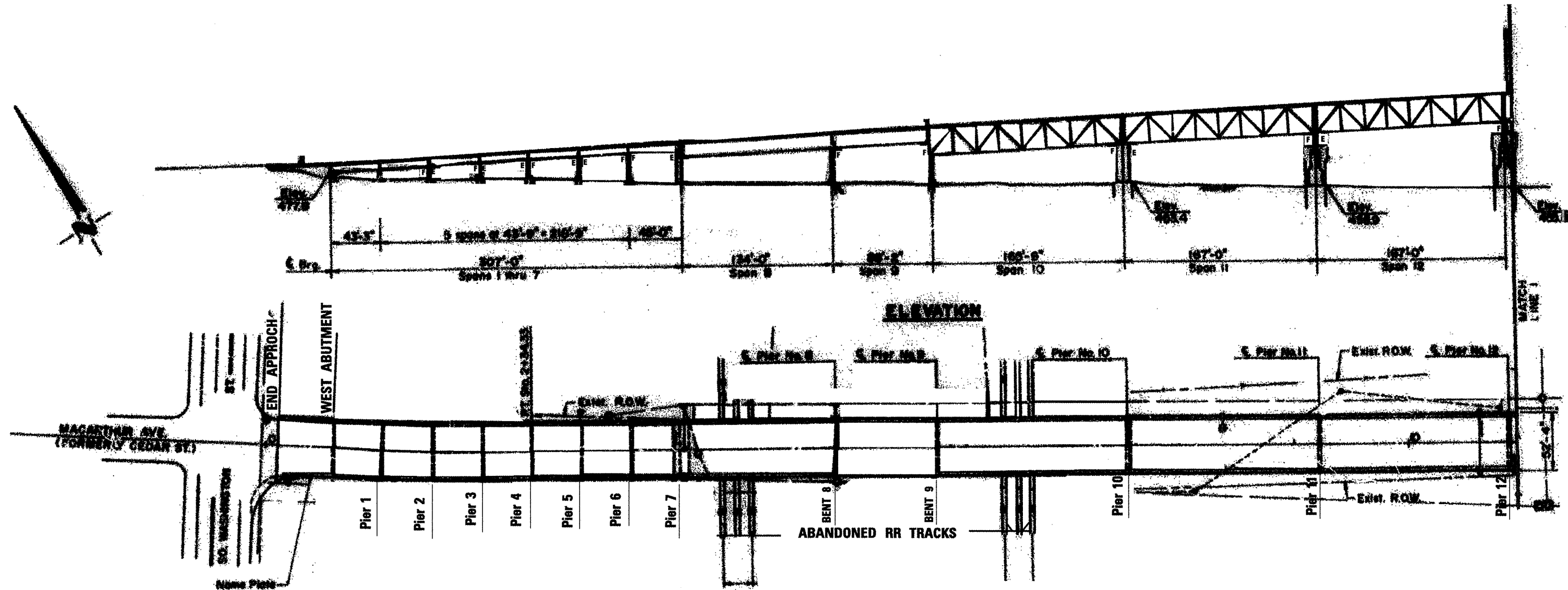

CEDAR STREET BRIDGE SPANS 1- 12

FILE NAME = bridge washing 6-17-11.dgn	USER NAME = ing1stj	DESIGNED -	REVISED -	STATE OF ILLINOIS DEPARTMENT OF TRANSPORTATION	SCALE: _____ SHEET NO. ____ OF ____ SHEETS STA. _____ TO STA. _____	F.A. RTE.:	SECTION	COUNTY	TOTAL SHEETS	SHEET NO.
	PLOT SCALE = 1/8" = 1' IN.	DRAWN -	REVISED -			VAR	D4 BRIDGE WASHING 2011	TAZEWELL	5	
	PLOT DATE = 3/16/2011	CHECKED -	REVISED -			CONTRACT NO. 68A44				
	DATE -	REVISED -		ILLINOIS FED. AID PROJECT						

LOCATION 2 090-0030 INFORMATION ONLY

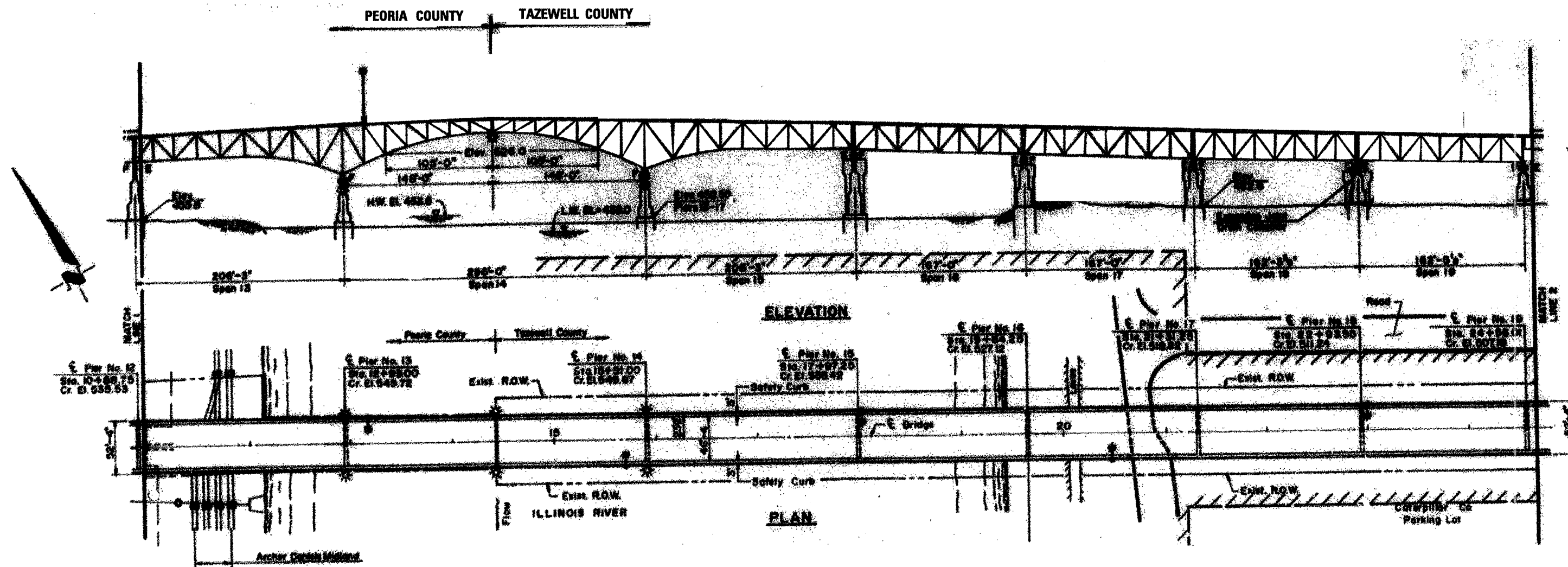

CEDAR STREET BRIDGE SPANS 13- 19

FILE NAME = bridge washing 6-17-11.dgn	USER NAME = inglistj	DESIGNED - ---	REVISED - ---	STATE OF ILLINOIS DEPARTMENT OF TRANSPORTATION	SCALE: _____	SHEET NO. _____ OF _____ SHEETS	STA. _____ TO STA. _____	F.A. RTE. VAR 04 BRIDGE WASHING 2011	SECTION TAEWELL	COUNTY TAEWELL	TOTAL SHEETS 10	SHEET NO. 10
PLOT SCALE = 1/8000 1" = 100'	CHECKED - ---	REVISED - ---	REVISED - ---		CONTRACT NO. 68A44		ILLINOIS FED. AID PROJECT					
PLOT DATE = 3/22/2011	DATE - ---	REVISED - ---	REVISED - ---									

LOCATION 2 090-0030 INFORMATION ONLY

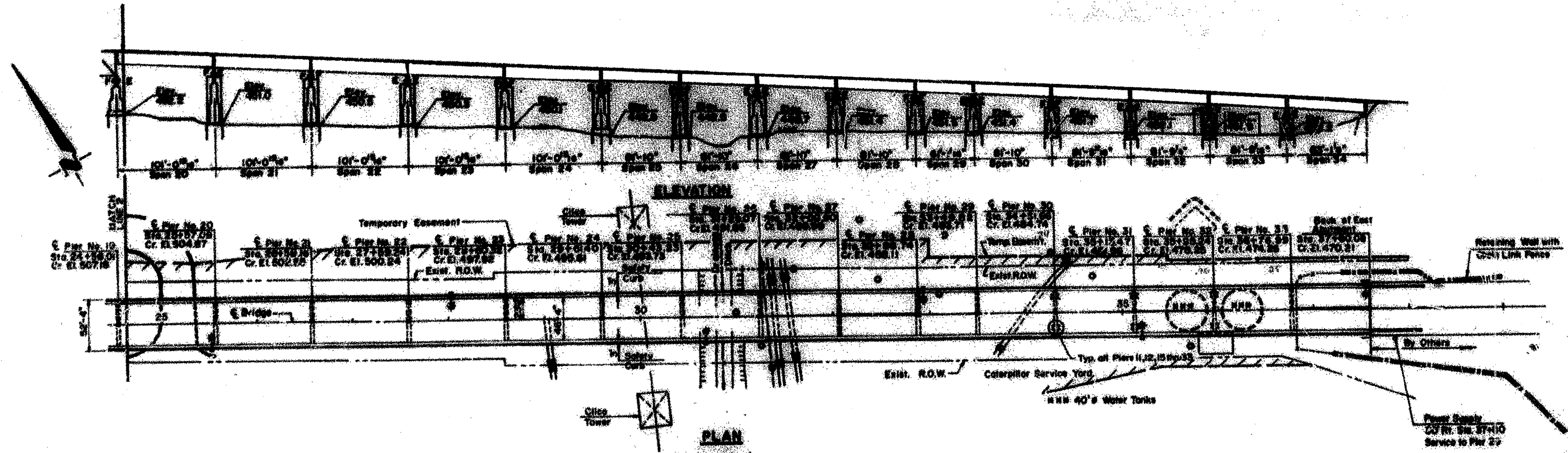

CEDAR STREET BRIDGE SPANS 20 - 34

FILE NAME = bridge washing 6-17-11.dgn	USER NAME = inglistj	DESIGNED - ----	REVISED - ----	STATE OF ILLINOIS DEPARTMENT OF TRANSPORTATION	-----	F.A. RTE. VAR	SECTION	COUNTY	TOTAL SHEETS	SHEET NO.	
		DRAWN - ----	REVISED - ----		-----		D4 BRIDGE WASHING 2011	TAZEWELL			
		PLOT SCALE = 1/8" = 1' IN.	CHECKED - ----		REVISED - ----	-----					
		PLOT DATE = 3/28/2011	DATE - ----		REVISED - ----	-----	SCALE: -----	SHEET NO. -- OF -- SHEETS	STA. ----- TO STA. -----	CONTRACT NO. 68A44	
ILLINOIS FED. AID PROJECT											

Additional Traffic Control Standard Notes

701201 Standard

701406/401 Standard

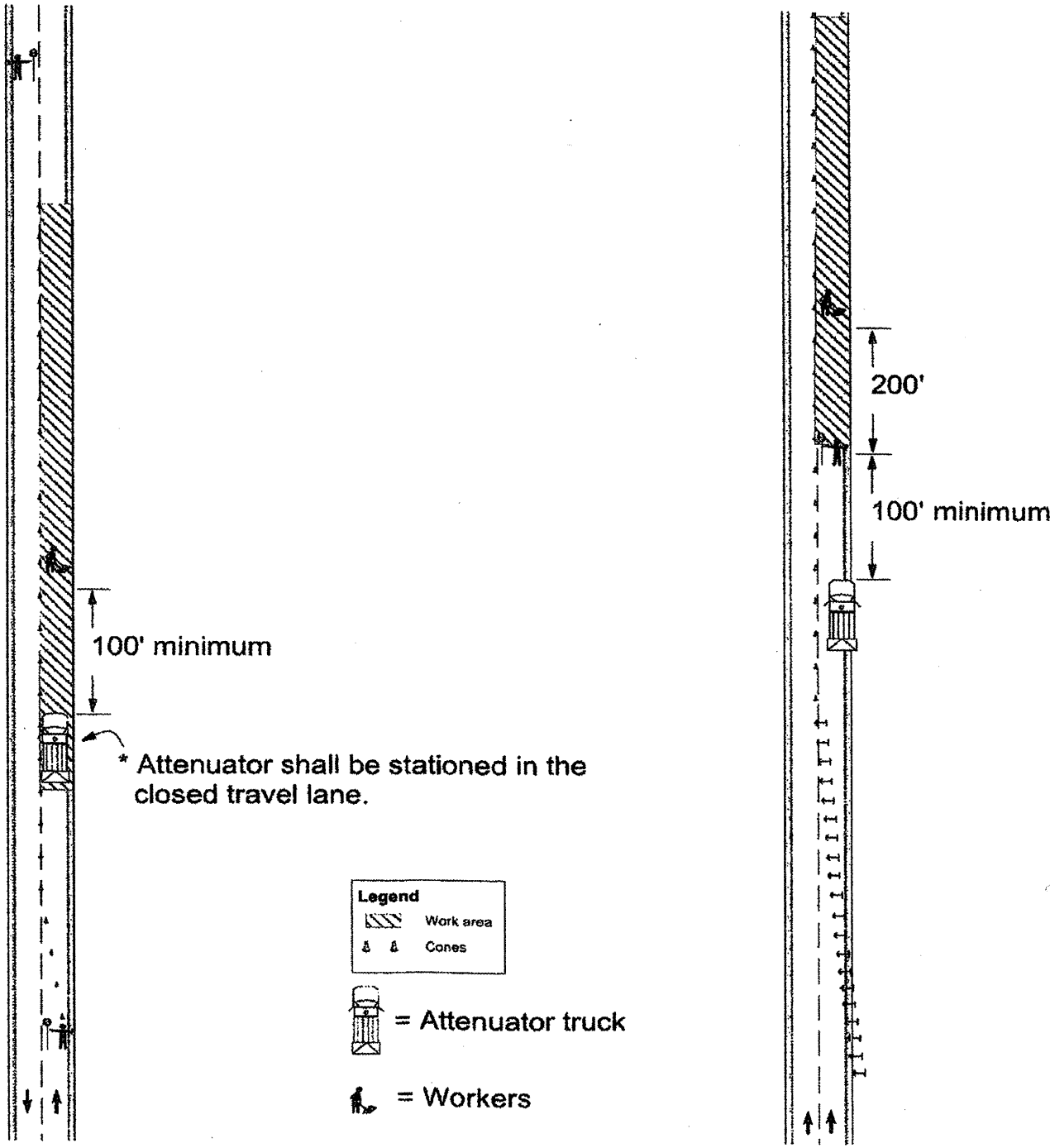

FILE NAME = bridge_washing_6-17-11.dgn	USER NAME = inglistj	DESIGNED - ---	REVISED - -----	STATE OF ILLINOIS DEPARTMENT OF TRANSPORTATION	-----	F.A. RTE.:	SECTION	COUNTY	TOTAL SHEETS	SHEET NO.
		DRAWN - ---	REVISED - -----		-----	VAR	D4 BRIDGE WASHING 2011	TAZEWELL	8	8
		PLOT SCALE = 0.9996" / IN.	REVISED - -----		-----	CONTRACT NO.68A44				
		PLOT DATE = 3/29/2011	REVISED - -----		-----	ILLINOIS FED. AID PROJECT				
SCALE: -----						SHEET NO. -- OF -- SHEETS STA. ----- TO STA. -----				