

PLAN	SURVEYED	BY	DATE
	PLOTTED		
	CHECKED		
	DATE		
	FILE NAME		

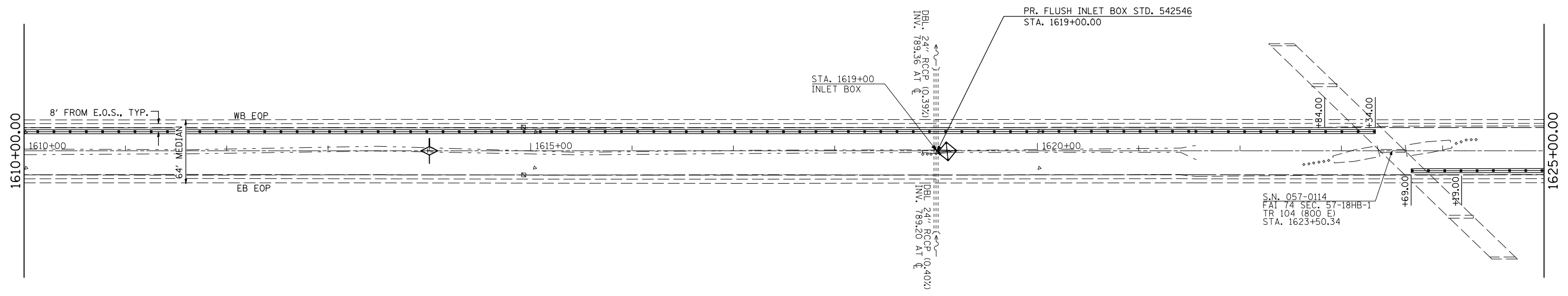

MEDIAN INLET BOX REMOVAL - 1 EACH
 PIPE CULVERT, CL A, TY1, 24" - 10 FOOT
 24" PIPE TEE WITH 24" RISER -1 EACH
 CONCRETE COLLAR - 1.8 CU YD

PROFILE	SURVEYED	BY	DATE
	PLOTTED		
	CHECKED		
	DATE		
	STRUCTURE		
	NOTATION		

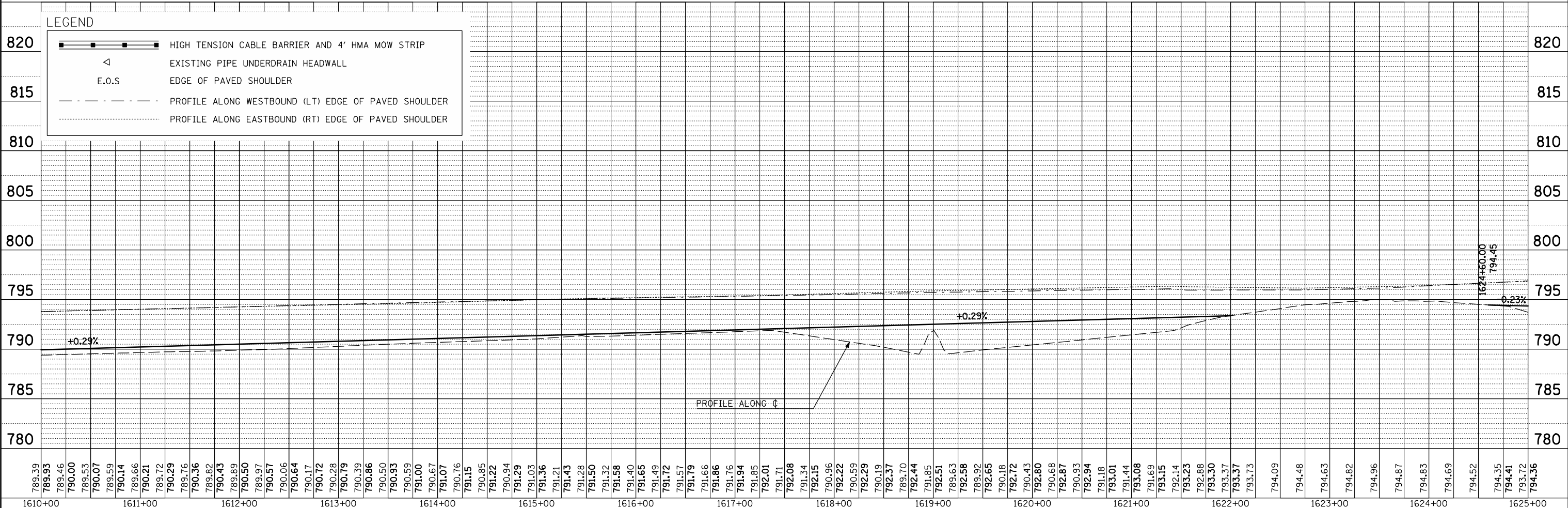

FILE NAME =	USER NAME = keyarb	DESIGNED -	REVISED -	STATE OF ILLINOIS DEPARTMENT OF TRANSPORTATION	PLAN AND PROFILE				F.A.I. RTE.	SECTION	COUNTY	TOTAL SHEETS	SHEET NO.	
ct:\pwork\pwork\keysarb\d0261049\0570927	shht-plnpr_f_50.dgn	DRAWN -	REVISED -		SCALE:	SHEET NO.	OF SHEETS	STA.	TO STA.	74	FY11 HSIP-5	MCLEAN	101	13
		CHECKED -	REVISED -						CONTRACT NO. 70927					
		DATE -	REVISED -						ILLINOIS FED. AID PROJECT					