

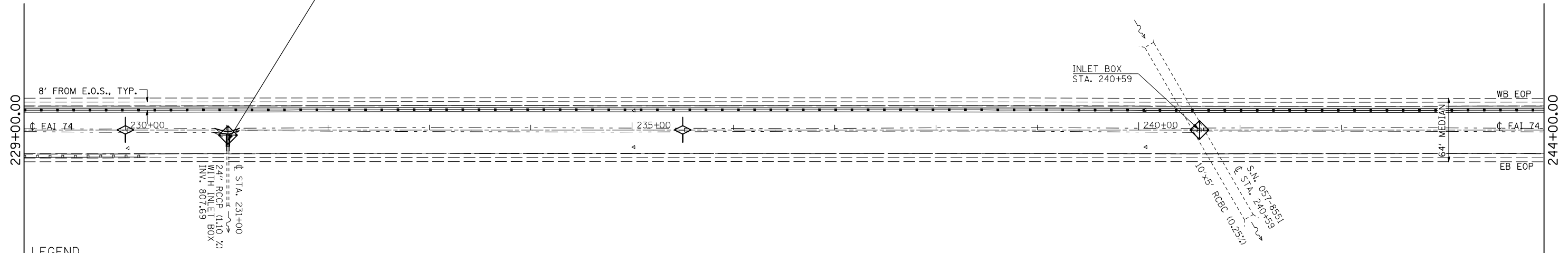

MEDIAN INLET BOX REMOVAL - 1 EACH
 PIPE CULVERT, CL A, TY1, 24" - 5 FOOT
 CONCRETE COLLAR - 0.45 CU YD

PROPOSED INLET BOX STD. 542511
 RT STA. 231+00.00
 MATCH EXISTING PIPE SLOPE
 SEE CROSS SECTION FOR DETAILS



LEGEND

- HIGH TENSION CABLE BARRIER AND 4' HMA MOW STRIP
- EXISTING PIPE UNDERDRAIN HEADWALL
- E.O.S. EDGE OF PAVED SHOULDER
- PROFILE ALONG WESTBOUND (LT) EDGE OF PAVED SHOULDER
- PROFILE ALONG EASTBOUND (RT) EDGE OF PAVED SHOULDER

PLAN	SURVEYED	BY	DATE
	PLOTTED		
	NOTE BOOK		
	NO.		

PROFILE	SURVEYED	BY	DATE
	PLOTTED		
	NOTE BOOK		
	NO.		

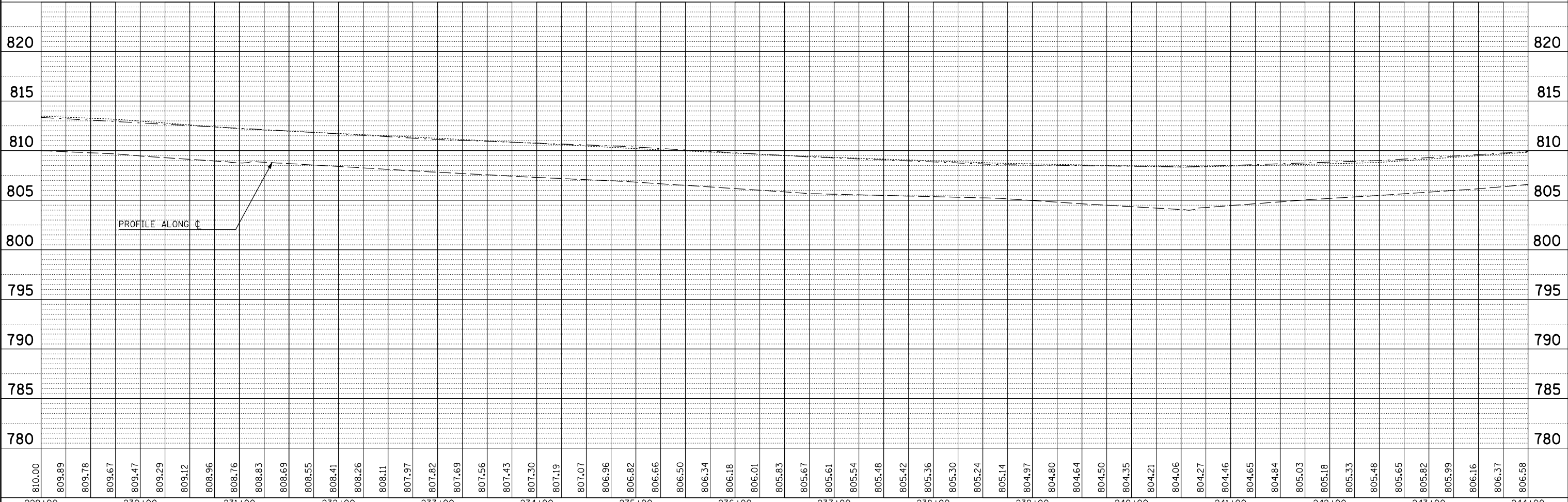

FILE NAME =	USER NAME = keyarb	DESIGNED -	REVISED -
ct:\pwork\pwidot\keyarb\d0261049\0570927	sh:plnpr_f_50.dgn	DRAWN -	REVISED -
	PLOT SCALE = 100.0000' / IN.	CHECKED -	REVISED -
	PLOT DATE = 3/25/2011	DATE -	REVISED -

STATE OF ILLINOIS
 DEPARTMENT OF TRANSPORTATION

PLAN AND PROFILE

SCALE: SHEET NO. OF SHEETS STA. TO STA.

F.A.I. RTE.	SECTION	COUNTY	TOTAL SHEETS	SHEET NO.
74	FY11 HSIP-5	MCLEAN	101	29
CONTRACT NO. 70927				
ILLINOIS FED. AID PROJECT				