

F.A.P. RTE.	SECTION	COUNTY	TOTAL SHEETS	SHEET NO.
310	69-3(3HB)	MORGAN	793	113
STA.		TO STA.		
FED. ROAD DIST. NO.		ILLINOIS	FED. AID PROJECT	

i:10:58 PM  
Mor-29-2011 01:10:58PM

**LEGEND**

- STAGE 4 CONSTRUCTION
- STAGE 4 PAVEMENT REMOVAL
- TYPE III BARRICADES WITH R11-2 (4830) "ROAD CLOSED"
- TYPE III BARRICADES WITH R11-4 (4830) "ROAD CLOSED TO THRU TRAFFIC"
- EXISTING VP-1L (1236) "VERTICAL PANELS"
- PROPOSED VP-1L (1236) "VERTICAL PANELS"
- DIRECTION OF TRAFFIC

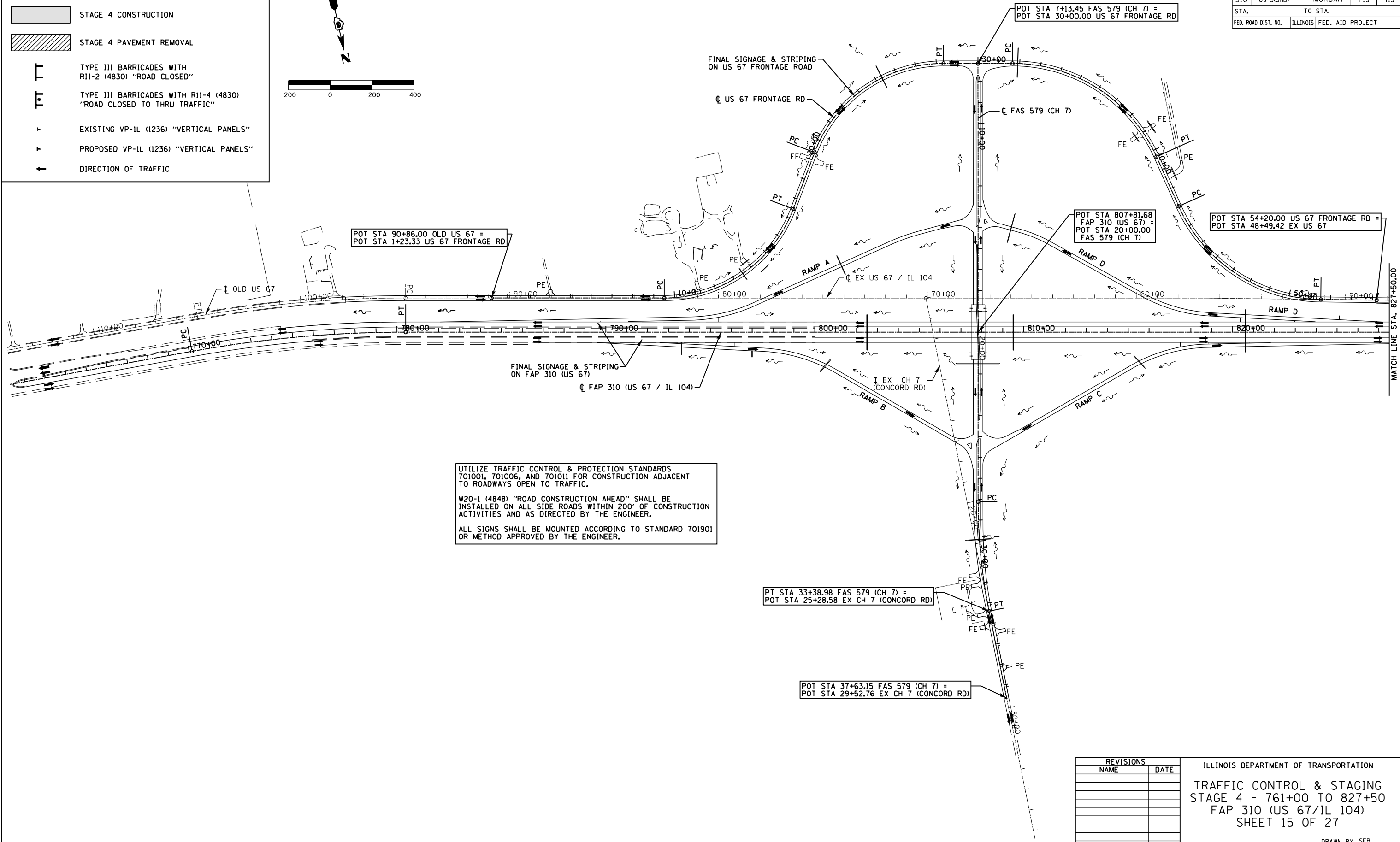
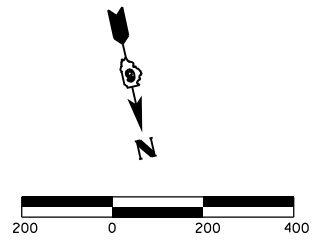

UTILIZE TRAFFIC CONTROL & PROTECTION STANDARDS 701001, 701006, AND 701011 FOR CONSTRUCTION ADJACENT TO ROADWAYS OPEN TO TRAFFIC.

W20-1 (4848) "ROAD CONSTRUCTION AHEAD" SHALL BE INSTALLED ON ALL SIDE ROADS WITHIN 200' OF CONSTRUCTION ACTIVITIES AND AS DIRECTED BY THE ENGINEER.

ALL SIGNS SHALL BE MOUNTED ACCORDING TO STANDARD 701901 OR METHOD APPROVED BY THE ENGINEER.

PT STA 33+38.98 FAS 579 (CH 7) =  
POT STA 25+28.58 EX CH 7 (CONCORD RD)

POT STA 37+63.15 FAS 579 (CH 7) =  
POT STA 29+52.76 EX CH 7 (CONCORD RD)

REVISIONS	
NAME	DATE

ILLINOIS DEPARTMENT OF TRANSPORTATION

**TRAFFIC CONTROL & STAGING**

**STAGE 4 - 761+00 TO 827+50**

**FAP 310 (US 67/IL 104)**

**SHEET 15 OF 27**

DATE 8/09

DRAWN BY SEB  
CHECKED BY

\$FILE\$