

F.A.P. RTE.	SECTION	COUNTY	TOTAL SHEETS	SHEET NO.
310	69-3(3HB)	MORGAN	793	156
STA.		TO STA.		
FED. ROAD DIST. NO.	ILLINOIS	FED. AID PROJECT		

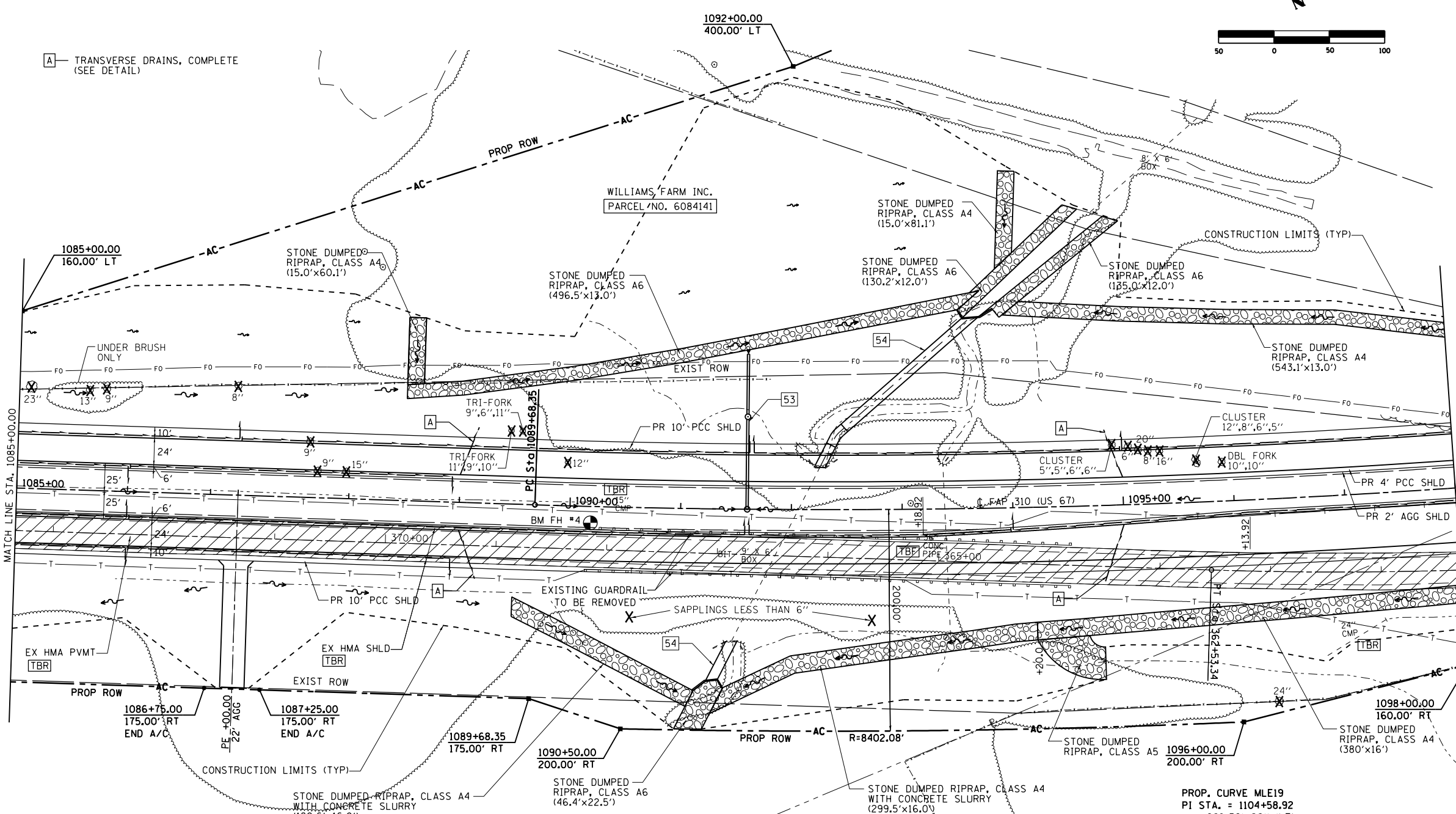
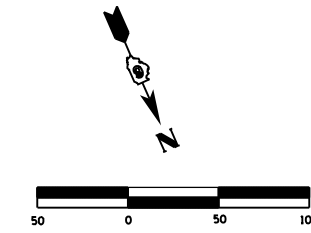

A — TRANSVERSE DRAINS, COMPLETE (SEE DETAIL)

MATCH LINE STA. 1085+00.00

MATCH LINE STA. 1098+00.00

SCOTT & STEPHANIE L. COGSWELL
PARCEL NO. 6084142

53 — STA. 1091+60.00 LT
PRECAST REINF CONC END SECTION 24" Ø, STD (542301)
PIPE CULVERT, CLASS A, TYPE 4, 24" Ø, 54'
USFL STA. 1091+60.0, 86.0' LT, EL 563.28
DSFL STA. 1091+60.0, 140.0' LT, EL 561.93
MANHOLE TYPE A, 5' Ø W FRAME AND LID, CLOSED, TYPE 1 W FLAT SLAB TOP
STA. 1091+60.0, 83.5' LT, INV EL 563.28, TL EL 582.31
PIPE CULVERT, CLASS A, TYPE 2, 24" Ø, 80'
MANHOLE TYPE A, 5' Ø W MEDIAN INLET STD (604106) FLAT SLAB TOP
STA. 1091+60.0, 0.0' RT, INV EL 580.74, TG EL 584.23
USFL STA. 1091+60.0, 2.5' LT, EL 580.74
DSFL STA. 1091+60.0, 81.0' LT, EL 578.78
TRENCH BACKFILL = 10.2 CU YD

54 — STA. 1092+06.00 SKEW 27° LT AH
CAST-IN-PLACE HEADWALLS (SEE SHEET 348)
CAST-IN-PLACE BOX CULVERT 9'x6' EXTENSION, 37'-2"
(SEE SHEET 349 FOR DETAILS)
USFL STA. 1091+30.7, 155.2' RT, EL 553.71
DSFL STA. 1091+47.1, 119.2' RT, EL 553.50
CAST-IN-PLACE BOX CULVERT 9'x6' EXTENSION, 193'-8"
(SEE SHEET 349 FOR DETAILS)
USFL STA. 1092+25.2, 37.5' LT, EL 552.47
DSFL STA. 1093+61.2, 170.0' LT, EL 551.47
CAST-IN-PLACE HEADWALLS (SEE SHEET 349)
D.A.=402.5 ACRES 050=645 CFS 0100=751 CFS

PROP. CURVE MLE19
PI STA. = 1104+58.92
Δ = 20° 36' 00" (LT)
D = 0° 41' 55"
R = 8,202.08'
T = 1,490.57'
L = 2,948.96'
E = 134.34'
e = 0.025
P.C. STA. = 1089+68.35
P.T. STA. = 1119+17.31
S/E TRANSITION
STA 1088+44.00 TO STA 1090+06.00
STA 1118+80.00 TO STA 1120+42.00

PAUL J WERRIES
PARCEL NO. 6084143

EXIST. CURVE 84
PI STA. = 355+35.94
Δ = 24° 16' 39" (RT)
D = 1° 39' 59"
R = 3,438.56'
T = 739.60'
L = 1,457.00'
E = 78.64'
P.C. STA. = 347+96.34
P.T. STA. = 362+53.34

BM FH #4
STA 1090+19 @ 15' RT
NOTCH IN TOP OF LAST E
GUARD RAIL POST
EL = 590.601

1:15:22 PM

Mon-29-2011 01:15:22PM

\$ FILE \$