

F.A.P. RTE.	SECTION	COUNTY	TOTAL SHEETS	SHEET NO.
310	69-3(3HB)	MORGAN	793	188
STA.		TO STA.		
FED. ROAD DIST. NO.		ILLINOIS FED. AID PROJECT		

1:18:38 PM

PLAN	DATE
SURVEYED	
PLOTTED	
CHECKED	
BY	
NO. OF WAY CHECKED	
CADD FILE NAME	

PROFILE	DATE
SURVEYED	
PLOTTED	
CHECKED	
BY	
NO. OF WAY CHECKED	
STRUCTURE NOTATIONS CHKD	

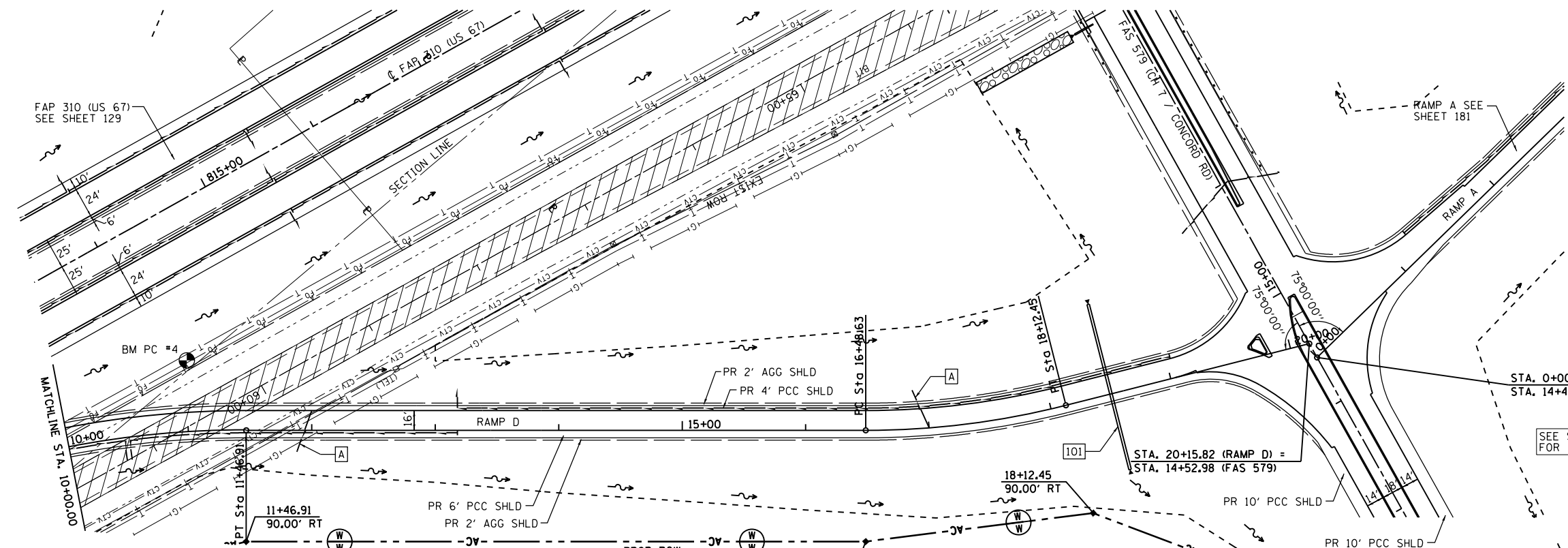

PROP. CURVE COND-1
 PI STA. = 9+76.57
 $\Delta = 26^\circ 08' 47''$ (RT)
 $D = 7^\circ 32' 20''$
 $R = 760.00'$
 $T = 176.48'$
 $L = 346.82'$
 $E = 20.22'$
 $e = 0.080$
 P.C. STA. = 8+00.09
 P.T. STA. = 11+46.91
 S.E. TRANSITION
 STA 6+60.11 TO STA 8+70.11
 STA 10+62.00 TO STA 13+66.00

PROP. CURVE COND-2
 PI STA. = 17+30.96
 $\Delta = 14^\circ 13' 15''$ (LT)
 $D = 8^\circ 40' 52''$
 $R = 660.00'$
 $T = 82.33'$
 $L = 163.81'$
 $E = 5.12'$
 $e = 0.058$
 P.C. STA. = 16+48.63
 P.T. STA. = 18+12.45
 S.E. TRANSITION
 STA 15+69.00 TO STA 16+88.00
 STA 17+73.00 TO STA 18+92.00

[A] TRANSVERSE DRAINS, COMPLETE (SEE DETAIL)

[101] STA. 18+50.00
 PRECAST REINF CONC END SECTION 24"Ø, STD (542301)
 PIPE CULVERT, CLASS A, TYPE 4, 24"Ø, 138'
 PRECAST REINF CONC END SECTION 24"Ø, STD (542301)
 USFL STA. 18+50.0, 74.8' LT, EL 613.20
 DSFL STA. 18+50.0, 63.2' RT, EL 612.38
 TRENCH BACKFILL = 7.3 CU YD

ROBERTA A. WERRIES
 PARCEL NO. 6084106

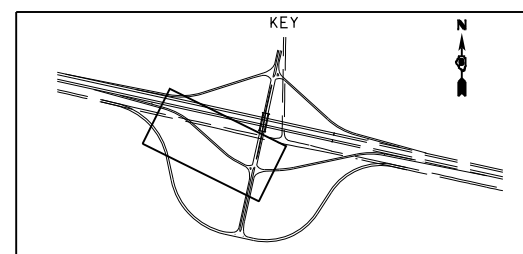

SEC 12, T 15 N, R 12 W, 3rd PM

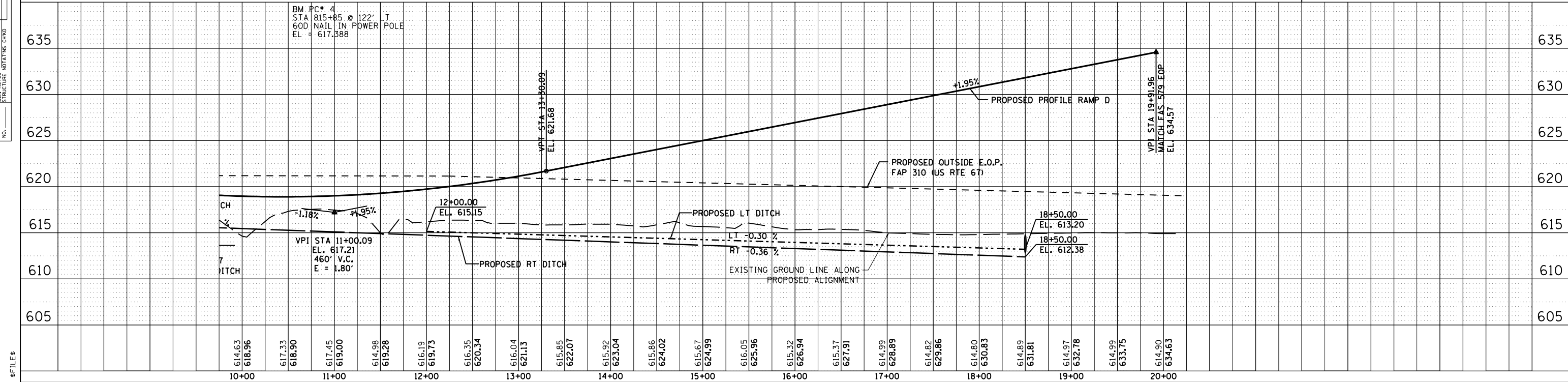

\$FILE\$