

F.A.P. RTE.	SECTION	COUNTY	TOTAL SHEETS	SHEET NO.
310	69-3(3HB)	MORGAN	793	218
STA.		TO STA.		
FED. ROAD DIST. NO.		ILLINOIS FED. AID PROJECT		

8:46:16 AM Mar-30-2011 08:46:16AM \$FILE\$

POT STA 21+81.41 GILLILAND ROAD EXTENSION =
POT STA 13+17.93 GILLILAND ROAD CONNECTOR

PROP. CURVE V4
PI STA. = 23+90.22
 $\Delta = 33^\circ 15' 08''$ (RT)
D = 38' 11" 50"
R = 150.00'
T = 44.79'
L = 87.05'
E = 6.54'
e = N.C.
P.C. STA. = 23+45.43
P.T. STA. = 24+32.48

PROP. CURVE V9
PI STA. = 10+44.48
 $\Delta = 23^\circ 02' 08''$ (RT)
D = 57' 17" 45"
R = 100.00'
T = 20.38'
L = 40.20'
E = 2.06'
e = N.C.
P.C. STA. = 10+24.11
P.T. STA. = 10+64.31

PROP. CURVE V5
PI STA. = 26+91.60
 $\Delta = 69^\circ 22' 16''$ (RT)
D = 38' 11" 50"
R = 150.00'
T = 103.81'
L = 181.61'
E = 32.42'
e = N.C.
P.C. STA. = 25+87.79
P.T. STA. = 27+69.40

PROP. CURVE C61
PI STA. = 76+30.32
 $\Delta = 18^\circ 02' 28''$ (RT)
D = 10' 08" 27"
R = 565.00'
T = 89.70'
L = 177.91'
E = 7.08'
e = 0.040
P.C. STA. = 75+40.63
P.T. STA. = 77+18.53
S.E. TRANSITION
STA 74+43.00 TO STA 75+68.00
STA 76+91.00 TO STA 78+16.00

PROP. CURVE V8
PI STA. = 1+81.89
 $\Delta = 52^\circ 08' 56''$ (RT)
D = 27' 56" 57"
R = 205.00'
T = 100.32'
L = 186.58'
E = 23.23'
e = N.C.
P.C. STA. = 0+81.57
P.T. STA. = 2+68.16

PROP. CURVE V1
PI STA. = 6+16.92
 $\Delta = 29^\circ 01' 14''$ (RT)
D = 15' 08" 48"
R = 378.27'
T = 97.90'
L = 191.60'
E = 12.46'
e = N.C.
P.C. STA. = 5+19.02
P.T. STA. = 7+10.62

PROP. CURVE CYLHD1
PI STA. = 98+07.65
 $\Delta = 48^\circ 40' 34''$ (RT)
D = 8' 36" 57"
R = 665.00'
T = 300.79'
L = 564.96'
E = 64.86'
e = 0.060
P.C. STA. = 95+06.86
P.T. STA. = 100+71.82
S.E. TRANSITION
STA 93+83.00 TO STA 95+47.00
STA 100+30.00 TO STA 101+94.00

PROP. CURVE CYLHD2
PI STA. = 106+01.61
 $\Delta = 45^\circ 00' 00''$ (LT)
D = 8' 36" 57"
R = 665.00'
T = 275.45'
L = 522.29'
E = 54.79'
e = 0.060
P.C. STA. = 103+26.16
P.T. STA. = 108+48.45
S.E. TRANSITION
STA 102+03.00 TO STA 103+67.00
STA 107+85.00 TO STA 109+28.00

SEE SHEET 219 FOR STATIONS AND ELEVATIONS TABLES

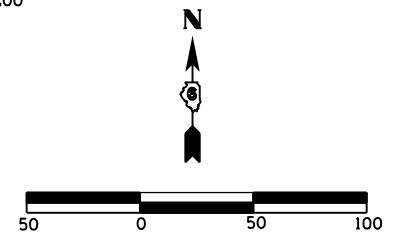
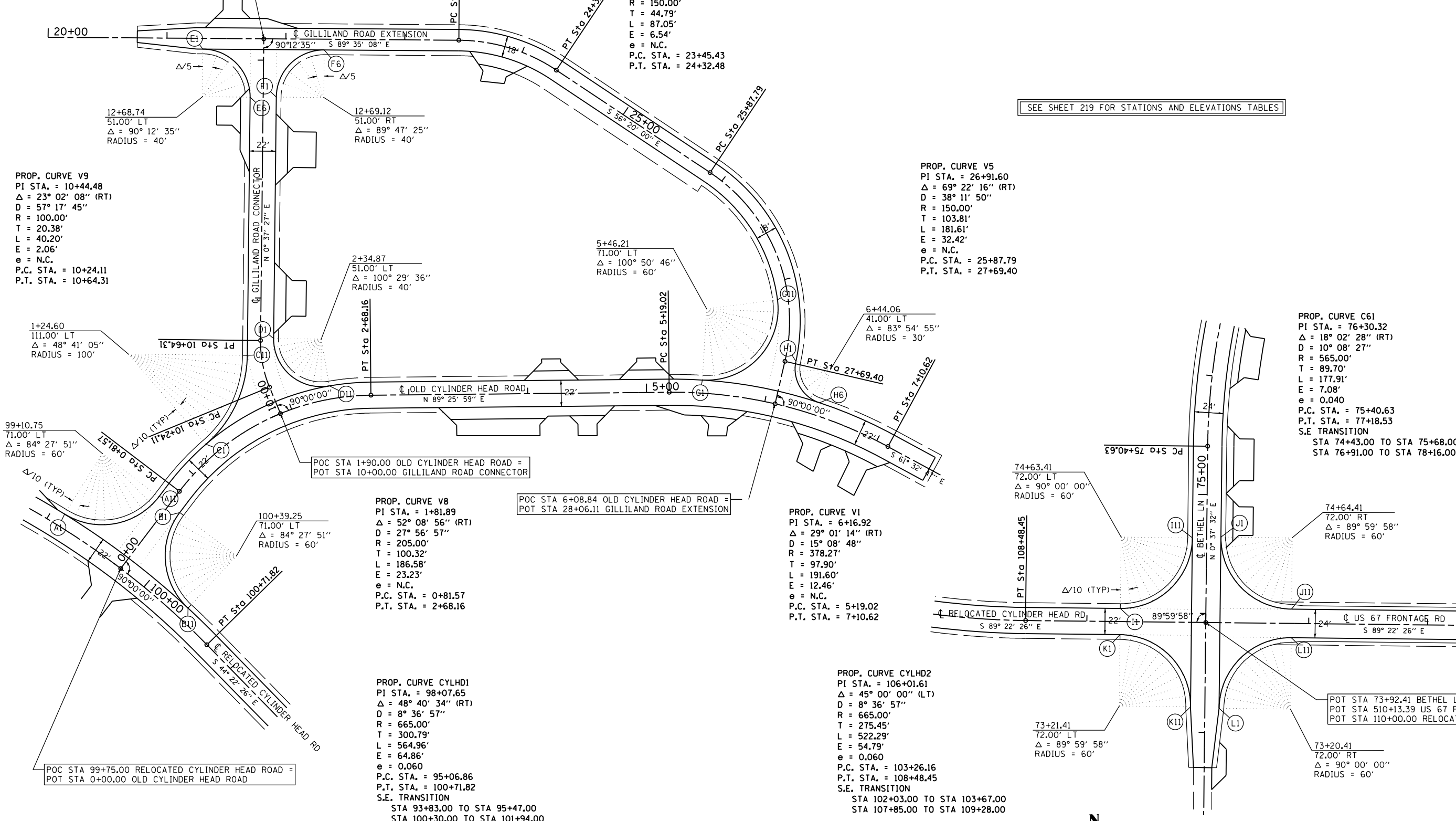

REVISIONS	
NAME	DATE

ILLINOIS DEPARTMENT OF TRANSPORTATION
GEOMETRIC DETAILS
 INTERSECTIONS IN BETHEL
 FAP 310 (US 67/IL 104)
 SHEET 13 OF 23
 DATE 6/06
 DRAWN BY EBB
 CHECKED BY