

May-19-2011 09:28:21AM

\$FILE\$

CONTRACT NO. 72667

F.A.P. RTE.	SECTION	COUNTY	TOTAL SHEETS	SHEET NO.
310	69-3(3HB)	MORGAN	793	310
STA. TO STA.		FED. ROAD DIST. NO. ILLINOIS FED. AID PROJECT		

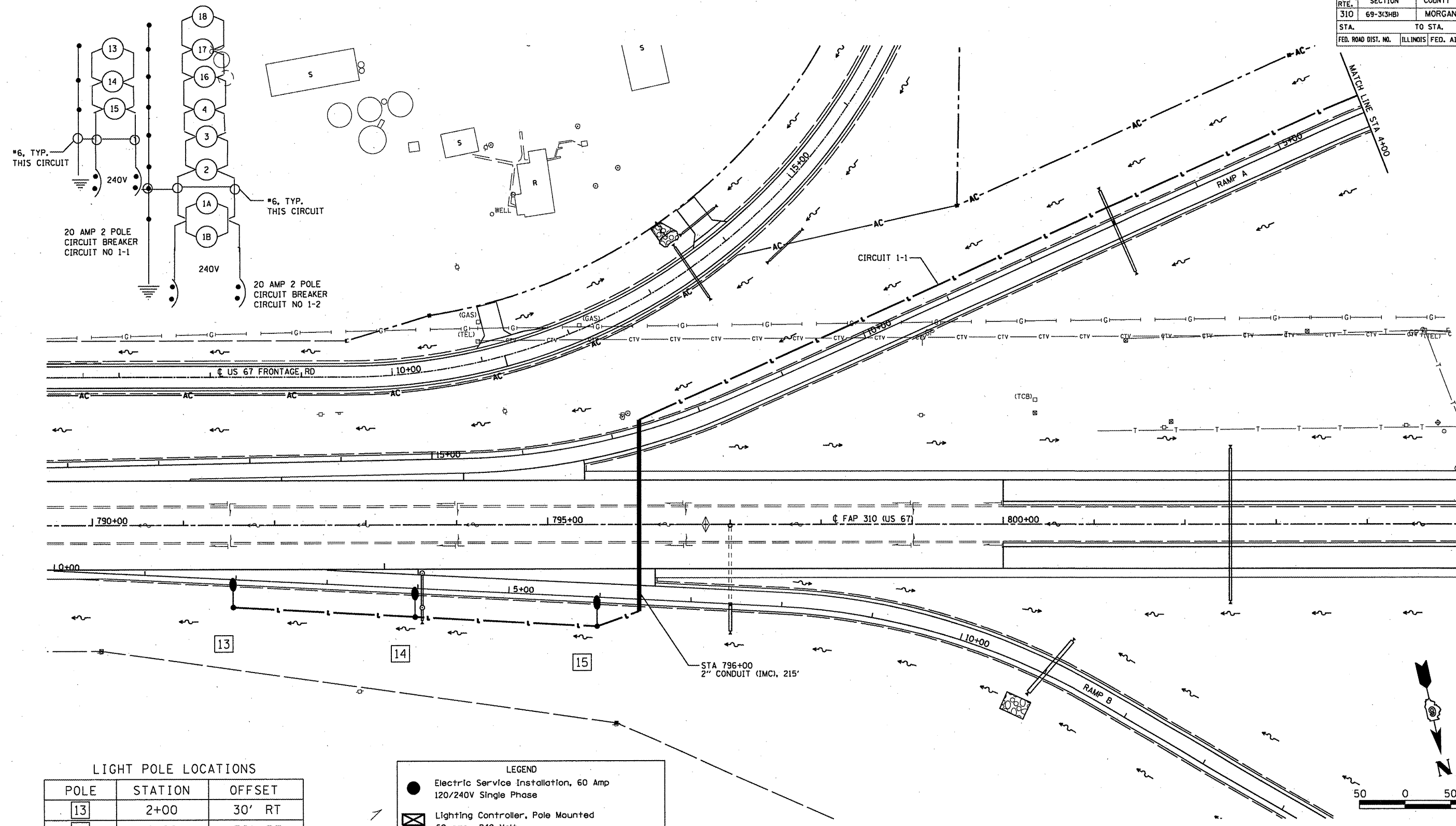

LIGHT POLE LOCATIONS

POLE	STATION	OFFSET
13	2+00	30' RT
14	4+00	30' RT
15	6+00	30' RT

LEGEND

- Electric Service Installation, 60 Amp 120/240V Single Phase
- ⊠ Lighting Controller, Pole Mounted 60 amp., 240 Volt
- Light Pole, Weathering Steel, 45 Ft. M.H., Tenon Mount With 250W HPS Multi-Mount Luminaire
- Unit Duct, 600 v. Size as Indicated
- Conduit Length — XX' Type of Material Diameter — X"

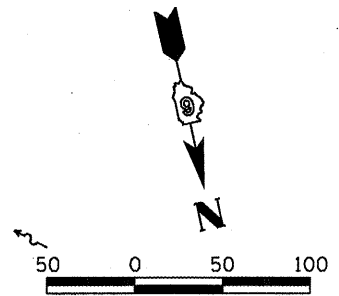

REVISIONS	
NAME	DATE

ILLINOIS DEPARTMENT OF TRANSPORTATION
LIGHTING DETAILS
RAMP B
FAP 310 (US 67)

DATE 9/09
 DRAWN BY BCG
 CHECKED BY

SECTION 69-3(3HB)

MORGAN COUNTY

SHEET 3 OF 8