

9:39:17 AM
 Mar-30-2011 09:39:17 AM

CONTRACT NO. 72667

F.A.P. RTE.	SECTION	COUNTY	TOTAL SHEETS	SHEET NO.
310	69-3(3HB)	MORGAN	793	320
STA.		TO STA.		
FED. ROAD DIST. NO.	ILLINOIS	FED. AID PROJECT		

PROP. CURVE CON-A-1
 PI STA. = 3+69.83
 $\Delta = 9^\circ 13' 14''$ (LT)
 $D = 5^\circ 47' 15''$
 $R = 990.00'$
 $T = 79.83'$
 $L = 159.32'$
 $E = 3.21'$
 $e = 0.076$
 P.C. STA. = 2+90.00
 P.T. STA. = 4+49.32
 S.E. TRANSITION
 STA 1+59.00 TO STA 3+55.00
 STA 3+70.00 TO STA 6+62.00

PROP. CURVE CONA-2
 PI STA. = 13+14.56
 $\Delta = 23^\circ 05' 31''$ (RT)
 $D = 7^\circ 32' 20''$
 $R = 760.00'$
 $T = 155.26'$
 $L = 306.30'$
 $E = 15.70'$
 $e = 0.080$
 P.C. STA. = 11+59.30
 P.T. STA. = 14+65.60
 S.E. TRANSITION
 STA 10+21.00 TO STA 12+29.00

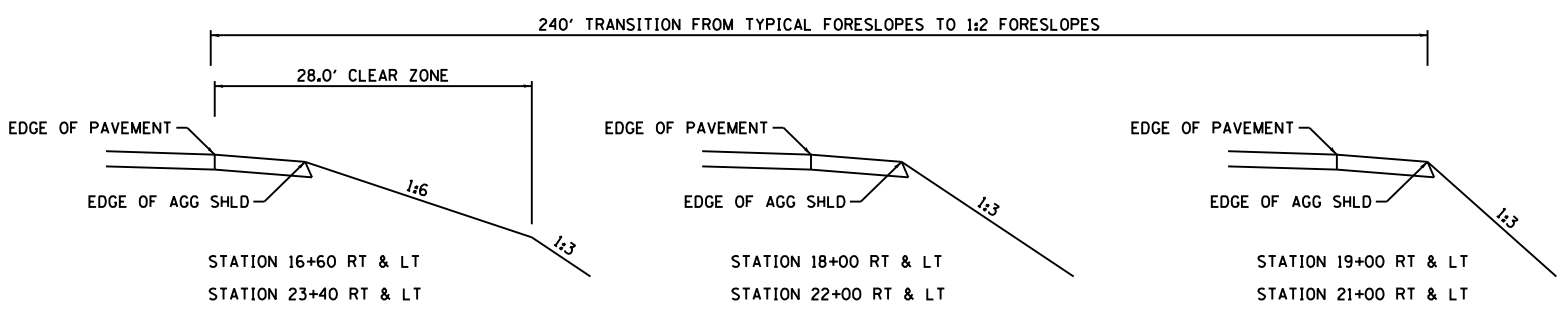
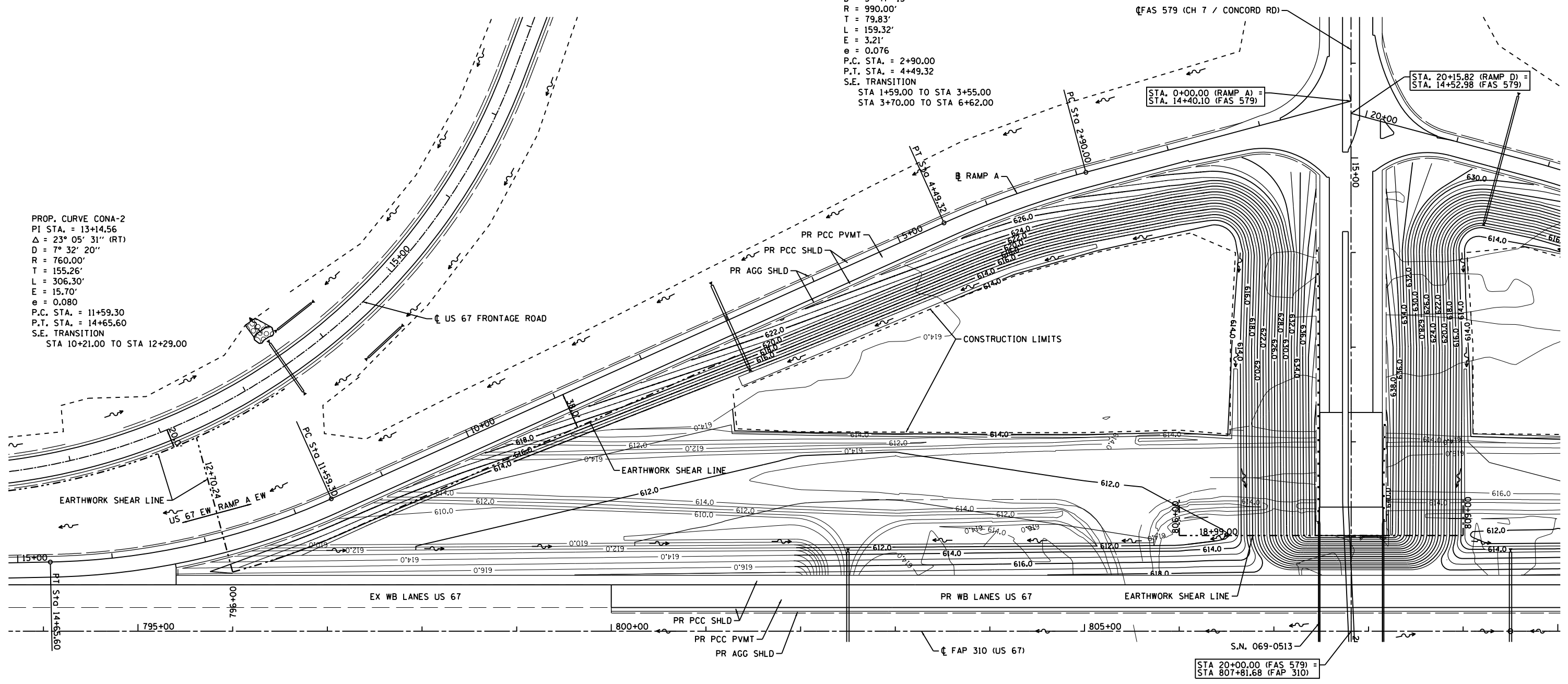

FORESLOPE TRANSITION DETAIL (CONCORD RD)
 NOT TO SCALE
 SEE TYPICAL SECTIONS AND CROSS SECTIONS FOR DETAILS NOT SHOWN

REVISIONS	
NAME	DATE

ILLINOIS DEPARTMENT OF TRANSPORTATION
 INTERCHANGE INFIELD
 GRADING PLAN
 RAMP A
 FAP 310 (US 67) & CONCORD RD
 DATE 3/09
 DRAWN BY SEB
 CHECKED BY

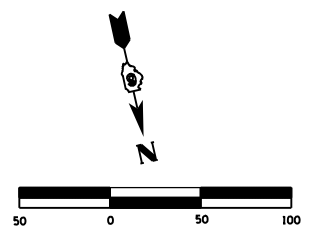

\$FILE\$