

ROUTE NO.	SECTION	COUNTY	TOTAL SHEETS	SHEET NO.
F.A.S. 579	69-3(3HB)	MORGAN	793	329
FED. ROAD DIST. NO.	ILLINOIS	FED. AID PROJECT		

SHEET NO. 6  
OF 20 SHEETS

Contract No. 72667

**CURB LINE (S.B.)**

Location	Station	Offset	Theoretical Grade Elevations
Bk. N. Abut.	21+01.00	-33.00	641.69
A	21+11.00	-33.00	641.63
B	21+21.00	-33.00	641.57
End N. Appr. Pav't	21+31.00	-33.00	641.51

**EDGE OF PVEMENT (S.B.)**

Location	Station	Offset	Theoretical Grade Elevations
Bk. N. Abut.	21+01.00	-23.00	641.89
A	21+11.00	-23.00	641.83
B	21+21.00	-23.00	641.77
End N. Appr. Pav't	21+31.00	-23.00	641.71

**PROFILE GRADE (S.B.)**

Location	Station	Offset	Theoretical Grade Elevations
Bk. N. Abut.	21+01.00	-9.00	642.10
A	21+11.00	-9.00	642.04
B	21+21.00	-9.00	641.98
End N. Appr. Pav't	21+31.00	-9.00	641.92

**CENTERLINE ROADWAY**

Location	Station	Offset	Theoretical Grade Elevations
Bk. N. Abut.	21+01.00	0.00	642.23
A	21+11.00	0.00	642.18
B	21+21.00	0.00	642.12
End N. Appr. Pav't	21+31.00	0.00	642.05

**PROFILE GRADE (N.B.)**

Location	Station	Offset	Theoretical Grade Elevations
Bk. N. Abut.	21+01.00	9.00	642.10
A	21+11.00	9.00	642.04
B	21+21.00	9.00	641.98
End N. Appr. Pav't	21+31.00	9.00	641.92

**EDGE OF PAVEMENT (N.B.)**

Location	Station	Offset	Theoretical Grade Elevations
Bk. N. Abut.	21+01.00	23.00	641.89
A	21+11.00	23.00	641.83
B	21+21.00	23.00	641.77
End N. Appr. Pav't	21+31.00	23.00	641.71

**CURB LINE (N.B.)**

Location	Station	Offset	Theoretical Grade Elevations
Bk. N. Abut.	21+01.00	33.00	641.69
A	21+11.00	33.00	641.63
B	21+21.00	33.00	641.57
End N. Appr. Pav't	21+31.00	33.00	641.51

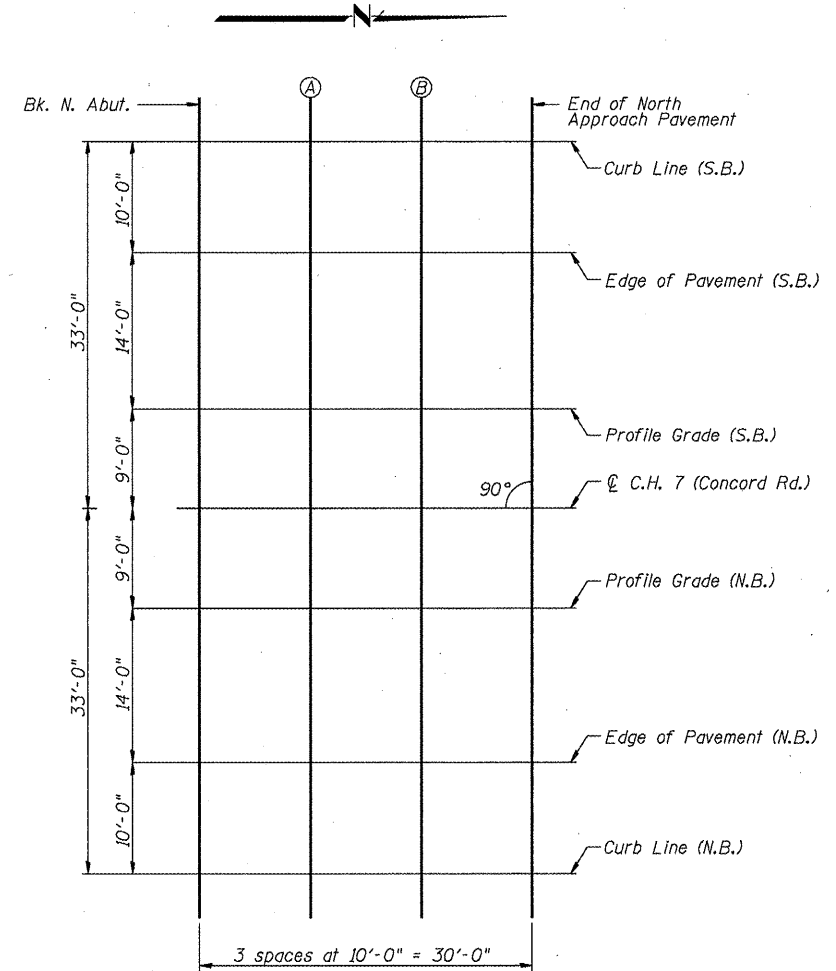

**PLAN**

Note: Offsets are from C.H. 7 (Concord Rd.)

**TOP OF NORTH APPROACH  
SLAB ELEVATIONS  
C.H. 7 (CONCORD RD.) (F.A.S. 579)  
OVER U.S. 67/IL 104 (F.A.P. 310)  
MORGAN COUNTY  
STA. 807+81.68 - SECTION 69-3(3HB)  
S.N. 069-0513**