

9:40:41 AM

Mar-30-2011 09:40:41AM

\$FILE\$

CONTRACT NO. 72667

F.A.P. RTE.	SECTION	COUNTY	TOTAL SHEETS	SHEET NO.
310	69-3(3HB)	MORGAN	793	354
STA.		TO STA.		
FED. ROAD DIST. NO.	ILLINOIS	FED. AID PROJECT		

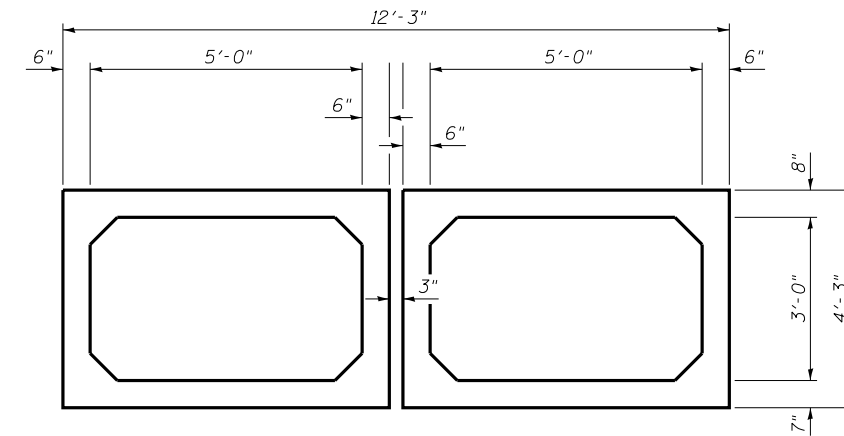
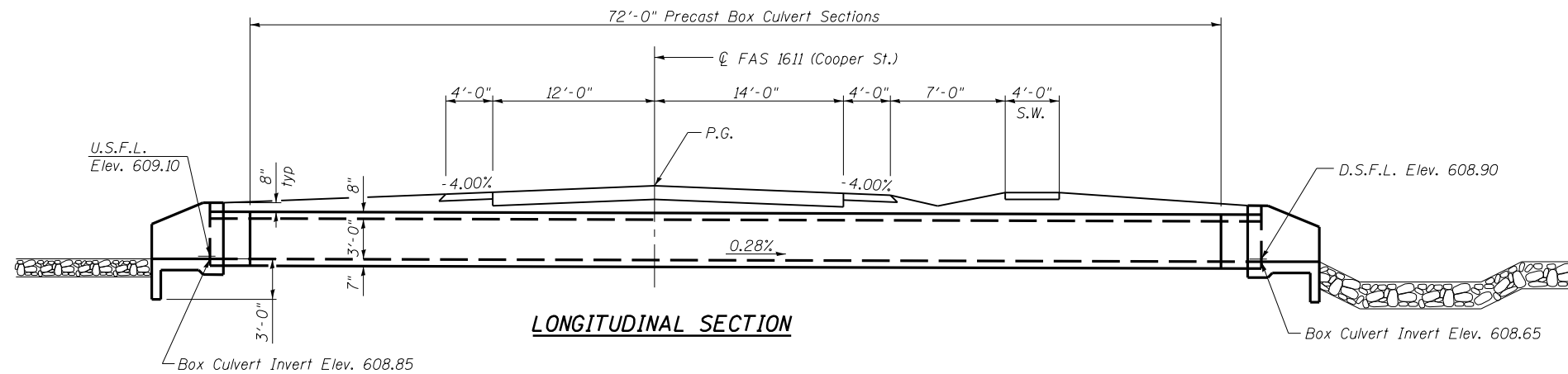

SECTION THRU BARREL

LOADING HS20-44

Allow 50#/sq. ft. for future wearing surface.

DESIGN SPECIFICATIONS

2002 AASHTO Standard Specifications

DESIGN STRESSES

FIELD UNITS

$f'_c = 3,500$ psi
 $f_y = 60,000$ psi (Reinforcement)

PRECAST UNITS

$f'_c = 5,000$ psi
 $f_y = 65,000$ psi (Welded Wire Fabric)

Note:
 The precast concrete box culverts shall conform to the requirements of AASHTO M 273.

TOTAL BILL OF MATERIAL

ITEM	UNIT	TOTAL
Concrete Box Culverts	Cu. Yd.	16.4
Granular Culvert Backfill	Cu. Yd.	110
Precast Concrete Box Culvert 5'x3' (M273)	Foot	72.0
Reinforcement Bars	Pound	1,930

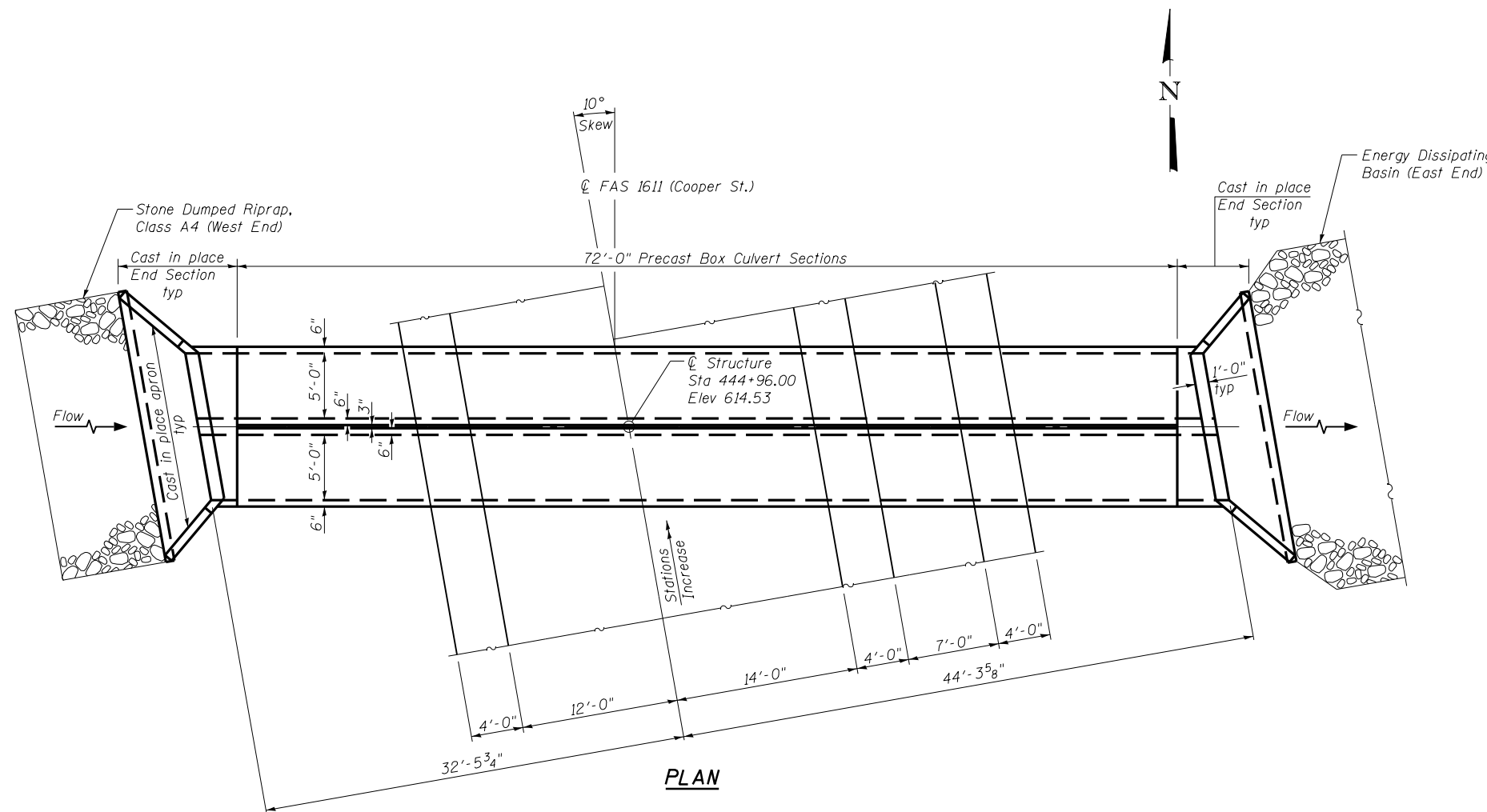

PLAN

REVISIONS	
NAME	DATE

ILLINOIS DEPARTMENT OF TRANSPORTATION
 GENERAL PLAN & ELEVATION
 STATION 444+96.00
 FAS 1611 (COOPER STREET)

DRAWN BY
 CHECKED BY
 DATE