

PROP. CURVE MLE17
 PI STA. = 979+37.53
 $\Delta = 8^\circ 10' 00''$ (RT)
 $D = 0^\circ 26' 12''$
 $R = 13,123.33'$
 $T = 936.85'$
 $L = 1,870.54'$
 $E = 33.40'$
 $e = 0.015$
 P.C. STA. = 970+00.67
 P.T. STA. = 988+71.21
 S.E. TRANSITION

STA 968+87.00 TO STA 970+23.00
 STA 988+49.00 TO STA 989+85.00

PROP. CURVE TRANSA
 PI STA. = 5+25.42
 $\Delta = 8^\circ 02' 26''$ (RT)
 $D = 3^\circ 07' 21''$
 $R = 1,835.00'$
 $T = 128.97'$
 $L = 257.51'$
 $E = 4.53'$
 $e = NC$
 P.C. STA. = 3+96.46
 P.T. STA. = 6+53.97

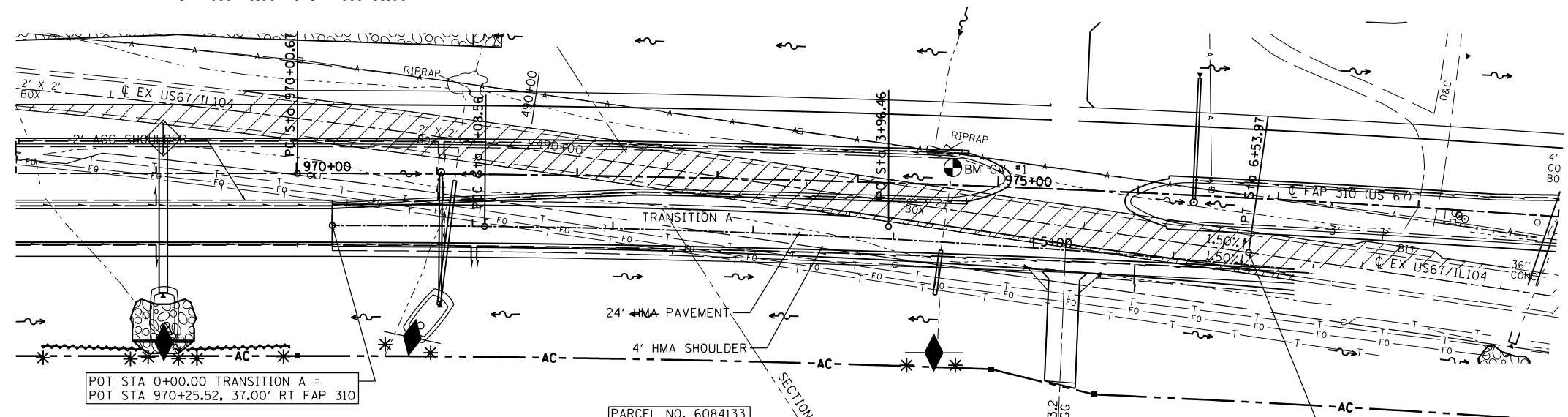

POT STA 0+00.00 TRANSITION A =
 POT STA 970+25.52, 37.00' RT FAP 310

PARCEL NO. 6084133
 CHARLES F. MOWRY
 MARY R. MOWRY
 (CHARLES F. MOWRY REVOCABLE TRUST)
 TOTAL AREA: 216.57 ACRES
 TAKING AREA (TRACT A): 9.89 ACRES
 TAKING AREA (TRACT B): 4.22 ACRES
 REMAINDER AREA: 202.46 ACRES

PT STA 6+53.97 TRANSITION A =
 POT STA 976+80.85, 38.73' RT FAP 310 =
 POT STA 484+81.31 EX US 67/IL104

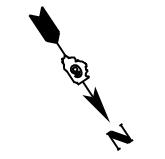

SCALE: 1" = 50'

FILE NAME = c:\pw\work\p\dot\sparksg\1d0264875\EC	USER NAME = Sparksgw TransitionA.dgn	DESIGNED - DRAWN -	REVISED - REVISED -	STATE OF ILLINOIS DEPARTMENT OF TRANSPORTATION	STORM WATER POLLUTION PREVENTION PLAN				F.A.P. RTE. 310	SECTION 69-3	COUNTY MORGAN	TOTAL SHEETS 793	SHEET NO. 403
	PLOT SCALE = 100.0000' / in.	CHECKED -	REVISED -		SCALE:	SHEET NO.	OF SHEETS	STA.	TO STA.	CONTRACT NO. 72667			
	PLOT DATE = Mar-30-2011 09:44:30AM	DATE -	REVISED -		FED. ROAD DIST. NO. ILLINOIS FED. AID PROJECT								
TRANSITION A													