

F.A.P. RTE.	SECTION	COUNTY	TOTAL SHEETS	SHEET NO.
310	69-3	MORGAN	793	478
STA.		TO STA.		
FED. ROAD DIST. NO.	ILLINOIS	FED. AID PROJECT		

DATE	BY

DATE	BY

9:50:03 AM
 Mar-30-2011 09:50:03 AM
 \$FILE\$

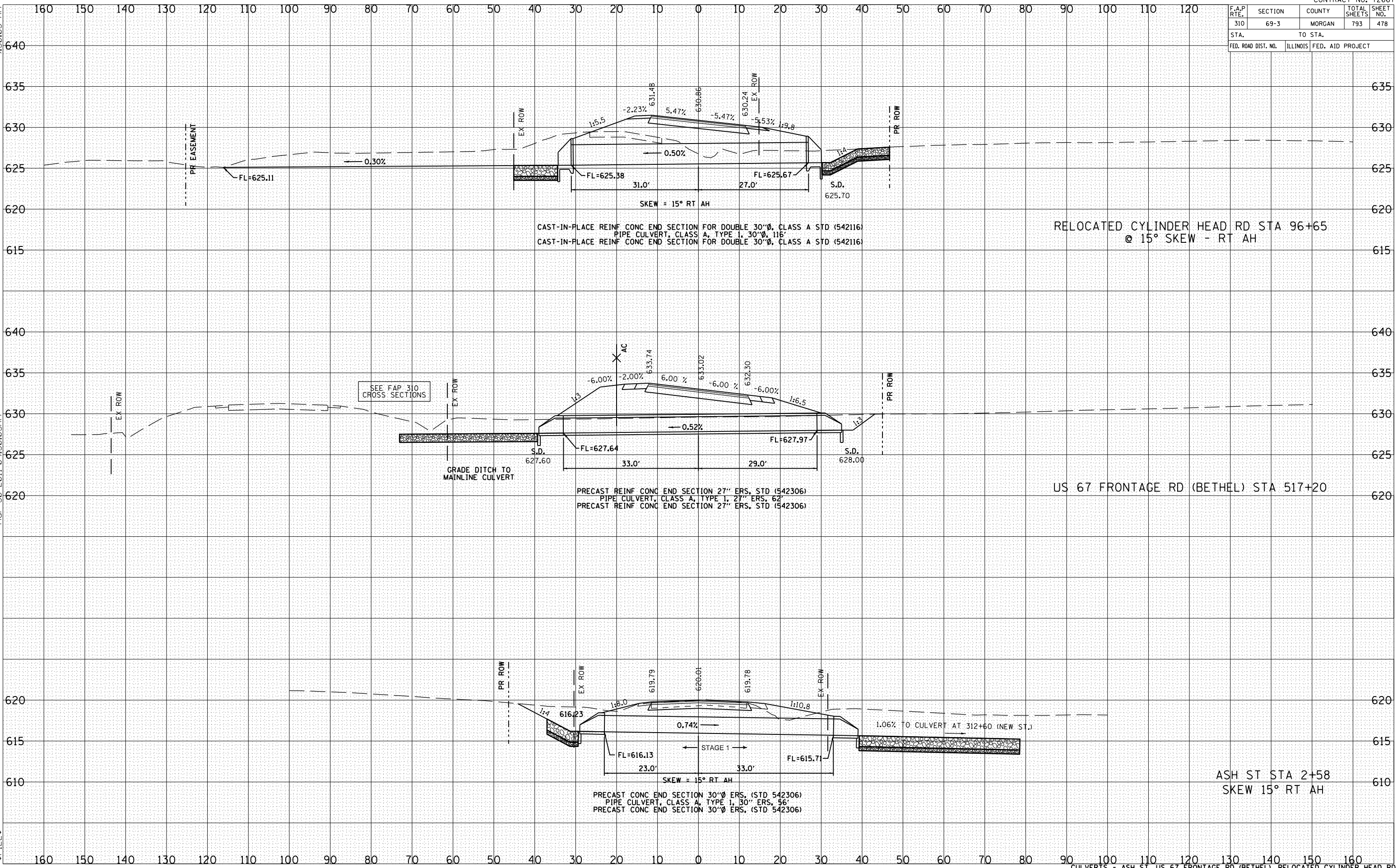

CAST-IN-PLACE REINF CONC END SECTION FOR DOUBLE 30"Ø, CLASS A STD (542116)
 PIPE CULVERT, CLASS A, TYPE 1, 30"Ø, 116'
 CAST-IN-PLACE REINF CONC END SECTION FOR DOUBLE 30"Ø, CLASS A STD (542116)

RELOCATED CYLINDER HEAD RD STA 96+65
 @ 15° SKEW - RT AH

PRECAST REINF CONC END SECTION 27" ERS, STD (542306)
 PIPE CULVERT, CLASS A, TYPE 1, 27" ERS, 62'
 PRECAST REINF CONC END SECTION 27" ERS, STD (542306)

US 67 FRONTAGE RD (BETHEL) STA 517+20

PRECAST CONC END SECTION 30"Ø ERS, (STD 542306)
 PIPE CULVERT, CLASS A, TYPE 1, 30" ERS, 56'
 PRECAST CONC END SECTION 30"Ø ERS, (STD 542306)

ASH ST STA 2+58
 SKEW 15° RT AH