

F.A.P. RTE.	SECTION	COUNTY	TOTAL SHEETS	SHEET NO.
310	69-3	MORGAN	793	511
STA. TO STA.				
FED. ROAD DIST. NO.	ILLINOIS	FED. AID PROJECT		

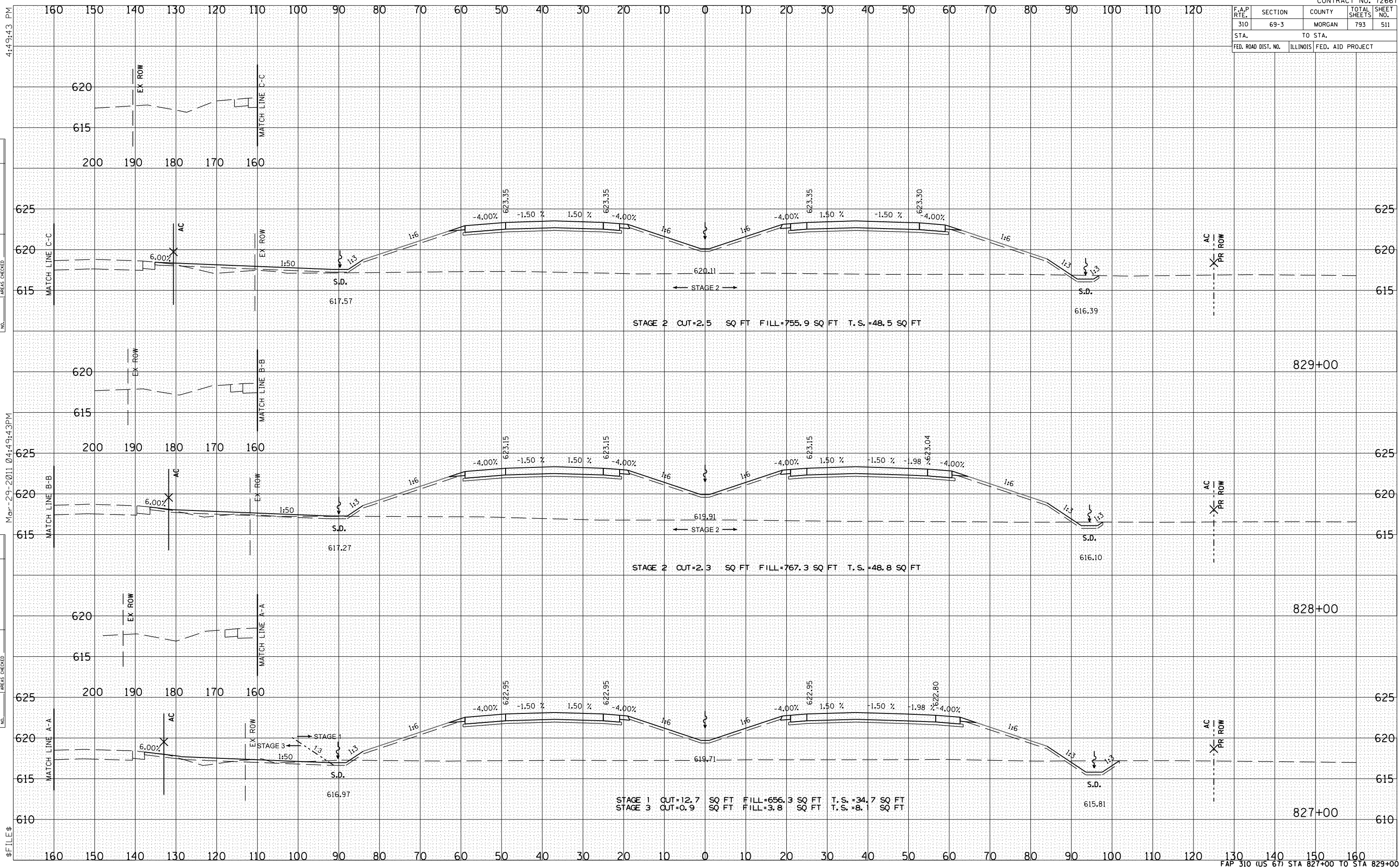

4:49:43 PM

Mar-29-2011 04:49:43PM

BY	DATE

SURVEYED
 PLOTTED
 NOTE BOOK
 AREAS CHECKED

BY	DATE

SURVEYED
 PLOTTED
 NOTE BOOK
 AREAS CHECKED

\$ FILE \$