

**TYPICAL # 2**

STA. 1695+06.00 TO 1730+00.00  
 STA. 1757+00.00 TO 1782+88.00

**LEGEND**

- (A) EXIST. PCC PAVEMENT 7"
- (B) EXIST. PCC BASE COURSE 8"
- (C) EXIST. PCC BASE COURSE WIDENING 8"
- (D) EXIST. AGG. BASE COURSE
- (E) EXIST. HMA OVERLAY, VARIES 6-8"
- (F) EXIST. HMA SHOULDER, VARIES 6-8"
- (G) EXIST. AGGREGATE SHOULDER
- (H) EXIST. HMA SURFACE 1.5"
- (I) EXIST. OIL & CHIP SURFACING
  
- (1) PROP. HMA SURFACE REMOVAL, 1.5"
- (2) PROP. HMA SURFACE COURSE, MIX "D" N70, 1.5"
- (3) PROP. AGGREGATE SHOULDERS, TY B
- (4) PROP. PAVEMENT MARKING, 5"
- (5) PROP. AGGREGATE BASE COURSE, TY. B, 6"
- (6) PROP. HMA BASE COURSE, 6"
- (7) PROP. INCIDENTAL HMA SURFACING, 2"

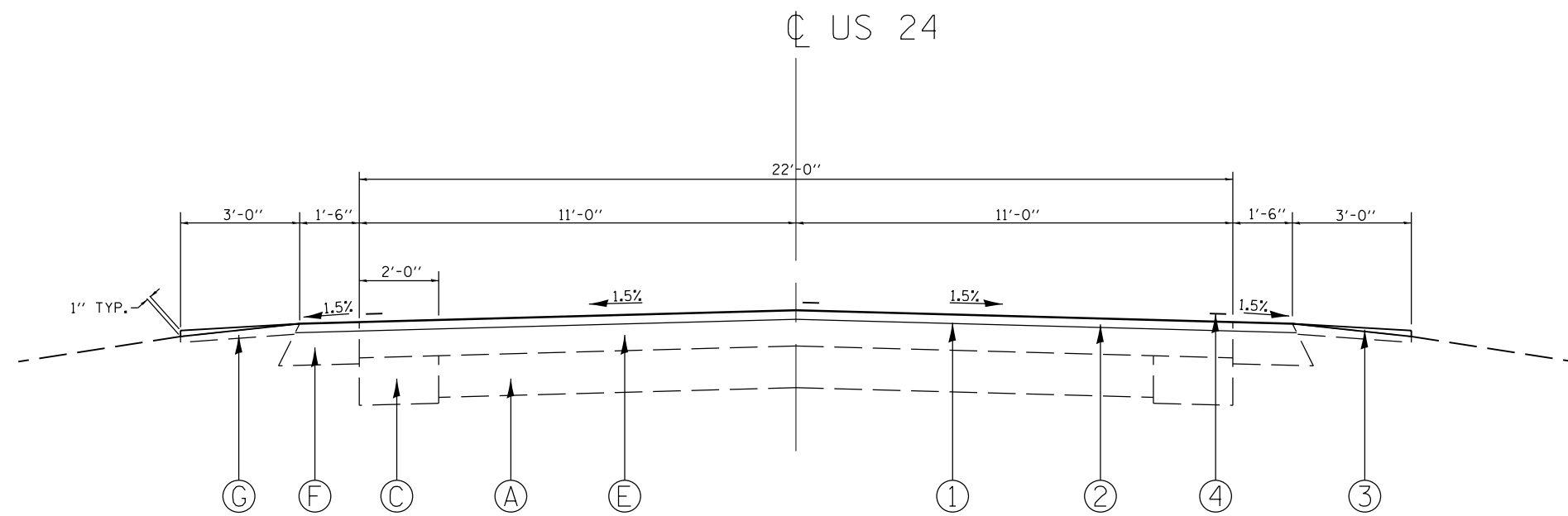

**TYPICAL # 1**

STA. 1150+45.00 TO 1255+52.00  
 STA. 1498+42.62 TO 1695+06.00  
 STA. 1782+88.00 TO 1785+57.50  
 STA. EQ. 1785+57.50 BK = 1835+29.70 AH  
 STA. 1835+29.70 TO 1846+31.50  
 STA. EQ. 1846+31.50 BK = 1846+31.80 AH  
 STA. 1846+31.80 TO 1855+14.87  
 STA. EQ. 1855+14.87 BK = 1855+21.00 AH  
 STA. 1855+21.00 TO 1872+35.50

FILE NAME = c:\pwork\work\pwork\sparksgw\0217396\0672962-sht-typical.dgn	USER NAME = sparksgw	DESIGNED -	REVISED -	<b>STATE OF ILLINOIS DEPARTMENT OF TRANSPORTATION</b>	<b>TYPICAL SECTION F.A.P. 317 (US 24)</b>			F.A.P. RTE.	SECTION	COUNTY	TOTAL SHEETS	SHEET NO.
	PLOT SCALE = 40.0000' / in.	CHECKED -	REVISED -					317	.	ADAMS	36	4
PLOT DATE = Mar-11-2011 10:11:55AM	DATE -	REVISED -	REVISED -		SCALE:	SHEET NO.	OF SHEETS	STA.	TO STA.	ILLINOIS FED. AID PROJECT		
CONTRACT NO. 72962												