

STATE OF ILLINOIS
 DEPARTMENT OF TRANSPORTATION
 DIVISION OF HIGHWAYS

**PROPOSED
 CONTRACT MAINTENANCE**

FAI 55 (I 55)
 SECTION (54) INT PATCHING 2011

LOGAN COUNTY

| F.A.I. RTE. | SECTION | COUNTY | TOTAL SHEETS | SHEET NO. |
|---------------------|------------------------|--------------------|--------------|-----------|
| 55 | (54) INT PATCHING 2011 | LOGAN | 6 | 1 |
| FED. ROAD DIST. NO. | ILLINOIS | CONTRACT NO. 72E40 | | |

FOR INDEX OF SHEETS, SEE SHEET NO. 2

A.D.T. = 3,450 (375)

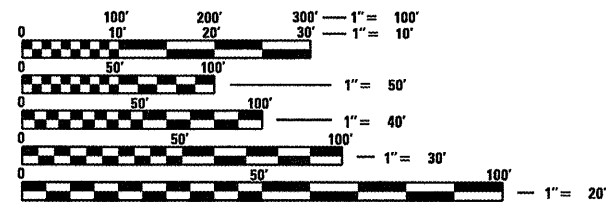

FULL SIZE PLANS HAVE BEEN PREPARED USING STANDARD ENGINEERING SCALES. REDUCED SIZED PLANS WILL NOT CONFORM TO STANDARD SCALES. IN MAKING MEASUREMENTS ON REDUCED PLANS, THE ABOVE SCALES MAY BE USED.

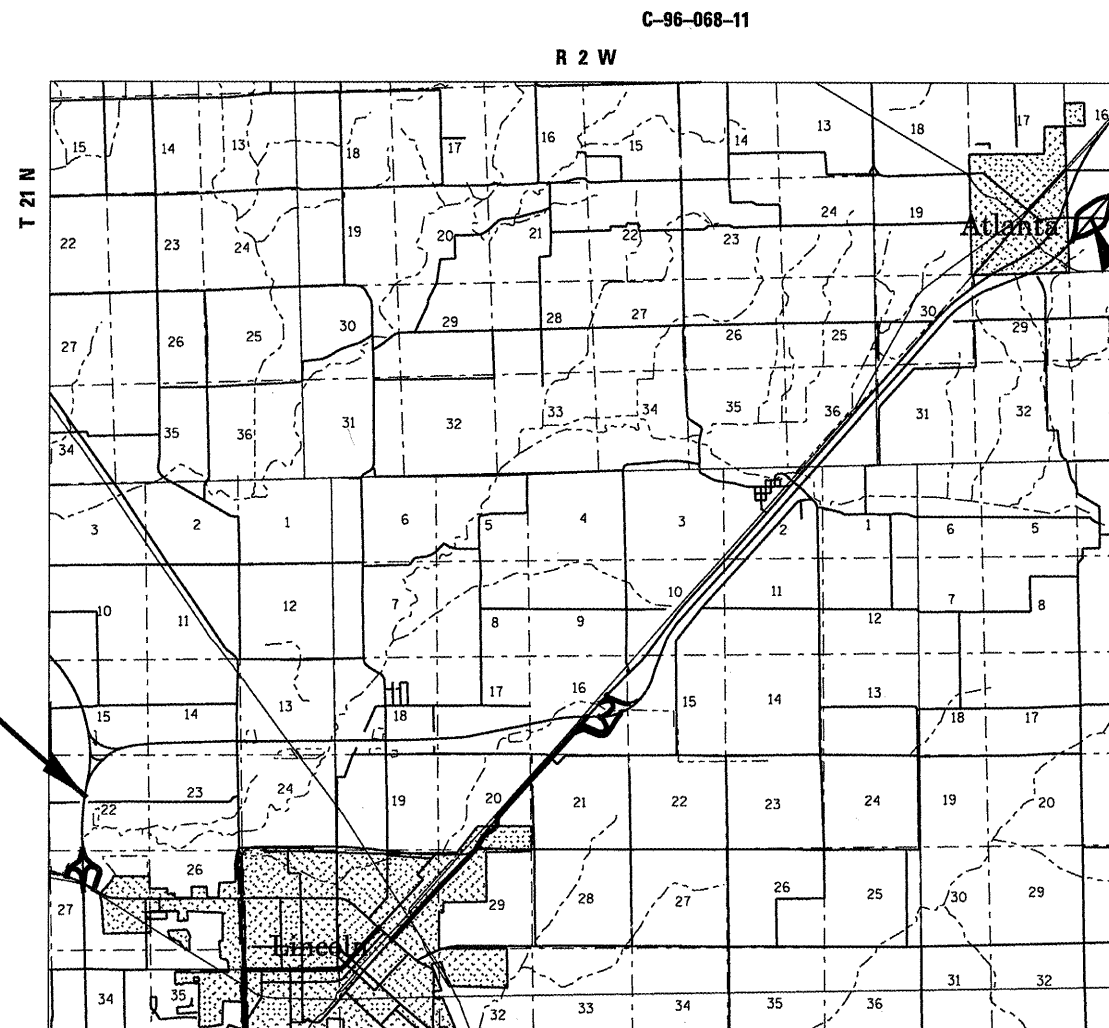

BEGIN PROJECT
 STA. 203 + 270.00

END PROJECT
 STA. 227 + 000.00

GROSS LENGTH = 82,348.00 FT. = 15.600 MILES

J.U.L.I.E.
 JOINT UTILITY LOCATION INFORMATION FOR EXCAVATION
 1-800-892-0123
 OR 811

PLAN AND CONTRACT TECHNICIAN
 TIMOTHY SHARP (217)782-7743

CONTRACT NO. 72E40

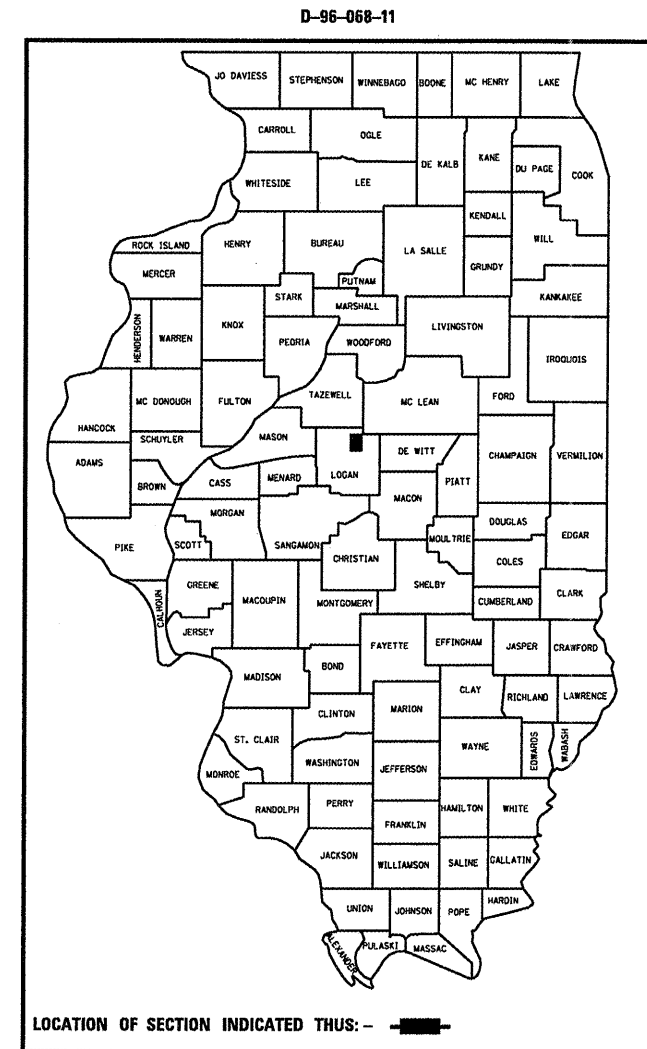

LOCATION OF SECTION INDICATED THUS: —■—

STATE OF ILLINOIS
 DEPARTMENT OF TRANSPORTATION
 DIVISION OF HIGHWAYS

SUBMITTED April 8 20 11

Regina Z. Dinsley
 DEPUTY DIRECTOR OF HIGHWAYS, REGION ENGINEER

May 13 20 11

Scott E. Stitt P.E. IRL
 acting ENGINEER OF DESIGN AND ENVIRONMENT

May 13 20 11

Christine M. Reed IRL
 DIRECTOR OF HIGHWAYS, CHIEF ENGINEER

PRINTED BY THE AUTHORITY
 OF THE STATE OF ILLINOIS